

25  
YEARS

SERVING  
BEACONSFIELD  
SINCE 1998

22 Stretton Close, Penn

Guide Price £350,000

Ashington Page



Lovely ground floor two bedroom apartment situated in a quiet gated development moments from the village of Penn with it's countryside walks. It is a short drive to the more comprehensive shopping and transport facilities available in High Wycombe and Beaconsfield. This property has access to idyllic communal gardens and benefits from 2 allocated and residents parking.

Leasehold. Share of Freehold along with other Leaseholders.

Service Charge: £2,325 pa

Length of Lease: 155 years from 01/01/2005

Ground Rent: £275 pa

EPC: C

Council Tax: Wycombe D

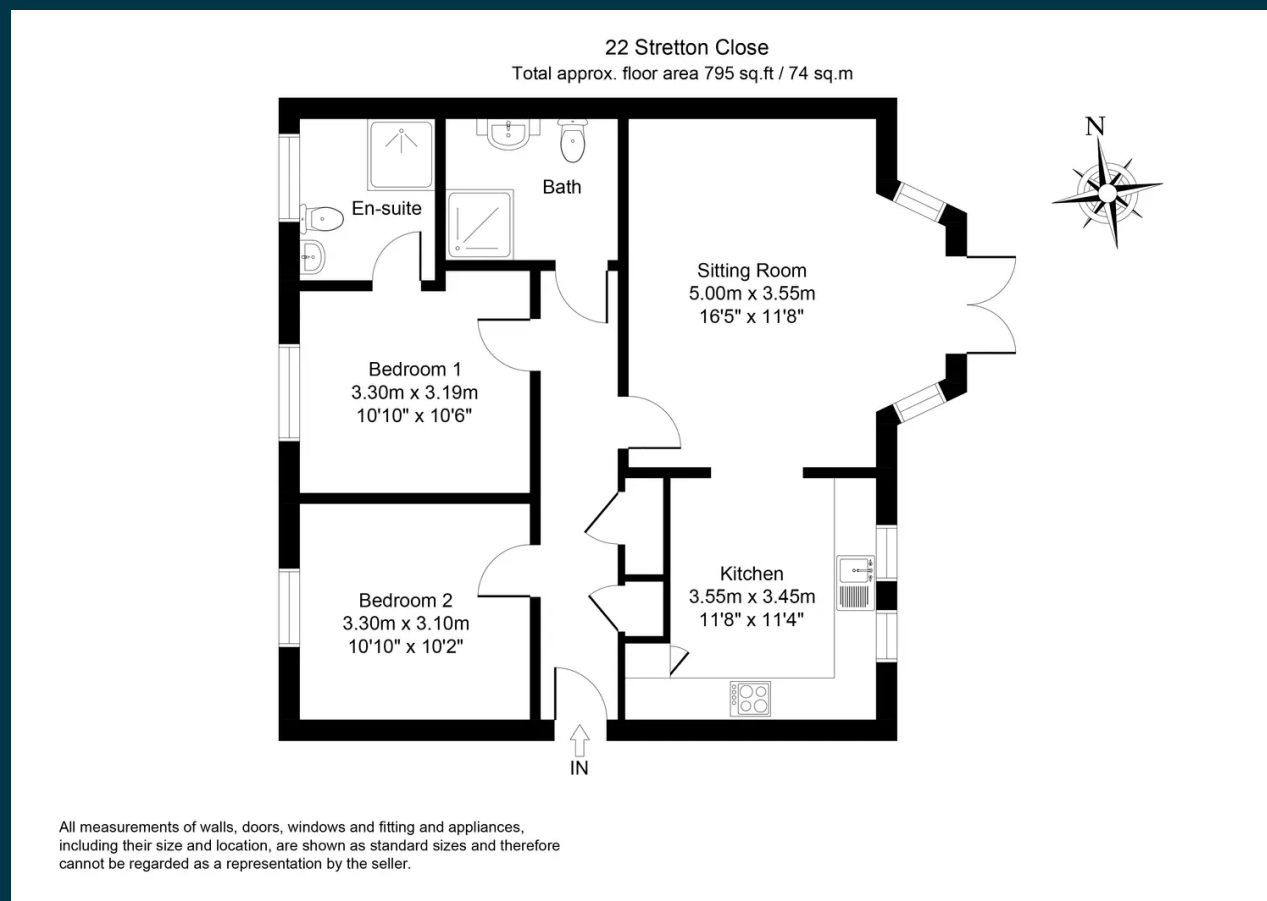

These particulars are for guidance only. They are prepared and issued in good faith and are intended to give a fair summary of the property. Any description should not be relied on as a statement or representation of fact or that the property, or its services, are in good condition. The photographs show only certain parts of the property at the time they were taken. Any areas, measurements or distance given are approximate only. Any reference to alterations to, or use of, any part of the property is not a statement that any necessary planning, building regulations or other consent has been obtained. These matters must be verified by an intending purchaser. All statements contained in these particulars in relation to the property are made without responsibility of Ashington Page or its clients. Neither Ashington Page (nor any joint agents) nor any of their employees has any authority to make or give any representation or warranty whatsoever in relation to the property



01494 680018  
info@ashingtonpage.co.uk  
www.AshingtonPage.co.uk

