



 Knight
Edmonds

1 Westborough Mews, Maidstone

Guide Price £220,000 – £230,000



Welcome to this exquisite two-bedroom top floor apartment that combines contemporary living with convenience. Nestled in a prime location, this property offers a delightful living experience for individuals and small families.

This apartment boasts two generously sized double bedrooms, providing ample space for relaxation and personalization. The main bedroom enjoys the added luxury of an en-suite shower room, offering privacy and convenience.

In addition to the en-suite, there is a separate family bathroom featuring modern fixtures and finishes. It's perfect for accommodating guests or family members.

The kitchen is a true delight for aspiring chefs and home cooks alike. It comes fully equipped with modern appliances and plenty of counter space, making meal preparation a breeze.

The open-plan living area seamlessly connects the kitchen and living room, creating a versatile and welcoming space for entertaining, dining, or simply unwinding after a long day.

You'll find convenient storage cupboards in the hallway, providing an organized solution for keeping your belongings neatly tucked away.

The presence of allocated parking is a significant advantage, ensuring that you never have to worry about finding a parking spot.

This top-floor apartment offers not only a comfortable living space but also the convenience of being close to essential amenities, schools, parks, and transport links. Its modern design and thoughtful layout make it a perfect choice for those seeking a hassle-free lifestyle in a sought-after location.

For travel Maidstone West Train Station is just a mile away for fast links into London, plus there is the choice of Maidstone East and Barracks in the town centre as well. The M20 is just a short drive away for quick links by road into the capital or to the coast. Close by is a Tesco express and a variety of takeaways. For schools there is West Borough Primary School and Nursery, and MidKent College. For more information and to book a viewing call the team at Knight Edmonds today.

Don't miss the opportunity to make this apartment your new home. Contact us today to schedule a viewing and experience the charm of this two-bedroom gem for yourself.



TOP FLOOR
638 sq.ft. (59.2 sq.m.) approx.

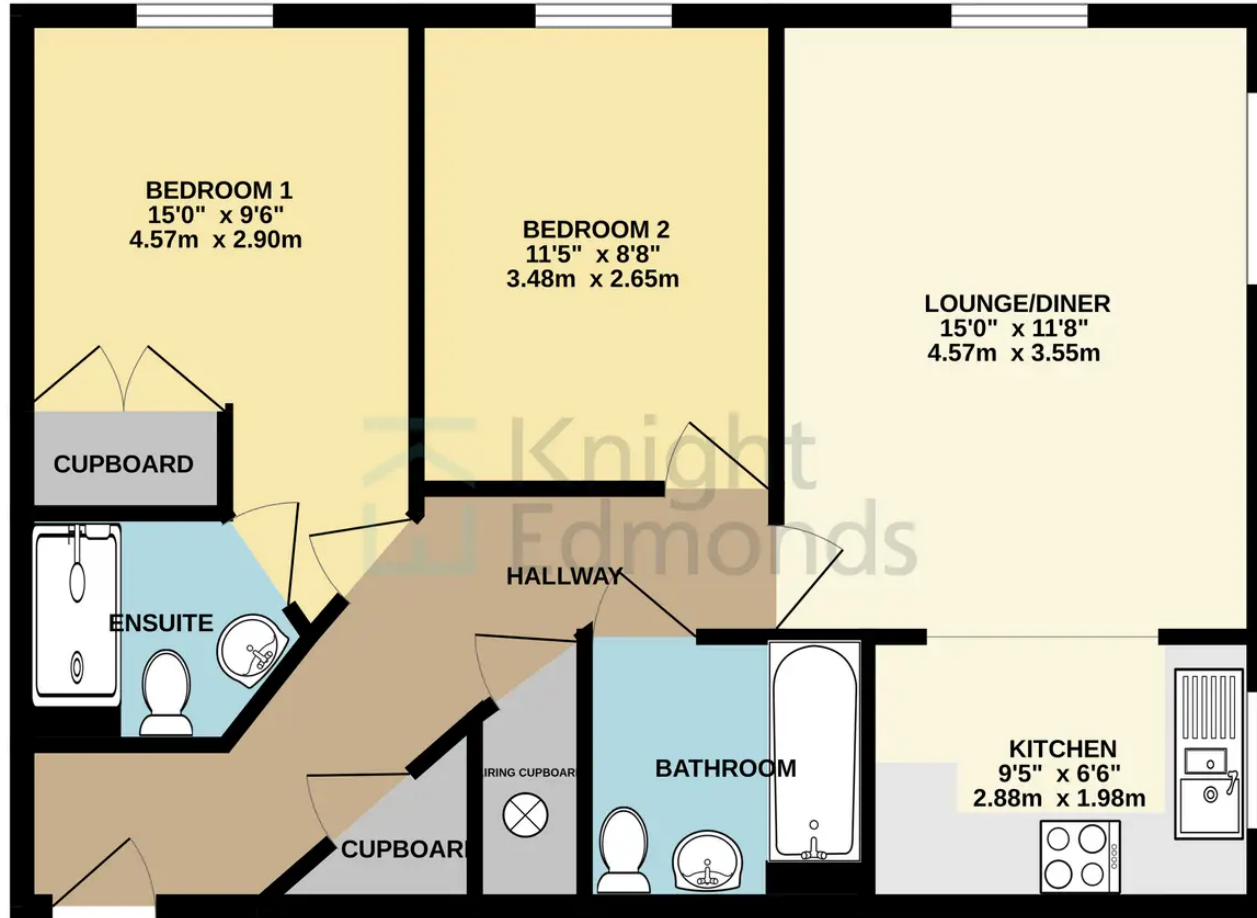

Scan to
view
online!



Scan to
book a
viewing!



TOTAL FLOOR AREA : 638 sq.ft. (59.2 sq.m.) approx.

Whilst every attempt has been made to ensure the accuracy of the floorplan contained here, measurements of doors, windows, rooms and any other items are approximate and no responsibility is taken for any error, omission or mis-statement. This plan is for illustrative purposes only and should be used as such by any prospective purchaser. The services, systems and appliances shown have not been tested and no guarantee as to their operability or efficiency can be given.

Made with Metropix ©2023

