



LAWRENCE RAND

Woodrow Close, Perivale

£2,500 pcm



Woodrow Close

Perivale, Greenford

This well presented THREE bedroom semi-detached house TO RENT in PERIVALE, tucked away in a quiet cul de sac. Available NOW
Council Tax band: D

Tenure: Freehold

- THREE BEDROOMS
- SEMI DETACHED HOUSE
- NEWLY FITTED MODERN KITCHEN
- TWO RECEPTION ROOMS
- REPAINTED THROUGHOUT
- MODERN BATHROOM
- PRIVATE REAR GARDEN
- OFF STREET PARKING
- CLOSE TO PERIVALE STATION





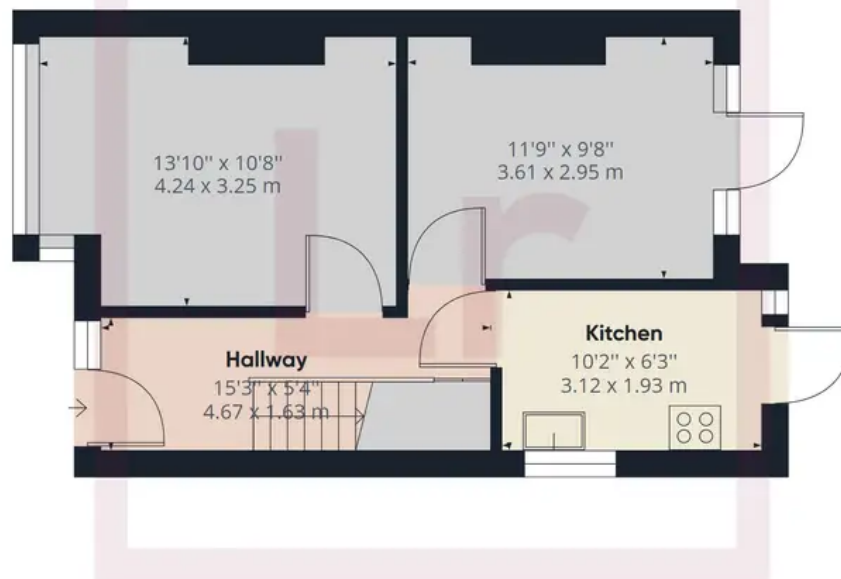

Ground Floor

Approximate total area⁽¹⁾

813.08 ft²

75.54 m²

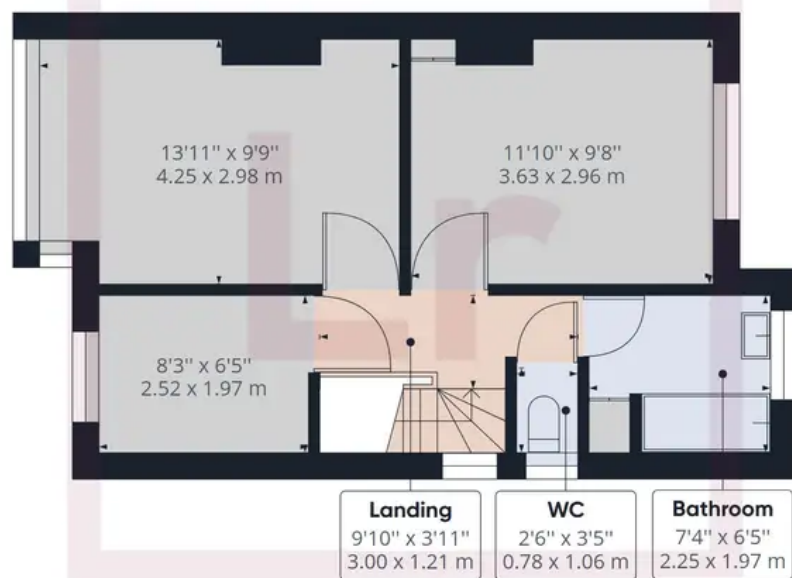

Floor 1

(1) Excluding balconies and terraces

While every attempt has been made to ensure accuracy, all measurements are approximate, not to scale. This floor plan is for illustrative purposes only.

GIRAFFE360



Lawrence Rand

Lawrence Rand, 106 Victoria Road - HA4 0AL

01895 632211

Info@lawrence-rand.co.uk

www.lawrence-rand.co.uk/



LAWRENCE RAND