



15 Lunedale Road, Dibden Purlieu  
£549,950



ANTHONY JAMES  
PROPERTIES



# 15 Lunedale Road

Dibden Purlieu, Southampton

Presented for sale is this wonderful example of a bungalow set on a highly requested road in the village of Dibden Purlieu. The property (which is sat on just over a fifth of an acre) benefits from three double bedrooms (ensuite to main), bathroom, refitted kitchen/breakfast room, lounge, dining room and conservatory. The bungalow also benefits from ample parking to front over a block paved driveway, detached garage with pitched roof to side, spacious rear garden with a wonderful array of well established plants and trees. Viewing for this property is absolutely essential.

Tenure: Freehold



Score	Energy rating	Current	Potential
92+	A		
81-91	B		
69-80	C		76 C
55-68	D	61 D	
39-54	E		
21-38	F		
1-20	G		



1 Southward House  
Dibden Purlieu SO45 4PT



T: 02380 844405

info@anthonyjamesproperties.co.uk



GROUND FLOOR  
1124 sq.ft. (104.5 sq.m.) approx.

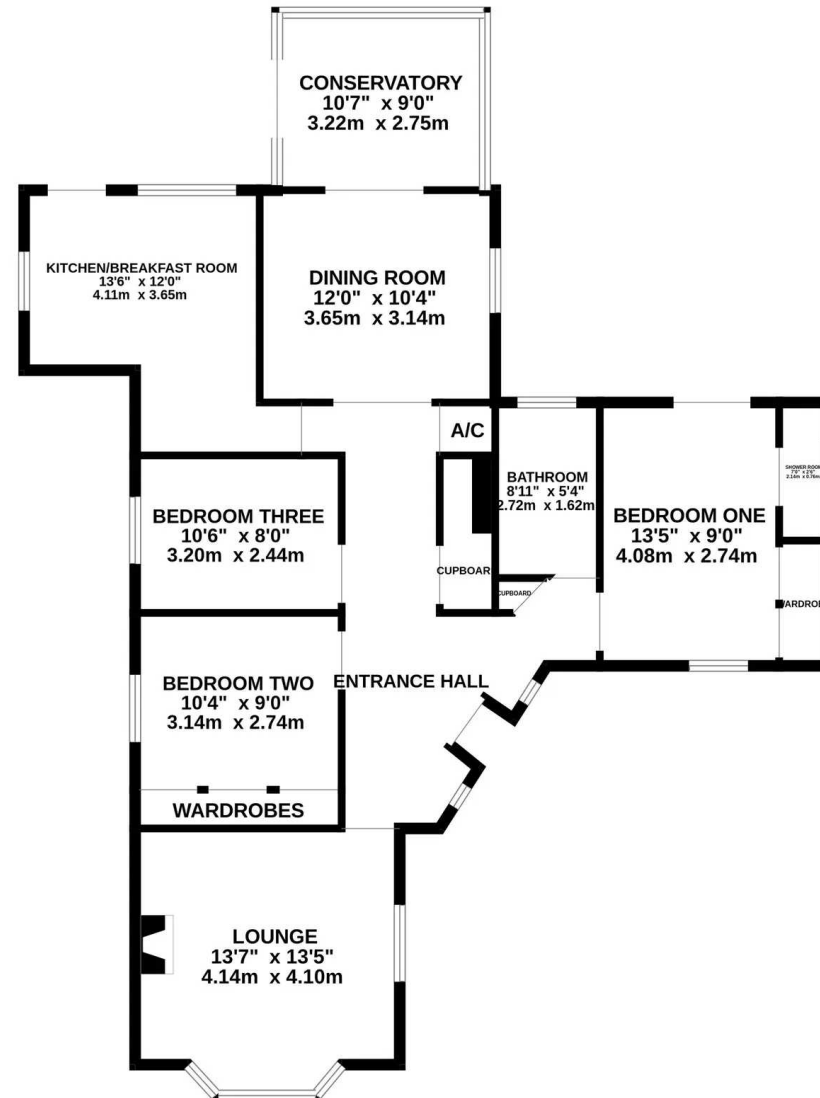

TOTAL FLOOR AREA : 1124 sq.ft. (104.5 sq.m.) approx.

Whilst every attempt has been made to ensure the accuracy of the floorplan contained here, measurements of doors, windows, rooms and any other items are approximate and no responsibility is taken for any error, omission or mis-statement. This plan is for illustrative purposes only and should be used as such by any prospective purchaser. The services, systems and appliances shown have not been tested and no guarantee as to their operability or efficiency can be given.

Made with Metropix ©2023