



7 Coppice Gate Beaulieu Road, Dibden Purlieu
£325,000



7 Coppice Gate Beaulieu Road

Dibden Purlieu, Southampton

GROUND FLOOR APARTMENT offered for sale in immaculate condition within McCarthy Stone's PLATINUM RANGE development. Internally there are two double bedrooms, an ensuite, a lounge/dining room, a well appointed kitchen and a stylish shower room. In addition to this the development benefits from a spacious communal lounge with kitchen facilities, guest accommodation (nominal charge), laundry, refuse and mobility storage areas and generous wrap around gardens within the outside space. In addition to this, there is parking available on a first come first served basis, and this property is being sold with NO ONWARD CHAIN, making an internal viewing essential.

Coppice Gate is positioned within walking distance of The New Forest National Park and the local village amenities. This includes a selection of local shops, a pharmacy, a health centre and a dentists. A local bus service provides access to neighbouring towns throughout The Waterside, including Hythe Village where a passenger ferry service operates regularly to Southampton. A Golf Course and driving range can be found in nearby Dibden and Applemore recreation centre has a gym and a public swimming pool.

Tenure: Leasehold



1 Southward House
Dibden Purlieu SO45 4PT



T: 02380 844405

info@anthonyjamesproperties.co.uk



GROUND FLOOR
851 sq.ft. (79.1 sq.m.) approx.

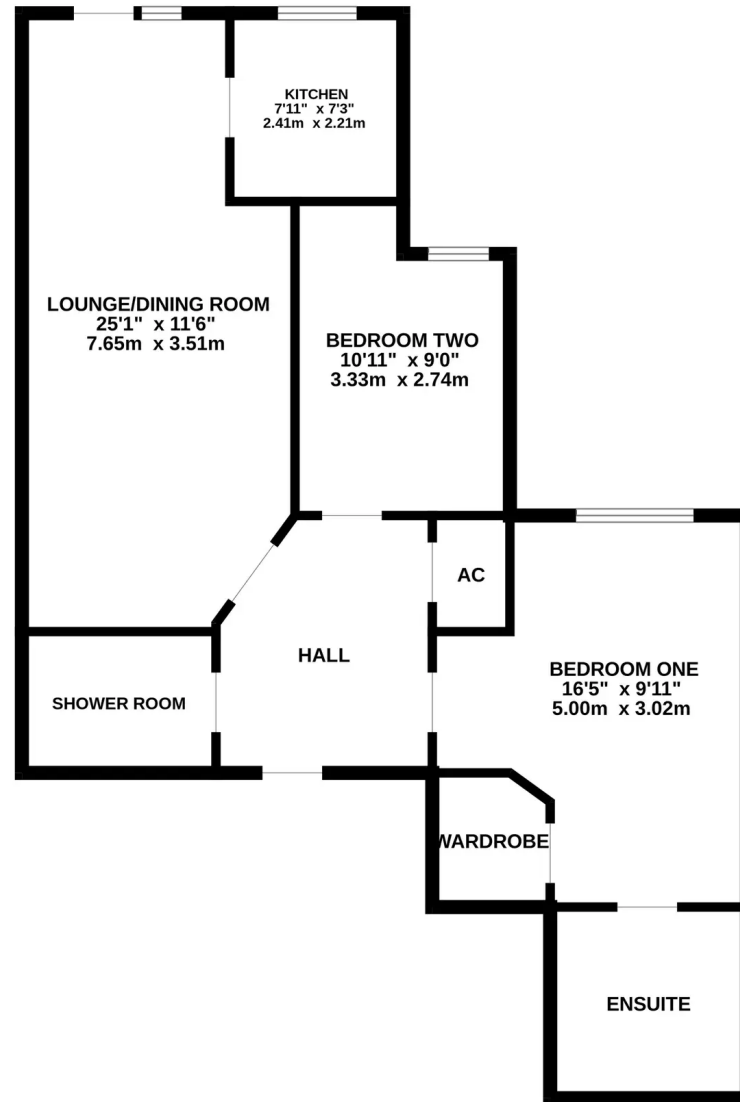

TOTAL FLOOR AREA : 851 sq.ft. (79.1 sq.m.) approx.

Whilst every attempt has been made to ensure the accuracy of the floorplan contained here, measurements of doors, windows, rooms and any other items are approximate and no responsibility is taken for any error, omission or mis-statement. This plan is for illustrative purposes only and should be used as such by any prospective purchaser. The services, systems and appliances shown have not been tested and no guarantee as to their operability or efficiency can be given.

Made with Metropix ©2023