



25 Yellowhammer Court 26 Eagle Drive, London, NW9 5AJ

**Offers In The Region Of £190,000**

Benjamin Stevens is please to present this top floor chain free studio apartment in Yellowhammer Court.

Accommodation comprises large studio room, kitchen area, and bathroom.

Ideal location for access to shopping and amenities, ideal buy to let investment.

Early viewings are highly recommended via vendor's sole agents Benjamin Stevens.



## Studio



## Kitchen Area



## Bathroom



## Tenure

Service Charge - £1,716.87

Ground Rent - £0

Lease Term 986 Years Remaining

Parking Space No.33

## Floor Plan

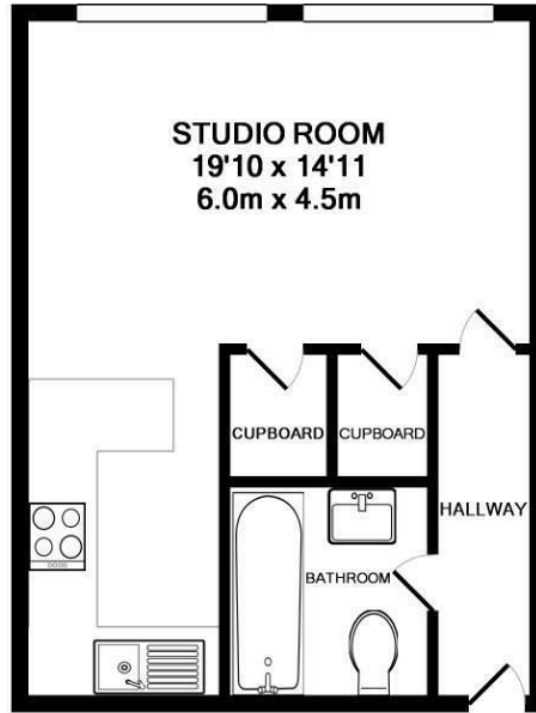

TOTAL APPROX. FLOOR AREA 295 SQ.FT. (27.4 SQ.M.)

Whilst every attempt has been made to ensure the accuracy of the floor plan contained here, measurements of doors, windows, rooms and any other items are approximate and no responsibility is taken for any error, omission, or mis-statement. This plan is for illustrative purposes only and should be used as such by any prospective purchaser. The services, systems and appliances shown have not been tested and no guarantee as to their operability or efficiency can be given  
Made with Metropix ©2014

## Area Map



## Energy Efficiency Graph

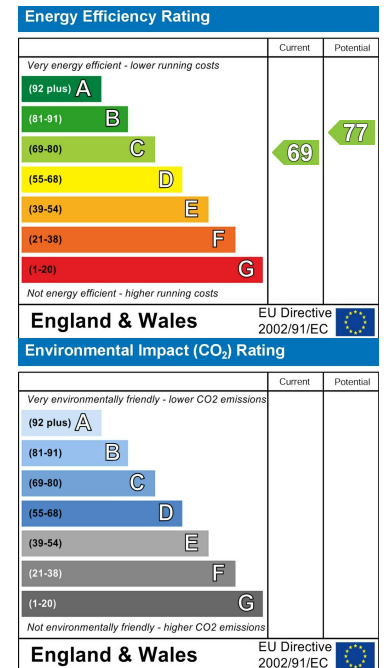

These particulars, whilst believed to be accurate are set out as a general outline only for guidance and do not constitute any part of an offer or contract. Intending purchasers should not rely on them as statements of representation of fact, but must satisfy themselves by inspection or otherwise as to their accuracy. No person in this firm's employment has the authority to make or give any representation or warranty in respect of the property.



Edgware Office- 194 Station Road, Edgware, HA8 7AT. Tel: 020 8958 1118  
Bushey Heath Office- 59 High Road, Bushey, WD23 1EE. Tel: 020 8950 7777  
[www.benjaminstevens.co.uk](http://www.benjaminstevens.co.uk)