



Flat 11, Heathlands Court Beaulieu Road, Dibden Purlieu – SO45 4BB

£159,950

This first floor retirement apartment is set within a well-designed development, built by McCarthy & Stone in 2003, which benefits from a pleasing location on the edge of The New Forest and just a short walk of the local amenities on offer within the village. The well-presented accommodation provides a living room, a kitchen, two bedrooms and a shower room. Within the development there are landscaped gardens, a parking area, a residents' lounge, an on-site warden and a 'care line' cord within each room of the apartment.

GROUND FLOOR
642 sq.ft. (59.6 sq.m.) approx.

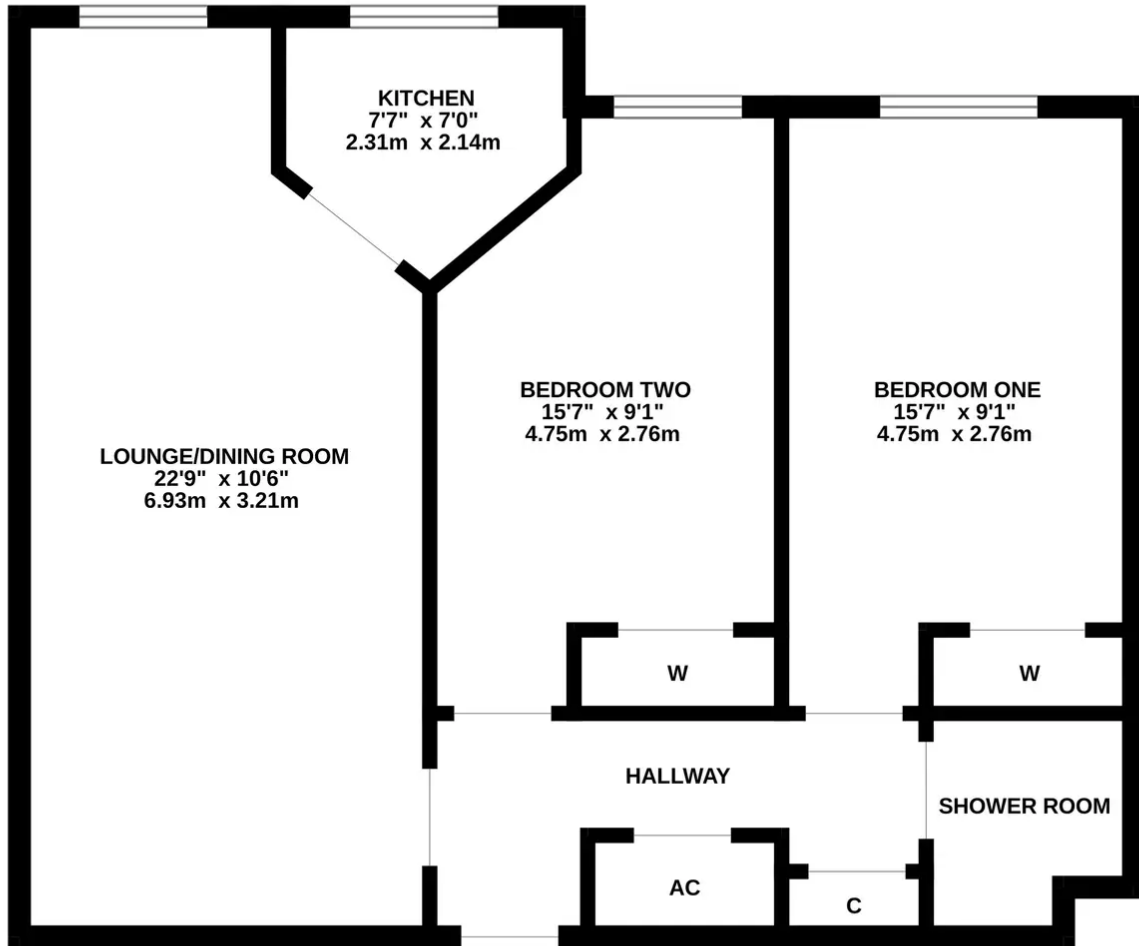

TOTAL FLOOR AREA : 642 sq.ft. (59.6 sq.m.) approx.

Whilst every attempt has been made to ensure the accuracy of the floorplan contained here, measurements of doors, windows, rooms and any other items are approximate and no responsibility is taken for any error, omission or mis-statement. This plan is for illustrative purposes only and should be used as such by any prospective purchaser. The services, systems and appliances shown have not been tested and no guarantee as to their operability or efficiency can be given.
Made with Metropix ©2023

You can include any text here. The text can be modified upon generating your brochure.



1 Southward House
Dibden Purlieu SO45 4PT



T: 02380 844405
info@anthonyjamesproperties.co.uk