

Western Road, Bracknell, RG12 1RF
///outfit.faded.trials



**Western
Peninsula**

4,400 - 9,000 sq ft
Grade A Fitted Workspace
westernpeninsula.co.uk

▼
**Western Peninsula
offers contemporary
workspace in Bracknell's
business district.**

4,400 - 9,000 sq ft of newly fitted and thoughtfully refurbished, Grade A accommodation designed for flexibility and the modern occupier.





▼
The 2nd floor has been comprehensively refurbished and fitted to meet the demands of modern businesses.

Specification



Double height reception



Great parking ratio 1:215 (40 spaces)



VRF air conditioning



New LED light fittings



Shower and changing facilities onsite



Onsite cycle storage

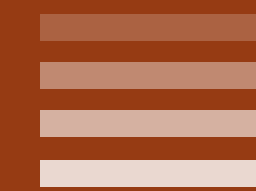

Full access raised floors



EPC rating B 39



New metal suspended ceiling tiles



INIFI superfast internet connectivity

The Club Room

▼
The Club Room has been thoughtfully designed to offer a space for collaboration and recreation away from your desk. This social space provides options for both work and play with a pool table that doubles as a meeting room table.



Workspace

A 'Day 1' fit out has been delivered with the ability to allow occupiers to customise the space to 'Day 2'



▼
Second Floor
8,999 sq ft / 836 sq m
Day 1 fit out

- 40 x workstations
- 2 x 9 person hot desking
- 2 x 10 person meeting rooms
- 4 x 2 person meeting rooms
- 4 x 4 person casual meeting spaces
- 2 x 2 person casual meeting spaces

▼
Club Room
520 sq ft / 48 sqm





▶ **Second Floor**
 8,999 sq ft / 836 sq m
 Day 2 fit out

- 74 x workstations
- 2 x 10 person hot desking
- 2 x 9 person hot desking
- 3 x 8 person hot desking
- 2 x 10 person meeting rooms
- 4 x 2 person meeting rooms
- 9 x 4 person casual meeting spaces
- 3 x 2 person casual meeting spaces

▶ **Club Room**
 520 sq ft / 48 sqm

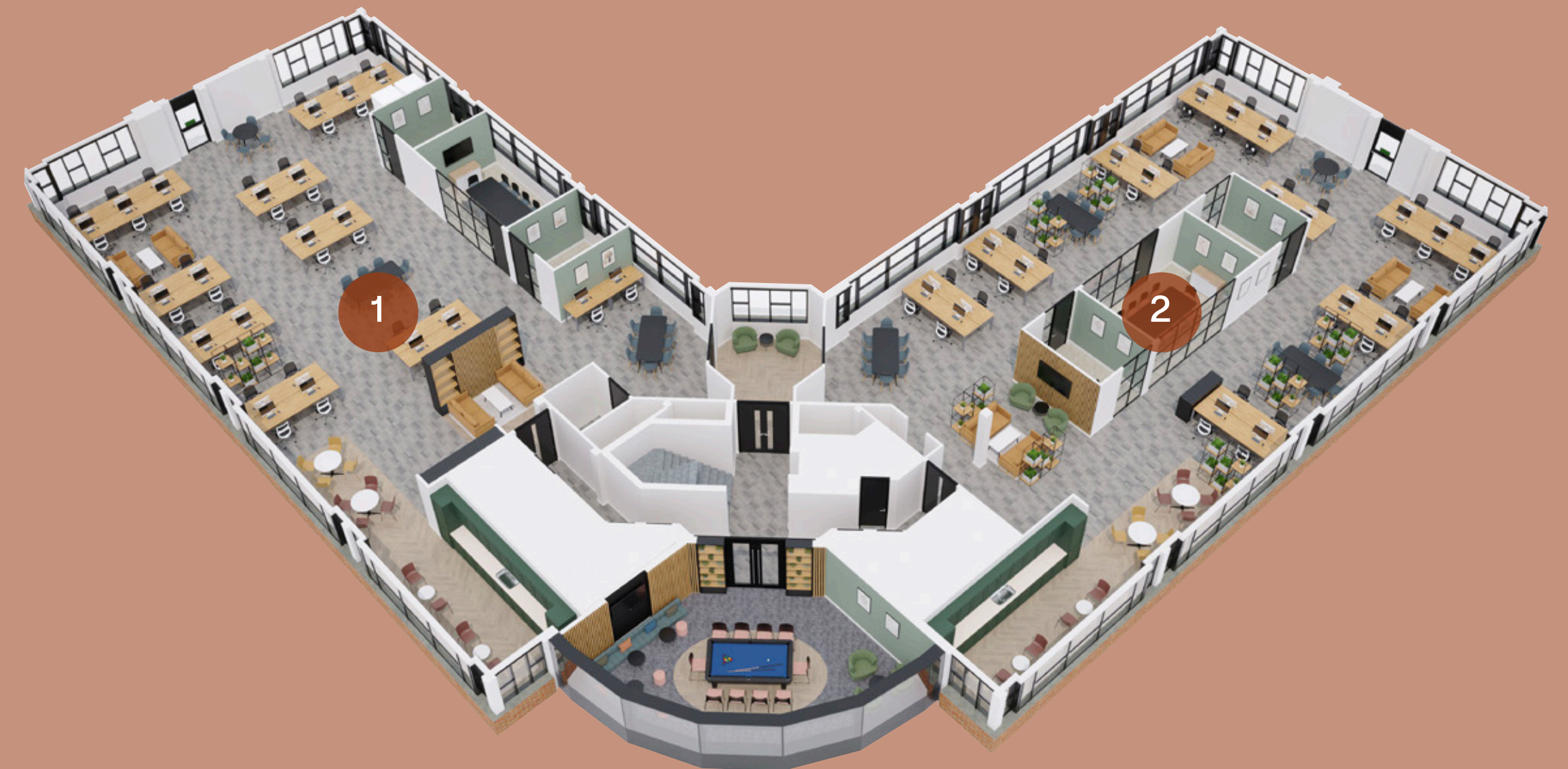

▶ **Second Floor Suite 1**
 4,004 sq ft / 372 sq m

- 38 x workstations
- 1 x 10 person meeting room
- 2 x quiet / zoom rooms
- 1 x breakout area
- 2 x collaboration areas
- 2 x phone booths
- 1 x informal meeting area
- 2 x sofa seating
- 1 x print and copy room

▶ **Second Floor Suite 2**
 4,187 sq ft / 389 sq m

- 36 x workstations
- 1 x 10 person meeting room
- 2 x quiet / zoom rooms
- 1 x breakout area
- 3 x collaboration areas
- 1 x informal meeting area
- 3 x sofa seating
- 32 x lockers

▶ **Club Room**
 520 sq ft / 48 sqm



Amenity



GREGGS

at M&S

WAITROSE
& PARTNERS

cineworld

Fenwick

Premier Inn

Morrisons

ODEON

L'OCCITANE
EN PROVENCE

wagamama

▼
Bracknell town centre has undergone a multi-million pound regeneration comprising new shops, leisure facilities and public spaces.



SWAROVSKI

Waterstones

next

Zizzi

HOTEL
Chocolat.

Nando's
PERI-PERI CHICKEN

OFFICE

las
IGUANAS



▶ The Lexicon offers fabulous shopping, the very best in women's fashion and men's clothing stores, a 12 screen cinema, and many places to eat, from pizza to burgers, Italian restaurants to Japanese and pub favourites.



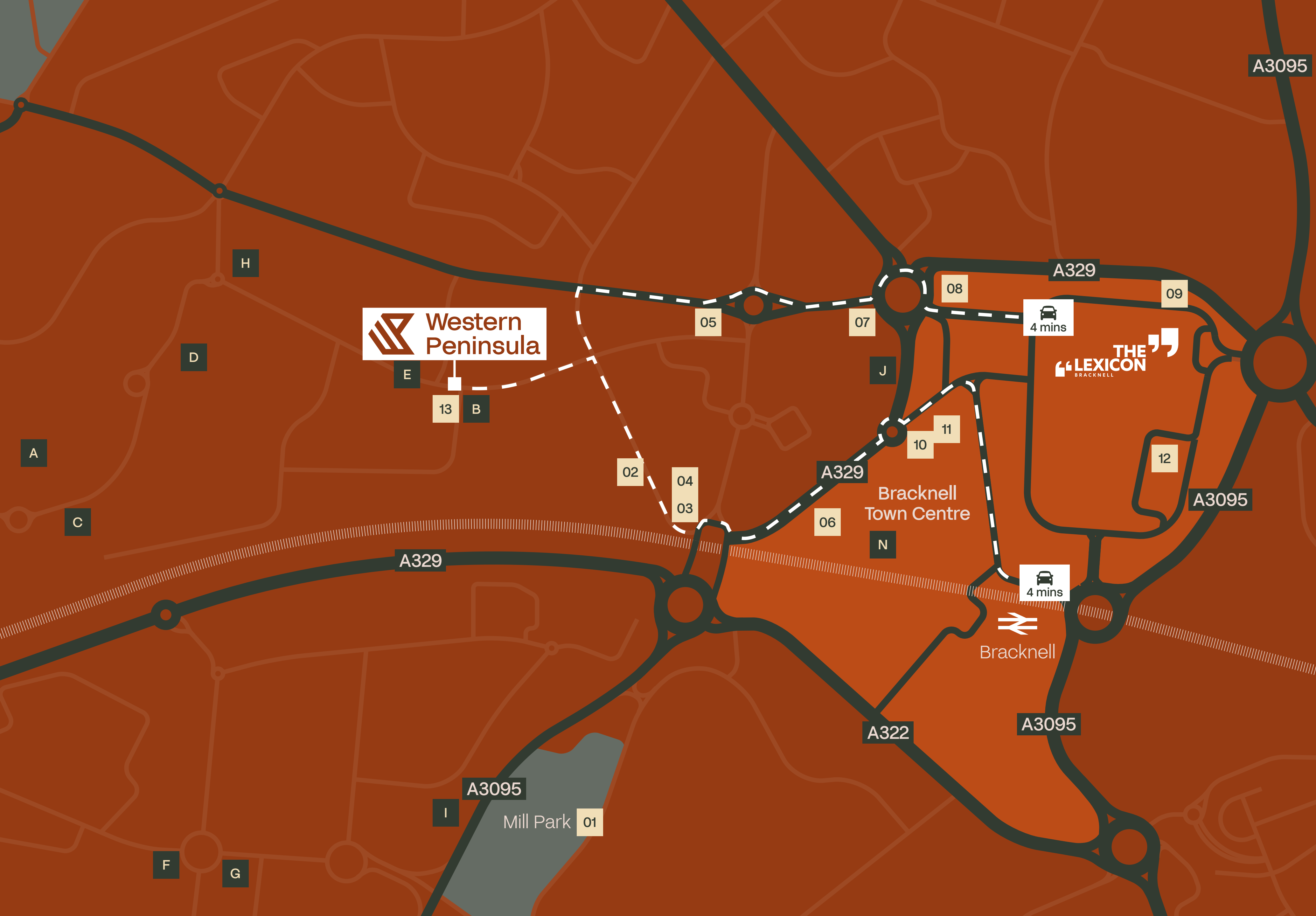

Local Occupiers

- A 3M
- B Dell
- C Diebold Nixdorf
- D Honda
- E Evelyn Partners
- F Fujitsu
- G Boehringer Ingelheim
- H Panasonic
- I Quantum
- J Honeywell

Leisure

- 01 Mill Park Café
- 02 Absolutely Fitness
- 03 House of Fisher Apart-Hotel
- 04 The Gym
- 05 M&S Simply Food
- 06 Morrisons
- 07 Premier Inn
- 08 Waitrose
- 09 Bracknell Library
- 10 Hollywood Bowl
- 11 Odeon Cinema
- 12 The Grange Hotel
- 13 Greggs

Car

- Maidenhead.19 mins
- Reading21 mins
- Slough25 mins
- Woking30 mins
- Basingstoke 32 mins

Rail

- Ascot7 mins
- Egham21 mins
- Paddington 1hr
- Slough1hr 4 mins
- Windsor ..1hr 14 mins





westernpeninsula.co.uk

Contact



Andrew Baillie
ABaillie@vailwilliams.com
07502 233 770

Guy Parkes
gparkes@vailwilliams.com
07788 188 874



Simon Fryer
sfryer@fryercomm.com
07836 519 613

Vail Williams and Fryer Commercial, give notice that these particulars are set out as a general outline only for the guidance of intending Purchasers or Lessees and do not constitute any part of an offer or contract. Details are given without any responsibility and any intending Purchasers, Lessees or Third Party should not rely on them as statements or representations of fact, but must satisfy themselves by inspection or otherwise as to the correctness of each of them. No person employed or engaged by Vail Williams and Fryer Commercial, has any authority to make any representation or warranty whatsoever in relation to this property.

December 2023

2301009 | Design by James & James | jamesjames.design