



- 3 Bedroom Terrace House
- Ground Floor Cloakroom
- Kitchen/Dining Room
- Gas Central Heating
- West Facing Rear Garden
- Pets Considered - £20 Pet Premium
- Available Mid November
- Council Tax Band - 'C'
- EPC Rating - 'C'

31 Fletcher Way, Angmering BN16 4HG

£1,250 pcm

Ground Floor
Approx. 43.8 sq. metres (471.0 sq. feet)

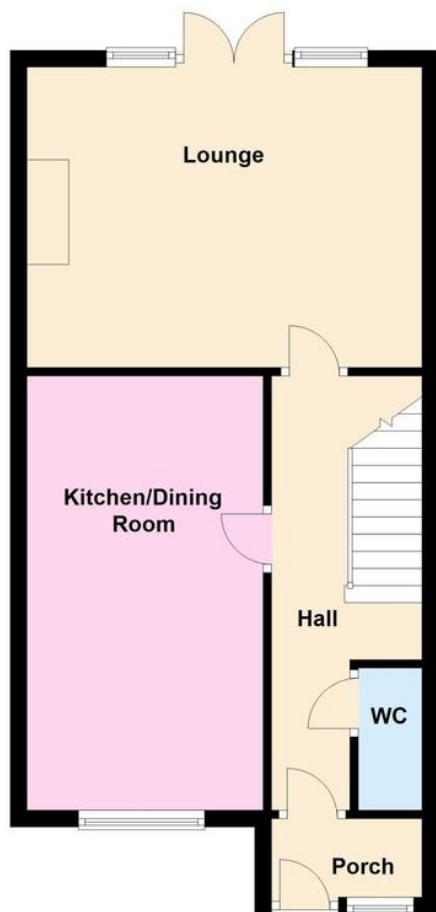

First Floor
Approx. 41.8 sq. metres (450.4 sq. feet)



Total area: approx. 85.6 sq. metres (921.4 sq. feet)

LIBRARY PHOTOS

DOUBLE GLAZED PORCH

ENTRANCE HALL

CLOAKROOM

LOUNGE

15' 6" x 11' 9" (4.72m x 3.58m)

KITCHEN/DINING ROOM

17' x 9' 3" (5.18m x 2.82m)

FIRST FLOOR LANDING

BEDROOM 1

13' 8" x 8' 10" (4.17m x 2.69m)

BEDROOM 2

12' 8" x 8' 9" (3.86m x 2.67m)

BEDROOM 3

9' 7" x 6' 8" (2.92m x 2.03m)

BATH/SHOWER ROOM

The information and measurements contained within these details are for guidance only and do not form part of any contract.

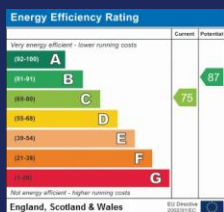

90 THE STREET, RUSTINGTON, WEST SUSSEX, BN16 3NJ

lettings@hawkemetcalf.co.uk

www.hawkemetcalf.co.uk

01903 850450