



Flat 3 Newlands Place, Hartfield Road, Forest Row
£1,500 pcm

INSPIRE



Flat 3 Newlands Place

Hartfield Road, Forest Row

Inspire Estate Agents are pleased to offer for let this beautifully presented and recently renovated 3-bed maisonette in Forest Row. Light and airy living room with Juliet balcony and spacious kitchen. Allocated parking space. Unfurnished and available mid-October.

Council Tax band: B

Tenure: Leasehold

- Modern Apartment
- 3 Bedrooms
- Allocated Parking
- Highly Sought-After Village
- Convenient Location for Local Amenities
- Good Sized Kitchen
- Built-in Appliances
- Recently Renovated Throughout





Living Room

18' 3" x 15' 4" (5.55m x 4.67m)

Kitchen

11' 3" x 6' 11" (3.42m x 2.12m)

Bathroom

5' 4" x 8' 6" (1.63m x 2.60m)

Bedroom 2

11' 3" x 8' 8" (3.43m x 2.64m)

Bedroom 1

11' 2" x 9' 2" (3.41m x 2.79m)

Bedroom 3

6' 8" x 7' 0" (2.04m x 2.14m)



ALLOCATED PARKING

1 Parking Space



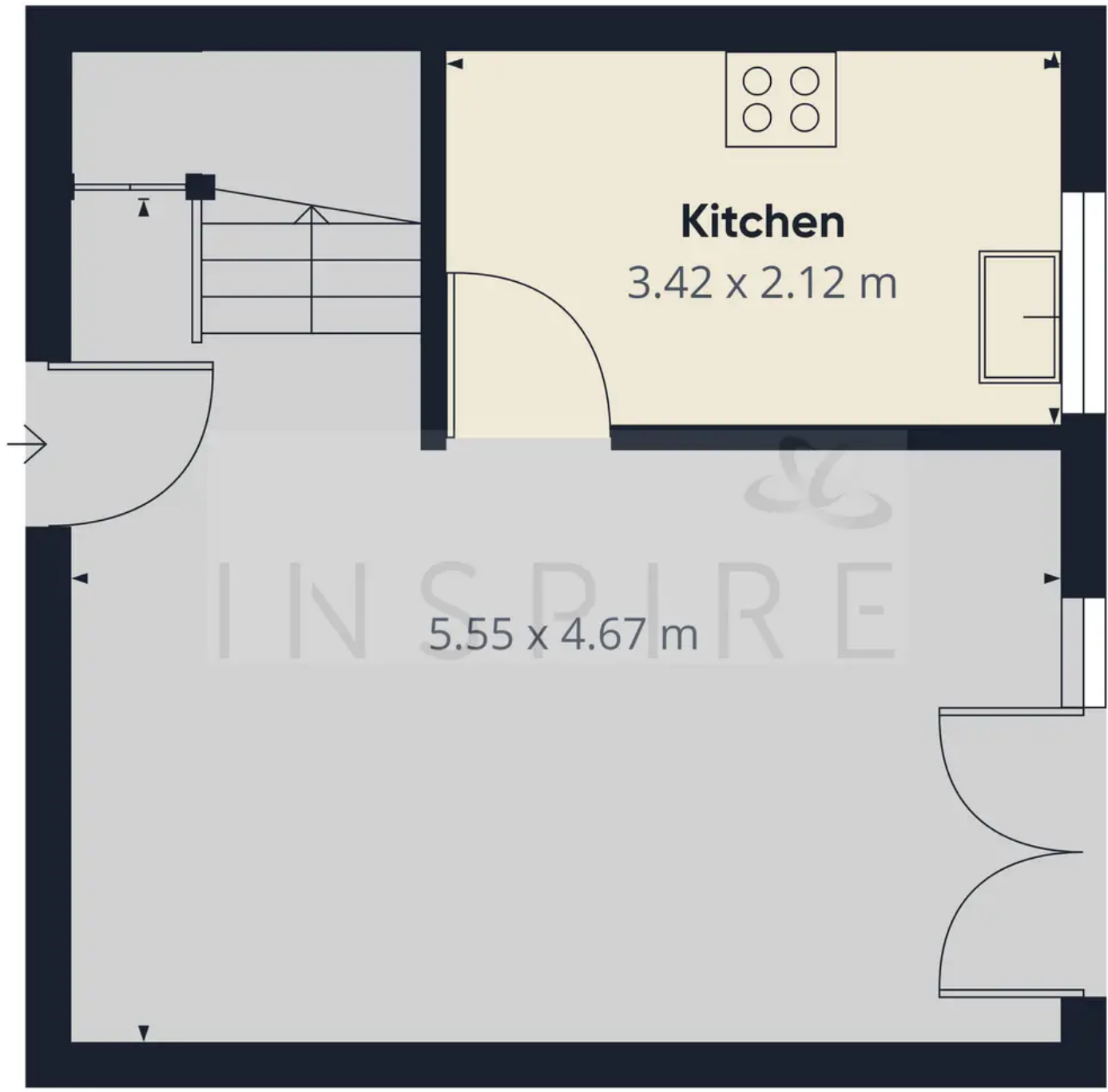

Approximate total area⁽¹⁾
30.26 m²

(1) Excluding balconies and terraces

While every attempt has been made to ensure accuracy, all measurements are approximate, not to scale. This floor plan is for illustrative purposes only.



Inspire

13 Tilgate Parade, Crawley - RH10 5EQ

01293 582335

info@inspireestates.co.uk

<http://www.inspireestates.co.uk>

