



3 Bedroom Mid Terraced House **£1,375**

Priorsfield, Marlborough, Wiltshire, SN8 4AQ

mcfarlane
property.com

3 Bedroom Mid Terraced House Marlborough

- Gas Fired Central Heating
- Double Glazing
- Allocated Parking
- Walking Distance to Town Centre

A modern three bedroom terraced house situated in a quiet Cul de Sac on the Southern outskirts of town.

The ground floor accommodation comprises of an entrance porch, living room, large open plan kitchen/diner, utility room and patio doors leading to the low maintenance enclosed rear garden.

The first floor accommodation has two double bedrooms with fitted wardrobes and a single bedroom. The family bathroom has a bath and over bath shower.

This property has allocated parking for one car, double glazing throughout and benefits from gas fired central heating.

Holding Deposit: £334.61

Deposit: £1,673.07



We where you LIVE

Our team are friendly, experienced and are all local. They know it better than they do their own living rooms and can help you find what you're looking for because **we love where we live.**

We would be delighted to show you around this property.

Because every home needs a personal touch.

If you would like to view this property then please get in touch.

 01793 611841

 lettings@mcfarlaneproperty.com

mcfarlaneproperty.com

Ground Floor

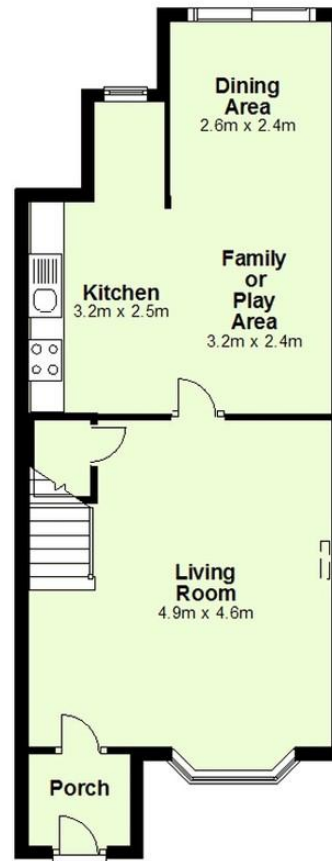

mcfarlane
property.com

Cricklade.
102 High Street
Cricklade SN6 6AA
 01793 751044

Marlborough.
106 High Street
Marlborough SN8 1LT
 01672 514380

Old Town.
28-30 Wood Street
Swindon SN1 4AB
 01793 296880

Swindon.
The Village Centre,
Redhouse SN25 2FW
 01793 296600

Agents Note: Whilst every care has been taken to prepare these sales particulars, they are for guidance purposes only. All measurements are approximate are for general guidance purposes only and whilst every care has been taken to ensure their accuracy, they should not be relied upon and potential buyers are advised to recheck the measurements