 **5**
Bedrooms

 **2**
Bathrooms

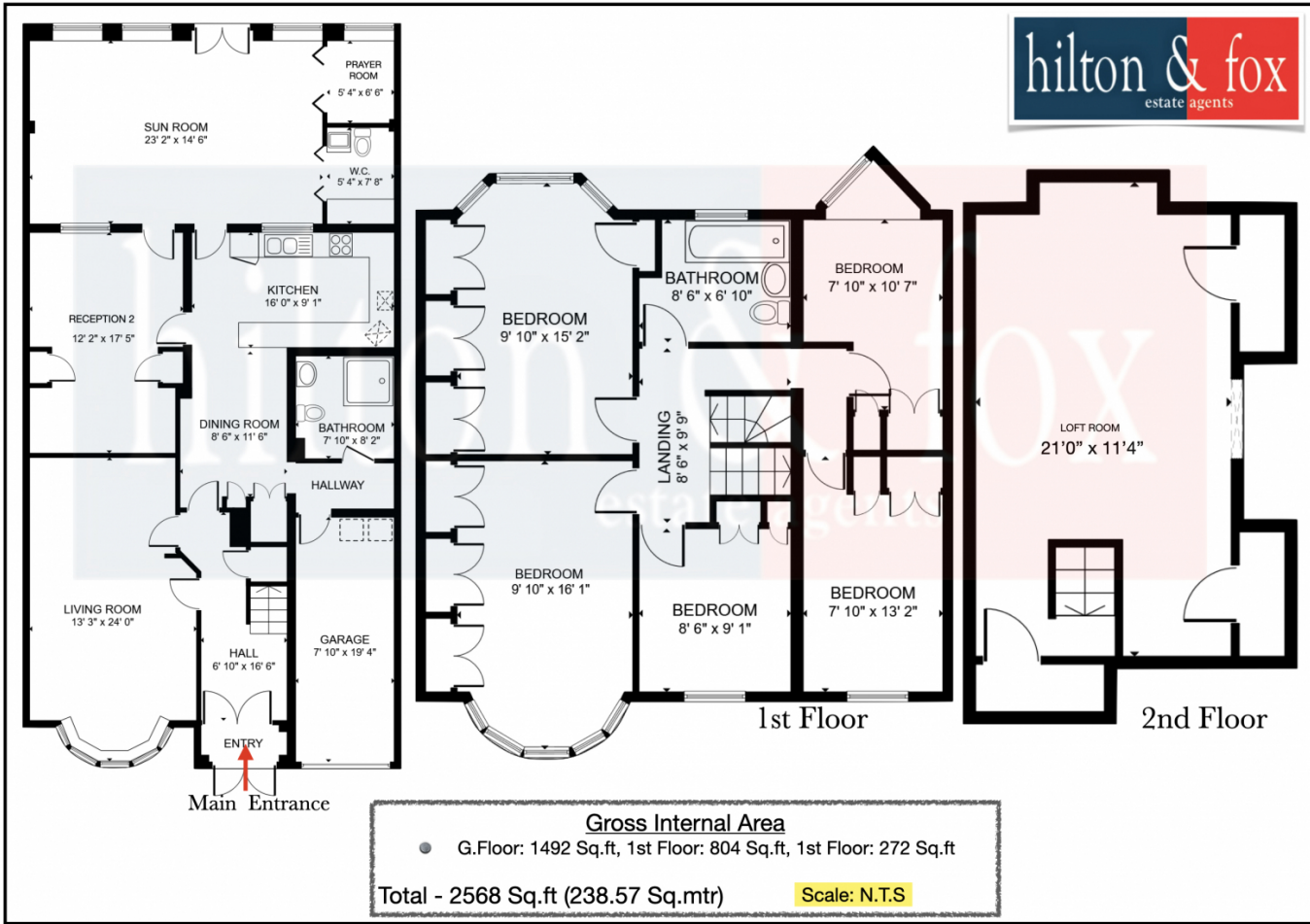

This substantial Five/Six Bedroom Semi-Detached family home is heavily extended and thought out to make the most of the space provided. To the ground floor there is a large lounge, large kitchen/diner, conservatory, prayer room, guests' bathroom and integrated garage. To the first floor all Five Bedrooms and the family bathroom. Externally to the front there is ample parking for a number of cars, whilst to the rear a well-established large spacious north/west facing garden. The property is also ideally placed to give you easy access to Sudbury Town's variety of local shops and transport links.

This substantial Five/Six Bedroom Semi-Detached family home is heavily extended and thought out to make the most of the space provided. To the ground floor there is a large lounge, large kitchen/diner, conservatory, prayer room, guests' bathroom and integrated garage. To the first floor all Five Bedrooms and the family bathroom. Externally to the front there is ample parking for a number of cars, whilst to the rear a well-established large spacious north/west facing garden. The property is also ideally placed to give you easy access to Sudbury Town's variety of local shops and transport links.





The Clementine Churchill Hospital

Blue Court Dental Centre

Sudbury Court

Sudbury Fields - The John Lyon School...

Scribbles Early Learning Centre

Shaam Restaurant & Catering Services

Salisbury Support 4 Autism

St. George's Catholic Church

Vale Farm Sports Centre

Rising Sun Restaurant &

London Post Office Sport & Social Association

Sudbury Hill Harrow

Partyman World of Play

MUMBAI ZING

Jalsa Foods

Sudbury Hill

Mieszko Polski Supermarket

LNER Sports and Social Club

The Aura