



6 Taff Vale Building Duke Street, Aberdare, CF44 7AD

Guide Price £42,000 Leasehold

No Onward Chain • Ideal Investment Opportunity/First Time Buy • Well-Presented Accommodation • Top Floor Flat • Lift Access • Allocated Parking

BIDMEAD COOK

26 Whitcombe Street, Aberdare, Rhondda Cynon Taff, CF44 7AU
Tel: 01685 886086 Email: aberdare@bidmeadcook.co.uk
www.bidmeadcook.co.uk

Online Auction Via Auction House, bidding opens Monday 23 October at midday and closes on Wednesday 25 October at midday. A one bedroom top floor apartment. The property is accessed via a secure door with intercom access and benefits include a lift and allocated parking space. The accommodation comprises an entrance hallway, various storage areas, open-plan reception room/kitchen with integrated appliances, bedroom and bathroom. NO ONWARD CHAIN.

Buyer's Premium - £600 including VAT payable on exchange of [contracts.Auction](#) House have an Administration Charge of 1.2% including VAT of the purchase price, subject to a minimum of £1,200 including VAT, to be paid by the purchaser on exchange of contracts. Disbursements - Please see the legal pack for any disbursements listed that may become payable by the purchaser on completion. **Guide Price - An indication of a seller's minimum expectation at auction and given as a "Guide Price" or a range of "Guide Prices". This is not necessarily the figure a property will sell for and is subject to change prior to the auction.**



Council Tax band: A. Tenure: Leasehold.
EPC Energy Efficiency Rating: C

Agents Note: We are advised this property is Leasehold, 125 year lease commencing 1 January 2011.

Ground Rent is fixed at £100 per annum.

The current Service Charge is £65 per month.

The Service Charge is reviewed during January, annually.



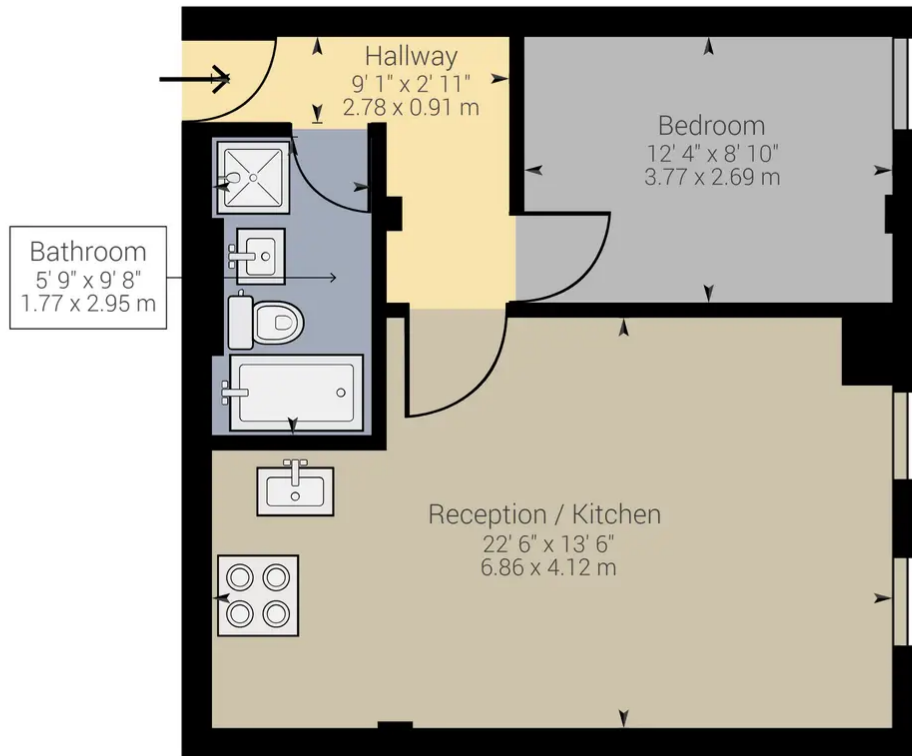

Approximate net internal area: 493.81 ft² / 45.88 m²

While every attempt has been made to ensure accuracy, all measurements are approximate, not to scale. This floor plan is for illustrative purpose only and should be used as such by any prospective tenant or purchaser.



No statement in these details is to be relied upon as representation of fact, and purchasers should satisfy themselves by inspection or otherwise as to the accuracy of the statements contain within. These details do not constitute any part of any offer or contract. Bidmead Cook and their employees and agents do not have any authority to give warranty or representation whatsoever in respect of this property. These details and all statements herein are provided without any responsibility on the part of Bidmead Cook or the vendors. Equipment: Bidmead Cook has not tested the equipment or central heating system mentioned in these particulars and the purchaser are advised to satisfy themselves as to the working order and condition. Measurements: Great care is taken when measuring, but measurements should not be relied upon for ordering carpets, equipment etc. The Laws of copyright protect this material. Bidmead Cook is the owner of the copyright. This property sheet forms part of our database and is protected by the database right and copyright laws. No unauthorised copying or distribution without permission.

Bidmead Cook is a trading name of trading name of BC Acquisition Ltd. Registered in England No.14967217