



- 3 Bedroom House
- South Rustington
- New Floor Coverings
- Recently Redecorated
- Gas Central Heating & Double Glazing
- Available End of Oct/Early Nov
- No Pets
- Council Tax - Band 'C'
- EPC Rating - 'C'

11 Shaftesbury Road, Rustington BN16 2HR
£1,350 pcm

Ground Floor

Approx. 44.2 sq. metres (475.5 sq. feet)

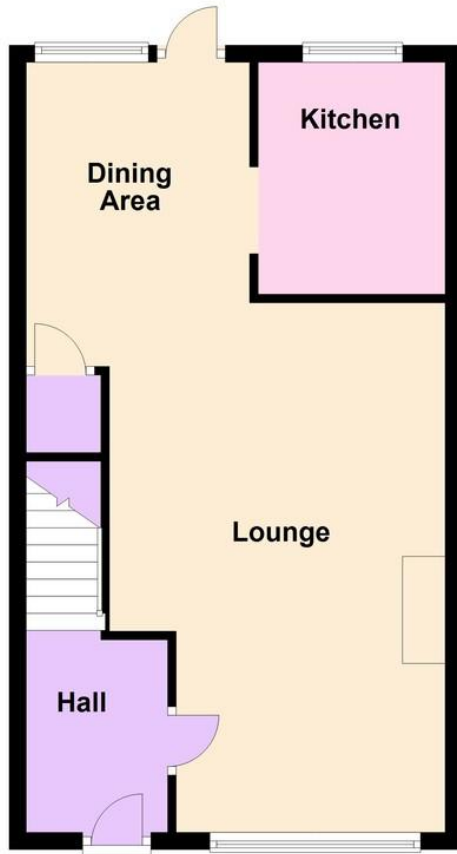

First Floor

Approx. 44.2 sq. metres (475.5 sq. feet)

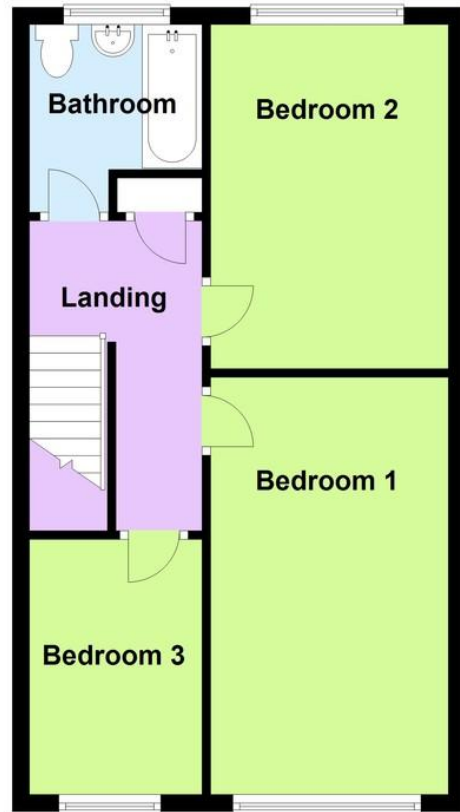

Total area: approx. 88.3 sq. metres (951.0 sq. feet)

Available end of October - beginning of November.

Recently refurbished 3 bedroom house between Rustington village centre and the seafront. Gas central heating, double glazing, new floor coverings and a refurbished kitchen. **NO PETS.** *Agents Note* The kitchen pictured is being refurbished.

ENTRANCE HALL

LOUNGE

19' 2" x 12' 10" (5.84m x 3.91m)
max

DINING AREA

9' 4" x 8' 7" (2.84m x 2.62m)

KITCHEN

8' 10" x 7' 1" (2.69m x 2.16m)

BEDROOM 1

15' 5" x 9' 4" (4.7m x 2.84m)

BEDROOM 2

13' 2" x 9' 4" (4.01m x 2.84m)

BEDROOM 3

9' 8" x 6' 5" (2.95m x 1.96m)

FRONT & REAR GARDENS

The information and measurements contained within these details are for guidance only and do not form part of any contract.

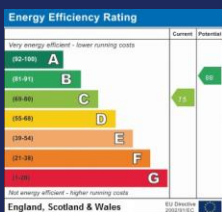

90 THE STREET, RUSTINGTON, WEST
SUSSEX, BN16 3NJ

lettings@hawkemetcalf.co.uk

www.hawkemetcalf.co.uk

01903 850450