



LOWMANS
BLEWBURY



WELCOME HOME

If you are looking for a home with boundless space, then look no further. Lowmans, a four-bedroom vaulted, single-storey home in the picturesque village of Blewbury is an absolute stunner!

With a 4249 sq ft blueprint, you'll be dazzled by this gorgeous one-level home. It feels like a barn conversion with its lofty timber-vaulted ceilings but in fact it was designed and constructed to the highest of standards by the current owners 20 years ago and has been meticulously maintained ever since.

Lowmans is a stupendous family-sized home, with lots of flexibility and scope – a lock-up-and-leave weekend/holiday escape from the city or an AirBnB-style rental are two options that come to mind.

Size is show-pieced here and the focus is the 46x16ft lounge, with enormous inglenook fireplace, which flows seamlessly into the 23x16ft dining room – both are flooded with light via bifold doors to one of Lowmans' chic garden terraces – this place is perfect for all-year-round entertaining.





Loads of space too in the bright and cheerful 20x16ft farmhouse-style kitchen/breakfast room, again with a bank of bifold doors, while the principal bedroom suite is privately and peacefully located at the end of the lounge 'wing', tucked away from the rest of the house.

With paved parking for multiple cars in front of a triple carport, an acre of gardens and a luxe covered hot tub, Lowmans is a winner in both specification and desirable Vale of White Horse location.

Blewbury is a welcoming, lively community with Tudor timbered and thatched heritage properties at its heart, plus all the village necessities from primary school to family-friendly pub.

And you're cosily ensconced within the North Wessex Downs Area of Outstanding Natural Beauty, a stone's throw from the Ridgeway Path on the Oxfordshire/Berkshire border, so first-class walking, riding and cycling is a given. Let's explore Lowmans further . . .





A RURAL IDYLL WITH SPACE, SCOPE AND STYLE

The double arched oak front doors are tucked away under a pretty porch with a clock turret on the roof above and they swing open into the gorgeous oak-floored dining room which sweeps open-plan to the lounge.

It's a huge, impressive timber-vaulted space which manages to combine the vast amount of room with a warm and comfortable vibe. And it offers total flexibility – you can have the biggest dining table and chairs, enormous squashy sofas, a massive wall-mounted TV. The choice, of course, is yours and the options are endless.





The enormous red-brick inglenook fireplace in the lounge is a real showstopper; fitted with a woodburner for winter warmth, there's enough space in the 18ft alcove to tuck a comfy chair on either side – really cosy.

There's gas central heating throughout Lowmans and a nifty extra is a Duovac internal Hoover system.

Cross the big internal hallway, with cloakroom/WC to the

side, to an utterly charming home study – the walls of which are beautifully adorned with hand-painted murals of the much-loved characters imagined by author and cartoonist, Dr. Seuss.

The perfect hub for young children or those with creative minds, this welcoming room invites you to blissfully explore your imagination and even comes complete with its very own hot air balloon basket!





When food calls, wander to the kitchen/breakfast room which is fitted with hand-made cream farmhouse-style units, an AGA stove with gas hob, electric ovens and copper splashback, big central island with space for four bar stools, twin sinks and ceramic tiled floor. With a trio of windows to one side, bifold doors to the other and splashes of red in the wall tiles, this is a sunny, feel good space that's the natural heart of the home.

All the laundry appliances, including a built-in ironing board, can be tucked away in the roomy utility room, and there's a big walk-in pantry. There's also a double-aspect study.





AND SO TO BED . . .

A haven of self-contained privacy with its own decked and covered veranda, the principal bedroom has an en-suite bathroom with Velux windows, dressing room and its own cosy snug for relaxing with a book or watching TV in peace.

The hot tub garden terrace divides this wing of the home from the second bedroom wing which has two generously proportioned bedrooms accessed from a corridor with French doors to the garden and Velux windows overhead. Merging indoors with outdoors is a feature of Lowmans with both bedrooms featuring French doors to the garden terraces. There's also a family bathroom with bath tub featuring waterfall shower and steam jets.

The fourth bedroom offers flexibility of use, within the house but positioned a little away from the remainder and with exterior access. It's currently used as a sitting room but could also make the perfect office as it's self-contained with a cloakroom/WC. With four insulated lofts, complete with power, there's no shortage of storage at Lowmans.







INTO THE GARDEN . . .

With an acre of securely fenced and lawned garden to the rear, including a separate paddock which would be perfect for a pony, Lowmans' garden is low maintenance but with the potential to develop as you wish. Perhaps add some play equipment for youngsters or keen gardeners can cultivate ornamental borders, a vegetable garden and so on – a garden shed is already in place.

The main garden terrace, handily accessed via the bifold doors in the kitchen, is the perfect spot for summertime al fresco family meals and entertaining friends. And, of course, everyone will enjoy a dip in the hot tub.



ROUND AND ABOUT

Blewbury is the perfect 'escape to the country', combining all the facets of a rural lifestyle with the desirable extras - a shop selling groceries and the daily papers at Blewbury Service Station, Savages farm shop with artisan bread from Blewbury Bread Co and Style Acre tea-room, and the welcoming 250-year-old village 'local' The Red Lion, open all day and serving popular pub grub and well-kept ales. There's also The Blueberry which specialises in wood-fired pizzas and Thai dishes.

Other highly-rated foodie pubs include the Beetle & Wedge at Moulsoford and The Chequers at Burcot.

Dressed in cherry red sweatshirts, the local children attend Blewbury CE Primary School while the nearest secondary schools

are a couple of miles away in the town of Didcot – Didcot Girls School is Ofsted-rated 'outstanding' and St Birinus School is 'good'. There's an excellent choice of private schools within a ten-mile radius – the nearest are Cranford House, Moulsoford Prep, The Oratory Prep, The Treehouse School and Abingdon School.

Being on the edge of the Berkshire Downs, the chance to walk the local trails and Ridgeway Path isn't to be missed. This is horse-riding country and the gallops still remain, along with Blewbury Riding Centre.

Drive a few miles to Didcot for supermarkets including Sainsbury's, Tesco and Asda, and a great range of high street stores, coffee shops, pubs and leisure options.



It's a little further to Abingdon, where there's a Waitrose store, and further superb shopping is on offer in Reading and Newbury.

The village of Blewbury is a buzzy place to put down roots, with lots going on all-year-round for those who want to join in. From fitness classes, wine tastings, bridge club, craft club and a painting group in the village hall to a choice of sports based at Blewbury clubhouse, there's something for everyone.

Blewbury has always had a strong creative tradition and artists, craftsmen and writers including Dick Francis and Kenneth Grahame, have made their home in the village. The Blewbury Players and Blewbury Brass Band are both renowned.

If you work in London, you can hop on a fast train at Didcot Parkway and be at Paddington in 40 minutes, while drivers can zip along the country lanes to access the M40 and M4.



WHERE TO GO WHEN YOU NEED...



Milk: Savages Farm Shop is a delightful local farm shop, selling lots of fresh local produce – perfect for the odd pint of milk, forgotten groceries or special occasion items. Alternatively, Costcutter and McColls can be found in nearby village Chilton, or the local BP garage has a selection of everyday essentials, confectionary and a Costa Express machine.



Weekly Shop: Didcot is the ideal place for your weekly shop, boasting a selection of large superstores including Sainsbury's, Tesco, Aldi, Asda and Iceland – all are just over ten minutes away.



Gym/Fitness: There's plenty to keep little ones entertained locally, too, with The Astons recreation ground less than a couple of miles away. Slightly further afield you will find Smallbone recreation park and Greenwood Way recreation park. Soft play areas can also be found slightly further afield, with Junglemania in Reading proving a popular day out.



Walks: The Blewbury Ridgeway Loop is accessible just a short walk from the front door and is a 9km circular trail – perfect for hiking, running and bike rides. Furthermore, the Thames Pathway is accessible in nearby Cholsey near Wallingford – the perfect starting point for a picturesque dog walk or weekend stroll.



Parks And Recreational Grounds: There's plenty to keep little ones entertained locally, too, with The Astons recreation ground less than a couple of miles away. Slightly further afield you will find Smallbone recreation park and Greenwood Way recreation park. Soft play areas can also be found slightly further afield, with Junglemania in Reading proving a popular day out.



Golf: If golf is your passion, you're spoiled for choice here! The Springs Resort & Golf Club in close-by Cholsey runs alongside the River Thames and is home to a 133-acre parkland golf course with additional golf shop, driving range and coaching and performance centre. The resort also hosts hotel rooms and self-catered lodges with hot tubs, and a fully equipped and renovated spa with additional gym facilities – making it the perfect place to unwind and relax. Other nearby clubs include Hadden Hill, Goring & Streatley and Huntercombe, and there's a driving range – Smoke Acre – just a two minute drive from Lowmans.



Dinner/Drinks: The current owners' favourite places to wine and dine locally include The Beetle and Wedge situated on the riverside in Moulsoford, and The Chequers at Burcot. However, the local area isn't short of fantastic eateries – Le Clos in nearby Wallingford and The Coppa Club in Streatley-on-Thames are popular options, too. For an extensive choice of entertainment and restaurant options, Reading is just 30 minutes away while Oxford city centre is a 35-minute drive.



Schools: This area of Oxfordshire boasts some of the best independent schools in the country. Within a ten-mile radius, you will find: The Treehouse School, Moulsoford Preparatory School, Cranford House School, Bradfield College, Our Lady's Abingdon, Abingdon School, Radley College, Pangbourne College, St Helen and St Katherine and The Manor Preparatory School. There are regular bus services to the local schools from local villages.

Total Square Footage:
4,249 sq ft / 394.8 sq m

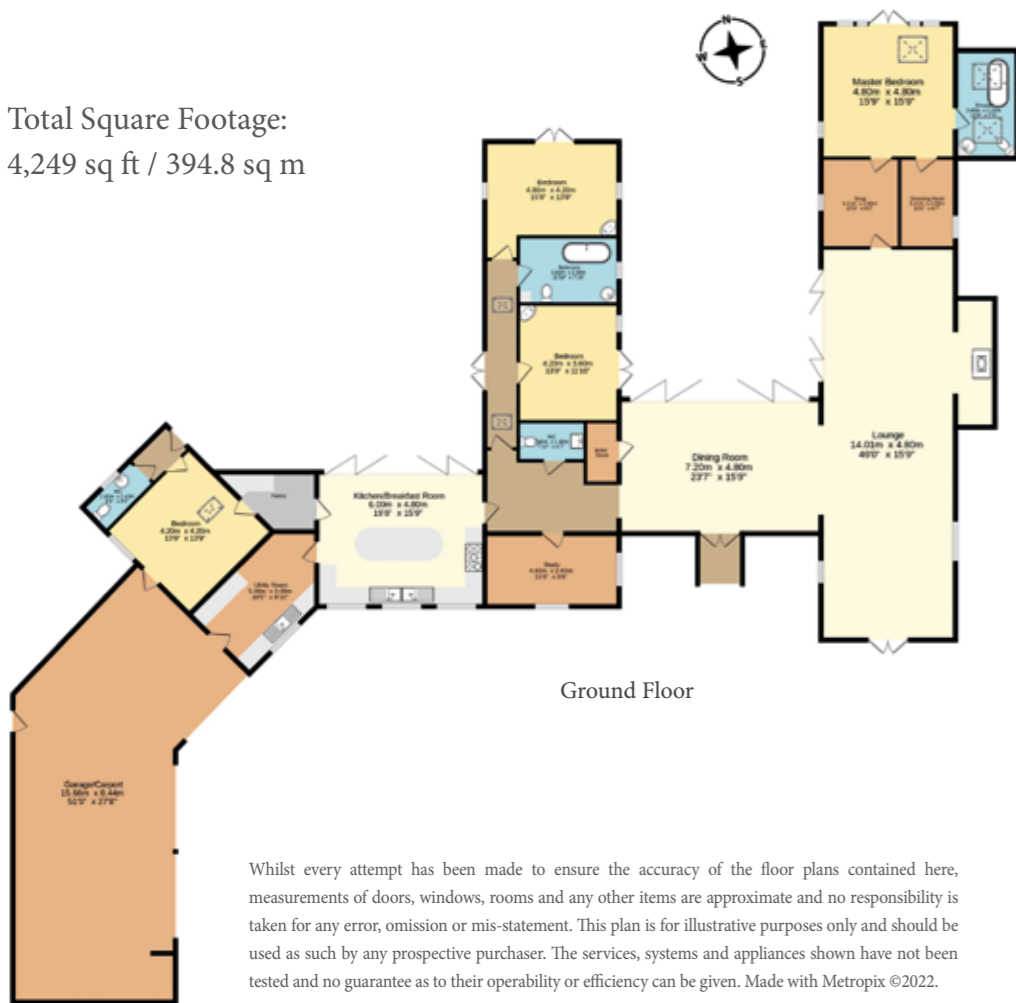

Whilst every attempt has been made to ensure the accuracy of the floor plans contained here, measurements of doors, windows, rooms and any other items are approximate and no responsibility is taken for any error, omission or mis-statement. This plan is for illustrative purposes only and should be used as such by any prospective purchaser. The services, systems and appliances shown have not been tested and no guarantee as to their operability or efficiency can be given. Made with Metropix ©2022.

Important notice: Stowhill Estates Ltd, their clients and any joint agents give notice that:

- 1) They are not authorised to make or give any representations or warranties in relation to the property either here or elsewhere, either on their own behalf or on behalf of their client or otherwise. They assume no responsibility for any statement that may be made in these particulars. These particulars do not form part of any offer or contract and must not be relied upon as statements or representations of fact.
- 2) Any areas, measurements or distances are approximate. The text, photographs and plans are for guidance only and are not necessarily comprehensive.

It should not be assumed that the property has all necessary planning, building regulation or other consents and Stowhill Estates Ltd have not tested any services, equipment or facilities. Purchasers must satisfy themselves by inspection or otherwise. Photos and Brochure prepared December 2022.



THE FINER DETAILS

- Square footage: 4,249 square feet / 394.8 square metres (total)
- Local Authority: Oxfordshire County Council
oxfordshire.gov.uk
- Council Tax Band: G
- Gas Central Heating
- Distances: Didcot/Didcot Parkway 3.9 miles
Wallingford 5.9 miles
Abingdon 12.2 miles
Oxford 18.5 miles
Heathrow 44.7 miles
London 59.9 miles
- Tenure: Freehold
- EPC: D





Scan me to book a viewing
or call the Stowhill Estates Team on:
01235 751 888 | hello@stowhillestates.com



STOWHILL ESTATES

What Three Words: [///downs.spire.gobbles](https://www.threewords.co.uk/words/downs.spire.gobbles)