

FOR SALE



Leysmill Close, Hinckley
£217,000

MARTIN & CO



Leysmill Close, Hinckley

2 Bedrooms, 1 Bathroom

£217,000

- QUIET CUL DE SAC LOCATION
- TWO BEDROOM SEMI DETACHED BUNGALOW
- GOOD SIZED LOUNGE DINER
- TWO BEDROOMS

CUL DE SAC LOCATION - A two bedroom semi detached bungalow located within reach of local amenities/access to A5 for commuting. Comprising hallway, lounge diner, kitchen, two bedrooms and a shower room. Gas central heating, double glazing, driveway for off road parking and front and rear garden.

FRONT ENTRANCE HALLWAY Having a carpeted floor and providing access to most rooms

SHOWER ROOM 6' 4" x 8' 11" (1.94m x 2.72m) Having a modern white suite comprising WC, sink and shower cubicle. Storage cupboard.

BEDROOM 10' 7" x 8' 1" (3.25m x 2.48m) Having a carpeted floor and decorated in a neutral colour

BEDROOM 11' 2" x 10' 2" (3.41m x 3.10m) Double bedroom with double glazed bay window. Having a carpeted floor and decorated in a neutral colour

LOUNGE 18' 7" x 10' 2" (5.67m x 3.10m) A good sized living room with a UPVC sliding patio door leading to the rear garden. Gas fire. Access to the kitchen.



KITCHEN 8' 11" x 8' 11" (2.72m x 2.72m) Modern white fronted wall and base units with a light coloured work surface. Side door to the driveway. Modern boiler.

FRONT AND REAR GARDENS AND DRIVEWAY
Gardens are mostly lawn bordered by mature bushes.
Side driveway.



YOUR PROPERTY Overview



Boundary (Land Registry Title Plan)



PROPERTY KEY FACTS

UPRN: 100030505497
 Floor Area: 516 ft²
 48 m²
 Plot Size: 0.06 acres
 Council Tax Band: B

AREA KEY FACTS

Local Authority: Hinckley And
 Bosworth
 Flood Risk: Very Low
 Conservation Area: No
 Property Details

PLANNING HISTORY

No Planning Records Available

Score	Energy rating	Current	Potential
92+	A		
81-91	B		87 B
69-80	C		
55-68	D	68 D	
39-54	E		
21-38	F		

GROUND FLOOR
574 sq.ft. (53.4 sq.m.) approx.

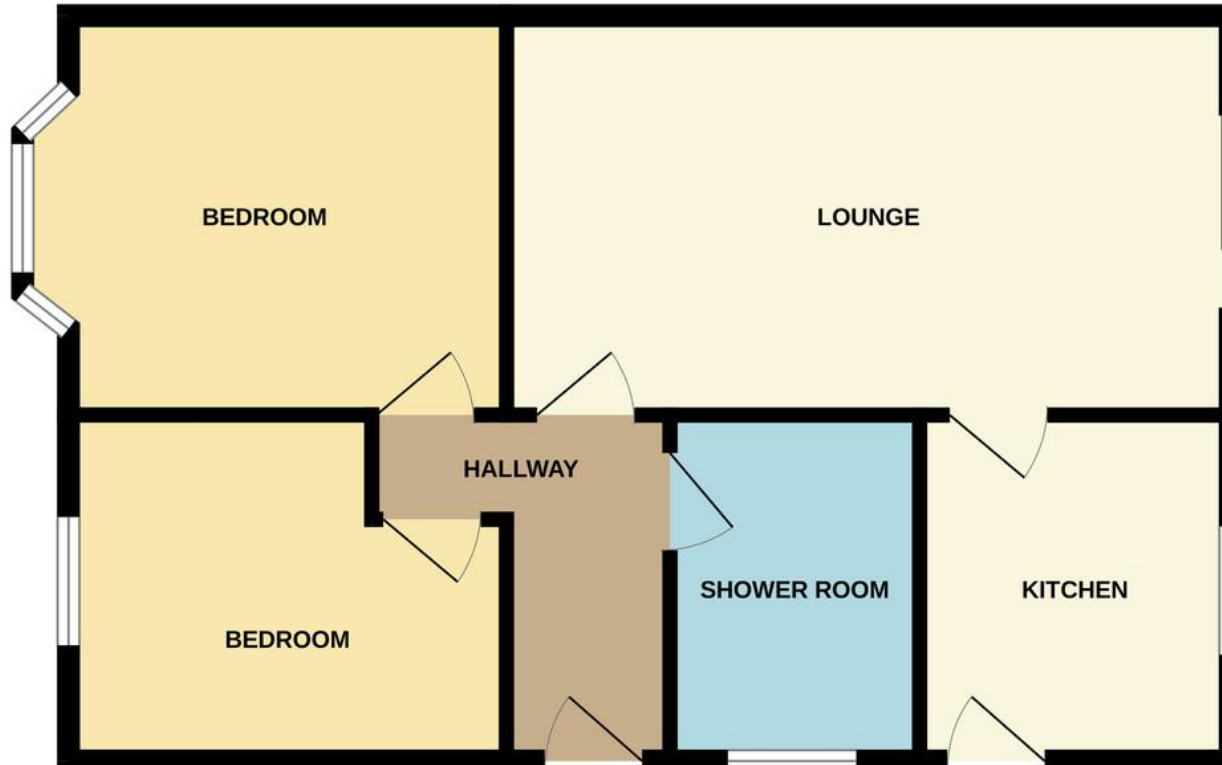

Martin & Co Hinckley

99-109 Castle Street • • Hinckley • LE10 1DA
T: 01455 636349 • E: hinckley@martinco.com

01455 636349

<http://www.martinco.com>



Accuracy: References to the Tenure of a Property are based on information supplied by the Seller. The Agent has not had sight of the title documents. A Buyer is advised to obtain verification from their Solicitor. Items shown in photographs including but not limited to carpets, fixtures and fittings are not included unless specifically mentioned within the sales particulars. They may however be available by separate negotiation. Buyers must check the availability of any property and make an appointment to view before embarking on any journey to see a property. No person in the employment of the agent has any authority to make any representation about the property, and accordingly any information given is entirely without responsibility on the part of the agents, sellers(s) or lessors(s). Any property particulars are not an offer or contract, nor form part of one. **Sonic / Laser Tape:** Measurements taken using a sonic / laser tape measure may be subject to a small margin of error. **All Measurements:** All Measurements are Approximate. **Services Not tested:** The Agent has not tested any apparatus, equipment, fixtures and fittings or services and so cannot verify that they are in working order or fit for the purpose. A Buyer is advised to obtain verification from their Solicitor or Surveyor.