



4 Bedroom Semi-Detached House £330,000

19 Strouds Close, Swindon, SN3 1FD

mcfarlane
property.com

4 Bedroom Semi-Detached House Swindon, Old Town

- OLD TOWN LOCATION
 - FOUR DOUBLE BEDROOMS
 - THREE STORIES
 - ALLOCATED PARKING
 - FULLY ENCLOSED SOUTH WEST GARDEN
 - FAMILY HOME
-



Ideally located just a short walk from the heart of Old Town is this four bedroom family home with generous accommodation arranged over three floors. To the ground floor there is a triple aspect sitting room with access to the garden, kitchen/dining room and cloakroom. To the second floor are two bedrooms both with built in wardrobes an the master bedroom benefitting from an en-suite shower room and the family bathroom. To the second floor there are two generous bedrooms.

Outside there is a fully enclosed South-West facing garden and allocated parking.







Ground Floor
Approx. 37.1 sq. metres (399.6 sq. feet)



First Floor
Approx. 37.1 sq. metres (399.6 sq. feet)

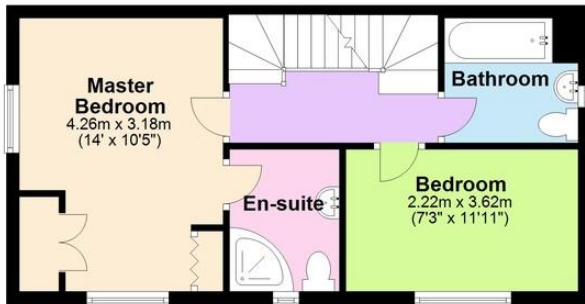

Second Floor
Approx. 37.4 sq. metres (402.6 sq. feet)

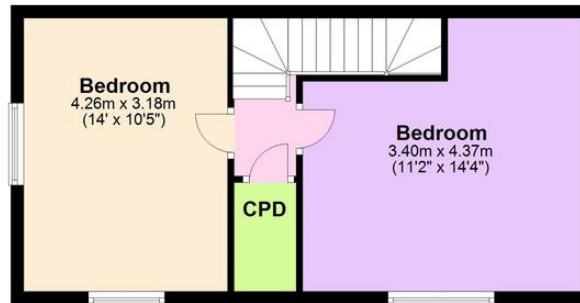

Total area: approx. 111.6 sq. metres (1201.8 sq. feet)

We 
where you
LIVE

Our team are friendly, experienced and are all local. They know it better than they do their own living rooms and can help you find what you're looking for because **we love where we live.**

We would be delighted to show you around this property.

Because every home needs a personal touch.

If you would like to view this property then please get in touch.

📞 01793 296880

✉ oldtown@mcfarlaneproperty.com

mcfarlaneproperty.com

mcfarlane
property.com

Cricklade.
102 High Street
Cricklade SN6 6AA
📞 01793 751044

Marlborough.
106 High Street
Marlborough SN8 1LT
📞 01672 514380

Old Town.
28-30 Wood Street
Swindon SN1 4AB
📞 01793 296880

Swindon.
The Village Centre,
Redhouse SN25 2FW
📞 01793 296600

Agents Note: Whilst every care has been taken to prepare these sales particulars, they are for guidance purposes only. All measurements are approximate are for general guidance purposes only and whilst every care has been taken to ensure their accuracy, they should not be relied upon and potential buyers are advised to recheck the measurements