

£1,100 pcm

Windmill Walk, Sutton, Cambridgeshire CB6 2NH



To arrange a viewing call us now on 01354 694900

Deposit £1,269

Available for immediate occupation, this three bedroom end terrace property is well presented throughout and has modern kitchen and bathroom.

The accommodation comprises spacious open plan lounge/diner, kitchen, two double bedrooms, one single bedroom and the family bathroom.

There is a fully enclosed garden to the rear.

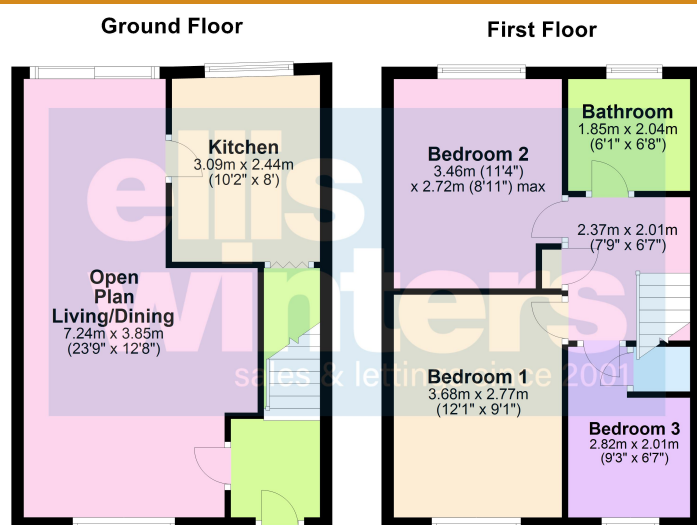

**£1,100 pcm**

Windmill Walk, Sutton, Cambridgeshire CB6 2NH



**GROUND FLOOR**

**KITCHEN**

3.09m (10'2") x 2.44m (8')

**OPEN PLAN LIVING/DINING ROOM**

7.24m (23'9") x 3.85m (12'8")

**FIRST FLOOR**

**BEDROOM 1**

3.68m (12'1") x 2.77m (9'1")

**BEDROOM 2**

3.46m (11'4") x 2.72m (8'11") max.

**BEDROOM 3**

2.82m (9'3") x 2.01m (6'7")

**BATHROOM**

2.04m (6'8") x 1.85m (6'1")



**UTILITIES**

Mains gas, electricity, water and drainage.  
The property has gas fired central heating.

**LENGTH OF TENANCY**

6 months (initially)

East Cambridgeshire District Council Tax  
band A

Energy rating - C



Ellis Winters & Co 20 Market Hill, Chatteris, Cambridgeshire, PE16 6BA  
Tel: 01354 694900 Email: [info@elliswinters.co.uk](mailto:info@elliswinters.co.uk) [www.elliswinters.co.uk](http://www.elliswinters.co.uk)