



 **2**
Bedrooms

 **1**
Bathroom



Just a short distance from Wembley Park Tube Station and offered with no further chain is this very good condition Ground Floor Two Double bedroom flat. Internally you will find a good size lounge, two double bedrooms, the family bathroom, and the family kitchen. Externally the property is set within well tendered communal gardens and just a short walk from the World-famous Wembley Stadium and its fantastic transport and shopping facilities. All in all, this would make an ideal first time or investment purchase so viewing is highly advised.

GROUND FLOOR
521 sq.ft. (48.4 sq.m.) approx.

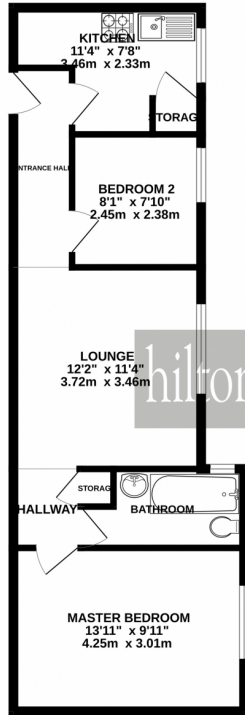

TOTAL FLOOR AREA: 521 sq.ft. (48.4 sq.m.) approx.

Whilst every attempt has been made to ensure the accuracy of the floorplan contained here, measurements of doors, windows, rooms and any other items are approximate and no responsibility is taken for any error, omission or mis-statement. This plan is for illustrative purposes only and should be used as such by any prospective purchaser. The services, systems and appliances shown have not been tested and no guarantee as to their operability or efficiency can be given.
Made with MemoPro v3.02.22





St Andrew's Church, Kingsbury

Sattavis Patidar Centre

Lycée International de Londres Winston...

Forty Willows Surgery

English Martyrs RC Church

Asda Wembley Superstore

Lidl

Barchester - Brook House Care Centre

Wembley Park

St Christopher's School

McDonald's

BOXPARK Wembley

Stadium Business Centre

Wembley International

Pavilion Court - Wembley Student...

Wembley Music Centre

The SSE Arena, Wembley

WEMBLEY PARK

UK ECIG STORE

Amazon DHA1

London Designer Outlet

Costco Wembley

St George's

Wembley Stadium