



Woodlands Road | Southall | UB1 1EF

£525,000

Hiltons Estates brings to the market this Ideally located End Terraced 3 bedroom property ideally located off Southall Broadway, UB1. The property comprises an entrance hallway 2 reception rooms, fitted kitchen with access to the private rear garden. Upstairs, there are 3 Well sized bedrooms and family bathroom. There is Opportunity to Extend and Develop (STPP). Walking distance to Southall Broadway, Places of Worship, Local amenities, shops, Schools and Crossrail. Great transport and bus links to Heathrow, Central London, M4, M25 and M40. Brilliant opportunity for Families, Commuters, Developers and INVESTORS. Good rental yield (5.71% yield). Call NOW for further details, viewings available. Highly Recommended.

- Spacious End terraced 3 bedroom property located in UB1!
- Further Opportunity to Extend and Develop (STPP)
- Brilliant opportunity for Families, Commuters, Developers and INVESTORS.
- Good rental yield (5.71% yield).



GROUND FLOOR
488 sq.ft. (45.3 sq.m.) approx.

1ST FLOOR
465 sq.ft. (43.2 sq.m.) approx.

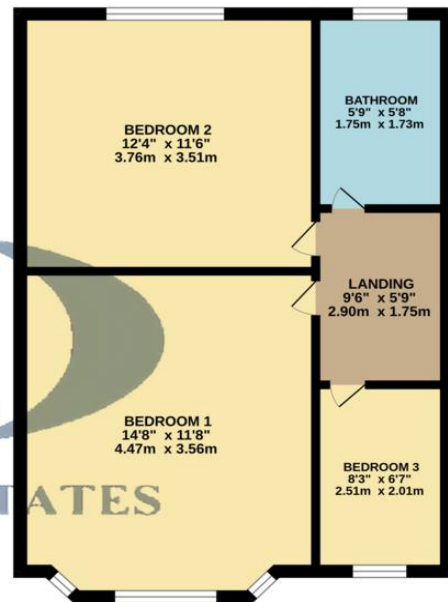
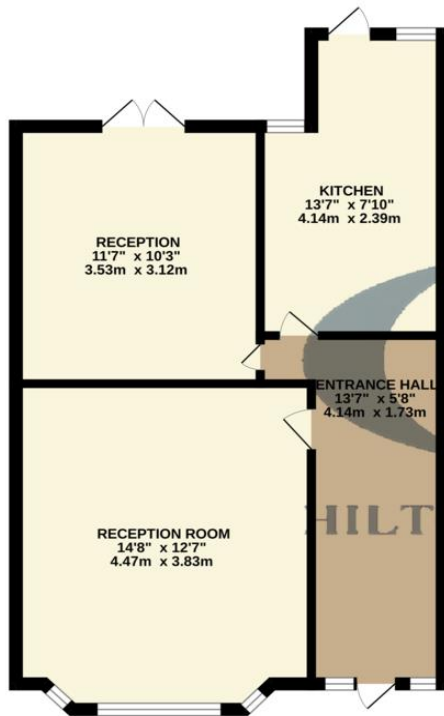

TOTAL FLOOR AREA : 953 sq.ft. (88.5 sq.m.) approx.

Whilst every attempt has been made to ensure the accuracy of the floorplan contained here, measurements of doors, windows, rooms and any other items are approximate and no responsibility is taken for any error, omission or mis-statement. This plan is for illustrative purposes only and should be used as such by any prospective purchaser. The services, systems and appliances shown have not been tested and no guarantee as to their operability or efficiency can be given.

Contact Details

137 Western Road

Southall

Middlesex

UB2 5HN

www.hiltons-estates.com

Harvin@hiltons-estates.com

02088679555

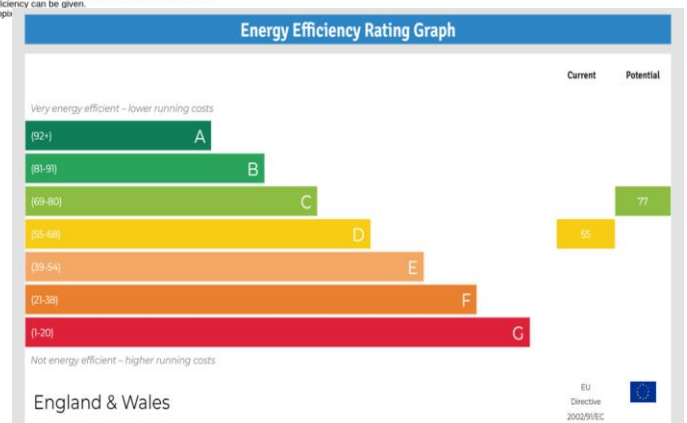

Agents Note: Whilst every care has been taken to prepare these sales particulars, they are for guidance purposes only. All measurements are approximate are for general guidance purposes only and whilst every care has been taken to ensure their accuracy, they should not be relied upon and potential buyers are advised to recheck the measurements