



Middleton Road, SM4 6RR

£415,000 FH

* End of terrace two bedroom town house with garage and front drive





Middleton Road, SM4 6RR

Ground Floor

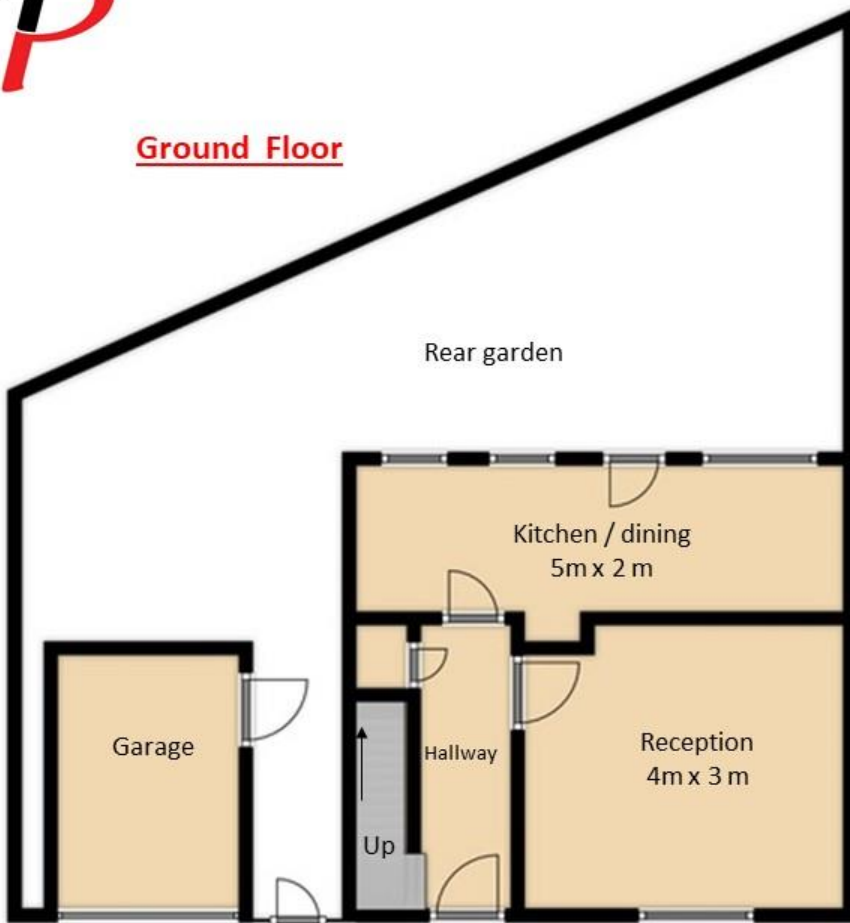

First Floor



Whilst every attempt has been made to ensure the accuracy of the floor plan contained here, measurements of doors, windows, rooms and any other items are approximate and no responsibility is taken for any error omissions or mis-statement. This Plan is for illustrate purpose only and should be used as such by any prospective purchaser. The services, systems and appliances shown have not been tested and no guarantee as to their operability or efficiency can be given.

Approx. 68
Square Meters

Score	Energy rating	Current	Potential
92+	A		
81-91	B		84 B
69-80	C		
55-68	D	68 D	
39-54	E		
21-38	F		
1-20	G		