



 1
Bedroom

 1
Bathroom



Located within this popular warden-controlled building which is a short distance from Harrow High Street is this one bedroom first floor flat. Internally the property is presented in good condition with a large 5m lounge/diner, double bedroom with fitted mirrored wardrobes, kitchen and upgraded bathroom. Externally you will find that the property is set within well tended communal gardens and has ample parking for guests. Within the building you will find two communal lounges, lift to all floors, communal laundry room and guest's suite which can be rented over night for visitors. All in all, this is one that should not be missed and a viewing is highly advised.

Ground Rent: £510pa

Service Charge: £3600pa

Lease Remaining: 92 years

Council Tax Band: D

57a High Street, Harrow, Middlesex, HA3 5DQ |
wembley@hiltonandfox.com

02084260631

FIRST FLOOR
428 sq.ft. (39.7 sq.m.) approx.

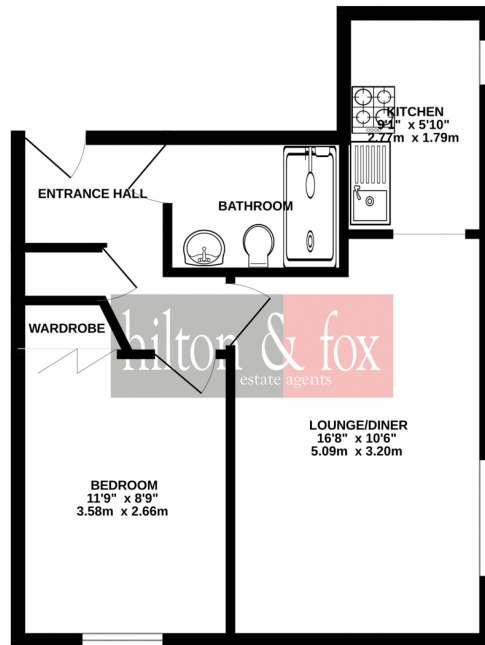

TOTAL FLOOR AREA: 428 sq.ft. (39.7 sq.m.) approx.

Whilst every attempt has been made to ensure the accuracy of the floorplan contained here, measurements of doors, windows, rooms and any other items are approximate and no responsibility is taken for any error, omission or mis-statement. This plan is for illustrative purposes only and should be used as such by any prospective purchaser. The services, systems and appliances shown have not been tested and no guarantee as to their operability or efficiency can be given.
Made with Metronix v10/2/22

Energy Efficiency Rating

	Current	Potential
Very energy efficient - lower running costs		
(92+) A		
(81-91) B		81
(69-80) C	74	
(55-68) D		
(39-54) E		
(21-38) F		
(1-20) G		
Not energy efficient - higher running costs		
England, Scotland & Wales		EU Directive 2002/91/EC

Address: Brandreth Court, Sheepcote Road, Harrow, Middlesex H





Tesco Superstore

Rumble Tumble Harrow

3D Motors

Travelodge
London Harrow

St George's
Shopping Centre

McDonald's

Bright Little
Stars Nursery

Powerleague Harrow

Harrow High School

Harrow-on-the-Hill
(HOH)

Harrow
College

Our Lady & St Thomas
of Canterbury Church

University Of
Westminster,
Harrow
Campus

Northwick Park Hospital

Premier Inn
London Harrow

Kenton

Northwick Park

Recreation
Ground