

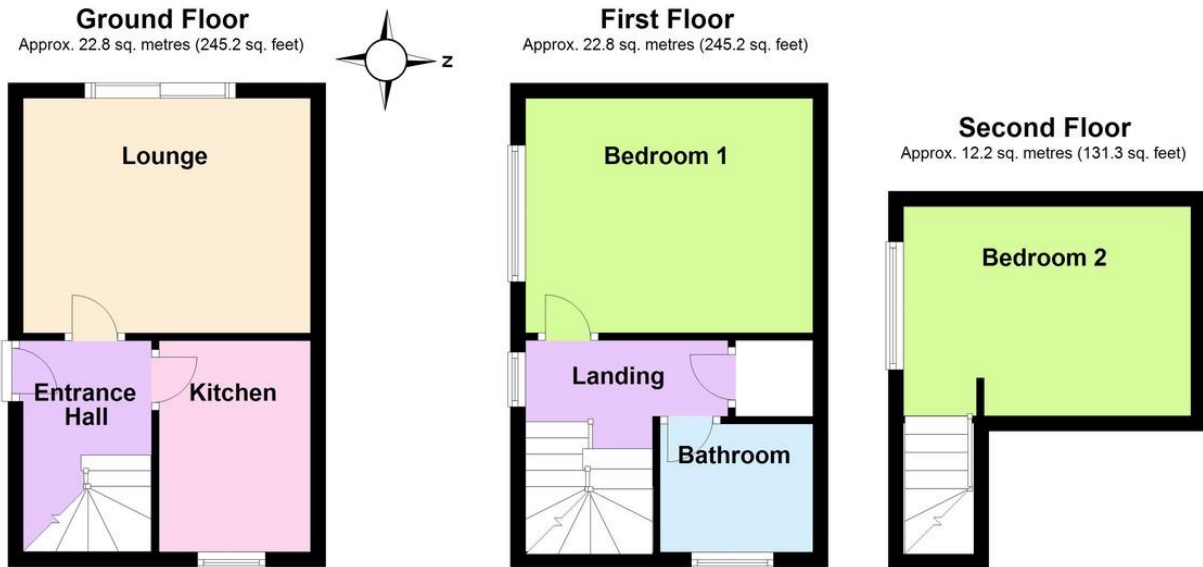

- End of Terrace House
- 2 Bedrooms
- Private Off Road Parking
- Gas Central Heating
- Large Garden
- Available Immediately
- Adjacent to Recreation Ground
- Council Tax Band 'B'
- EPC Rating: - 'C'

72 Conbar Avenue, Rustington BN16 3LY  
**£1,200 pcm**





Total area: approx. 57.8 sq. metres (621.7 sq. feet)

**AVAILABLE IMMEDIATELY** - 2 bedroom end of terrace house in Rustington with private parking and large rear garden. Gas central heating, pets considered with a £20 pcm Pet Premium.

**ENTRANCE HALL**

**LOUNGE**  
12' 5" x 10' 2" (3.78m x 3.1m)

**KITCHEN**  
9' 1" x 6' 8" (2.77m x 2.03m)

**BEDROOM 1**  
12' 5" x 10' 2" (3.78m x 3.1m)

**BEDROOM 2**  
12' 5" x 9' 1" (3.78m x 2.77m)

**BATHROOM/WC**

**OFF ROAD PARKING SPACE**

**LARGE REAR GARDEN**

The information and measurements contained within these details are for guidance only and do not form part of any contract.

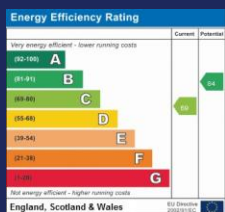

**90 THE STREET, RUSTINGTON, WEST SUSSEX, BN16 3NJ**

**lettings@hawkemetcalf.co.uk**

**www.hawkemetcalf.co.uk**

**01903 850450**