

GUIDE PRICE  
**Altura Tower, Bridges Wharf**  
London, SW11 3GX

## PROPERTY SUMMARY

\* Video Viewings & Physical viewings available \*. A stunning twelfth floor one bedroom apartment with far reaching river views, parking and air conditioning in this award winning riverside Development. Offering 705 sq ft of accommodation comprising a spacious open plan reception room/kitchen, generous bedroom, bathroom and winter garden. Two secure underground parking spaces are included in the sale.





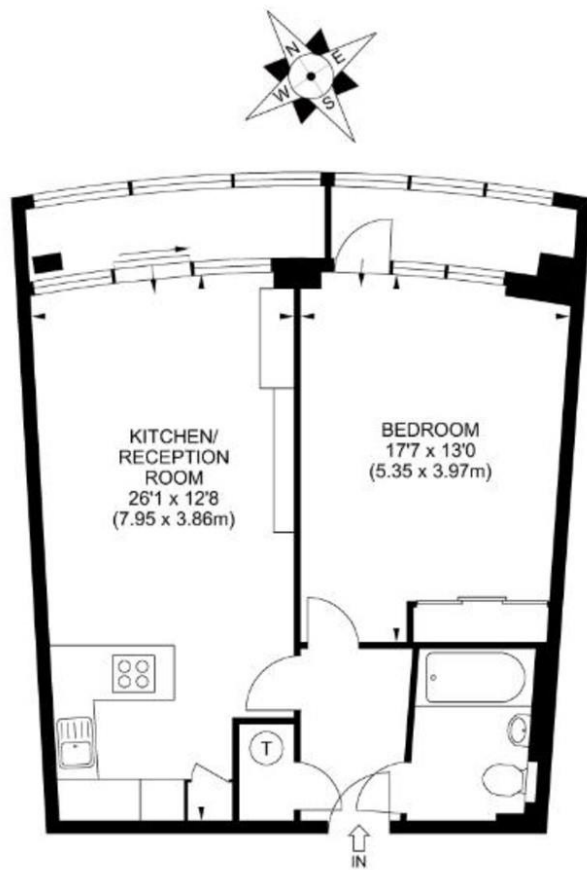

TWELFTH FLOOR

APPROX GROSS INTERNAL FLOOR AREA 705 SQFT / 65.5 SQM

All measurements are maximum, and includes wardrobes and window bays where applicable  
 Prepared by Pixangle © . Tel 020 8870 2118 www.pixangle.com

**LOCAL AUTHORITY**

Wandsworth Borough Council

**TENURE**

Leasehold

**COUNCIL TAX BAND**

Band E

**VIEWINGS**

By prior appointment only

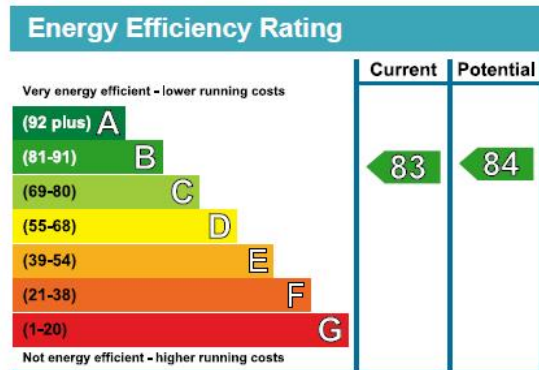

Agents Note: Whilst every care has been taken to prepare these particulars, they are for guidance purposes only. All measurements are approximate and are for general guidance purposes only and whilst every care has been taken to ensure their accuracy, they should not be relied upon and potential buyers/tenants are advised to recheck the measurements



4 Vicentia Court  
 Bridges Wharf  
 London  
 SW11 3GY

02073522455  
 info@hgproperty.co.uk  
 www.hgproperty.co.uk