

Altura Tower, Bridges Wharf
Battersea, SW11 3GZ

PROPERTY SUMMARY

A twelfth floor apartment boasting far reaching river views. Benefits include air conditioning, winter garden, 24 hour concierge service and convenient location close to Clapham Junction mainline station. Parking may be available on separate negotiation.





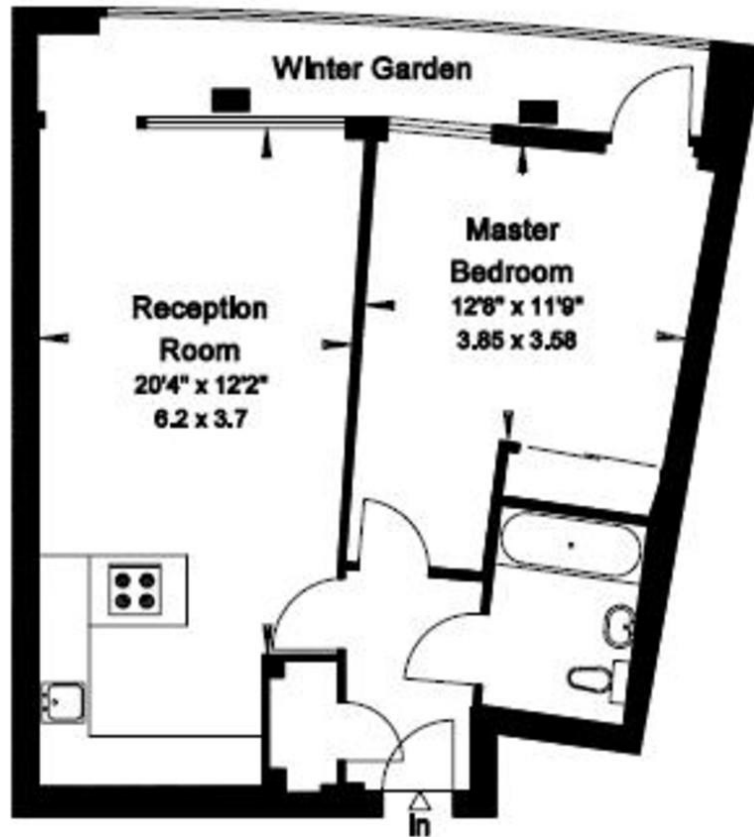

Twelfth Floor
Gross Internal Area = 65 sq. metres
707 sq. feet

LOCAL AUTHORITY
 Wandsworth Borough Council

TENURE
 Leasehold

COUNCIL TAX BAND
 Band E

VIEWINGS
 By prior appointment only

Energy Efficiency Rating		
	Current	Potential
Very energy efficient - lower running costs		
(92-100) A		
(81-91) B	81	84
(69-80) C		
(55-68) D		
(39-54) E		
(21-38) F		
(1-20) G		
Not energy efficient - higher running costs		
England, Scotland & Wales		EU Directive 2002/91/EC

Agents Note: Whilst every care has been taken to prepare these particulars, they are for guidance purposes only. All measurements are approximate and are for general guidance purposes only and whilst every care has been taken to ensure their accuracy, they should not be relied upon and potential buyers/tenants are advised to recheck the measurements



4 Vicentia Court
 Bridges Wharf
 London
 SW11 3GY

02073522455
 info@hgproperty.co.uk
 www.hgproperty.co.uk