



Commodore House, Battersea Reach
Wandsworth, SW18 1TZ

PROPERTY SUMMARY

A great two/three-bedroom apartment with excellent river views. The apartment benefits from a larger than average principle bedroom with en-suite double shower, built-in wardrobes and superb views. The second double bedroom also has built-in mirrored wardrobes and the corridor features two large cupboards, one serving as an airing cupboard with the hot water tank and washer/dryer, the other purely a storage facility, large enough to accommodate sports goods, suitcases and a bicycle if needed. The third bedroom is fairly versatile, often used as a study or occasional bedroom.





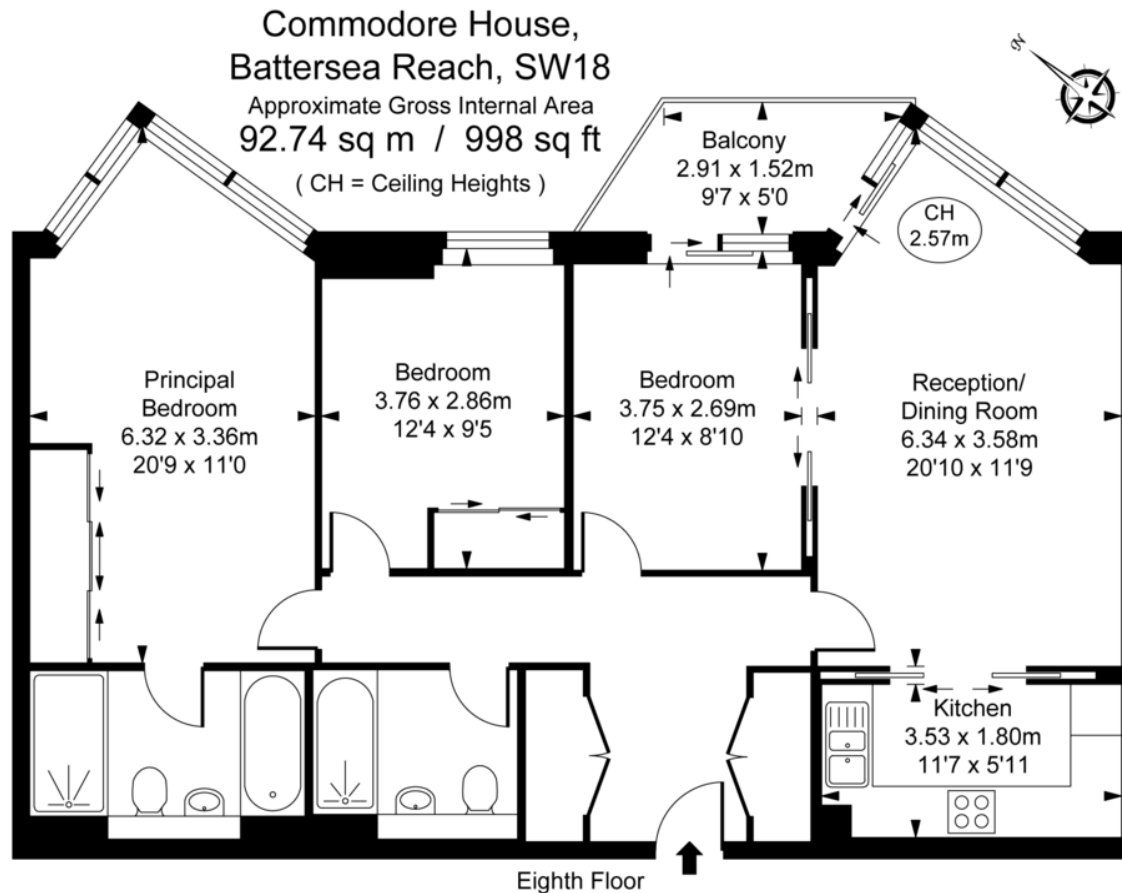

This plan is not to scale. It is for guidance and not for valuation purposes.
All measurements and areas are approximate only, and have been prepared in accordance with the current edition of the RICS Code of Measuring Practice.
© Fulham Performance

LOCAL AUTHORITY

Wandsworth Borough Council

TENURE

Leasehold

COUNCIL TAX BAND

Band G

VIEWINGS

By prior appointment only

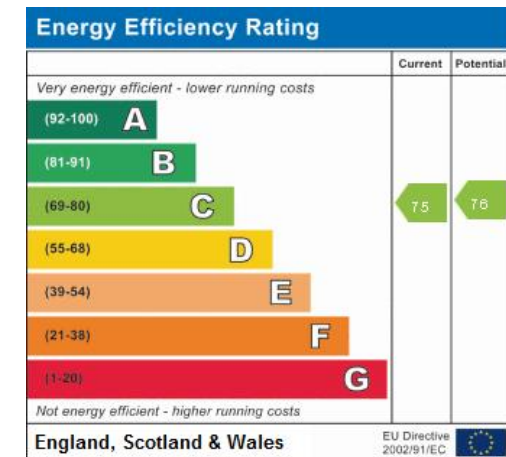

Agents Note: Whilst every care has been taken to prepare these particulars, they are for guidance purposes only. All measurements are approximate and are for general guidance purposes only and whilst every care has been taken to ensure their accuracy, they should not be relied upon and potential buyers/tenants are advised to recheck the measurements



4 Vicentia Court
Bridges Wharf
London
SW11 3GY

02073522455
info@hgproperty.co.uk
www.hgproperty.co.uk