

Altura Tower, Bridges Wharf

Battersea, SW11 3GZ

PROPERTY SUMMARY

A twelfth floor apartment boasting far reaching river views. Benefits include air conditioning, parking for one car, winter garden, 24 hour concierge service and convenient location close to Clapham Junction mainline station.





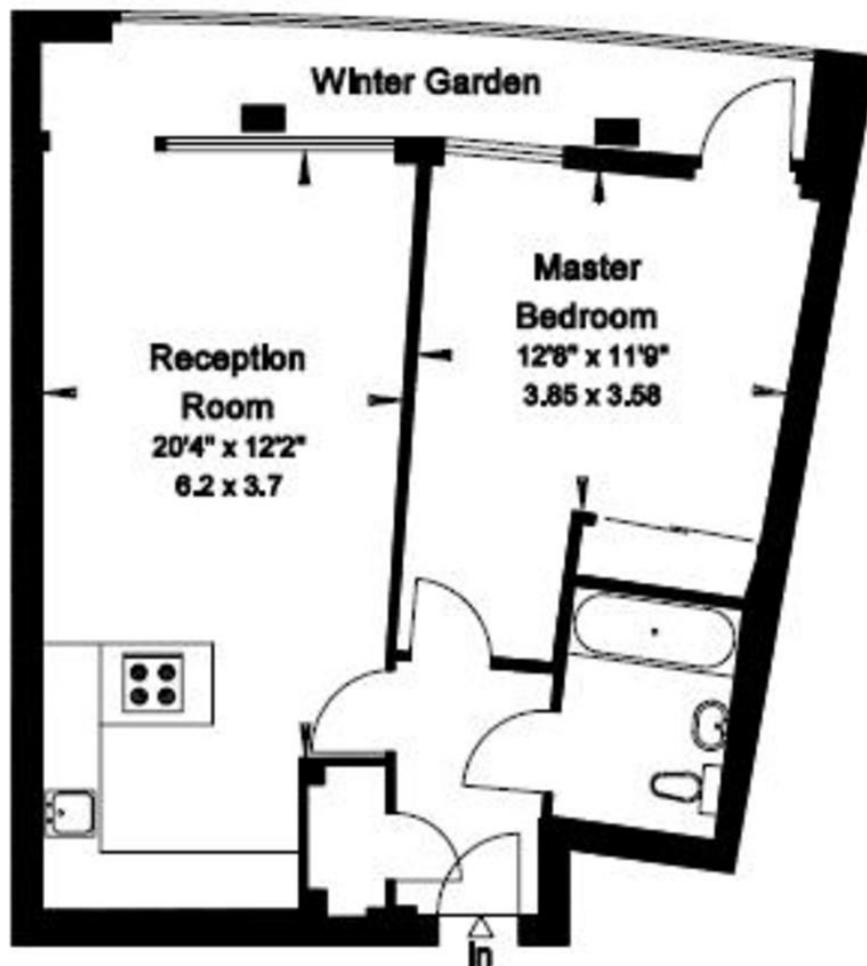

Twelfth Floor
Gross Internal Area = 65 sq. metres
707 sq. feet

LOCAL AUTHORITY

Wandsworth Borough Council

TENURE

Leasehold

COUNCIL TAX BAND

Band E

VIEWINGS

By prior appointment only

Energy Efficiency Rating

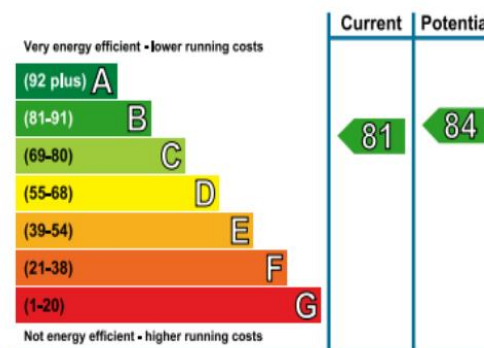

Agents Note: Whilst every care has been taken to prepare these particulars, they are for guidance purposes only. All measurements are approximate and are for general guidance purposes only and whilst every care has been taken to ensure their accuracy, they should not be relied upon and potential buyers/tenants are advised to recheck the measurements



London
 SW11 3GY

info@hgproperty.co.uk
www.hgproperty.co.uk