



2 Bedroom Flat £1,100

Flat 3, The Gallery, Back Lane, Ramsbury, Wiltshire, SN8 2QH

mcfarlane
property.com

2 Bedroom Flat

Wiltshire, Ramsbury

-
- Character Apartment in Ramsbury
 - Quiet Location
 - Allocated Parking Space
 - Maintained Communal Garden
-

A beautifully presented two bedroom first floor apartment located in a converted school building in the pretty village of Ramsbury.

This character apartment has its own ground floor entrance leading upstairs to the hallway. The modern kitchen is fitted with an electric hob, single oven, fridge, washing machine and dishwasher. There is a good size living room, large bathroom with bath and over bath shower, double bedroom and a single bedroom.

This property overlooks the lovely maintained communal gardens and has an allocated parking space.

Holding Deposit: £253.84

Deposit: £1,269.23

Initial Term: 12 Months

Council Tax Band: C

EPC Rating: C



First Floor Flat

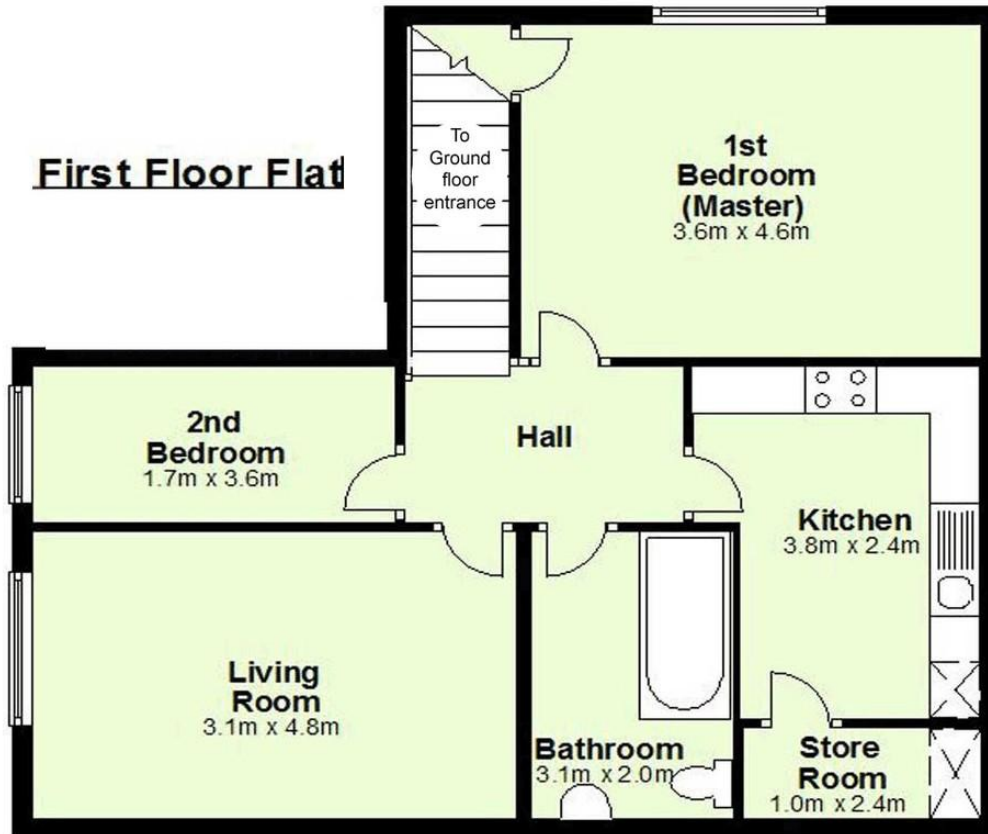

We 
where you
LIVE

Our team are friendly, experienced and are all local. They know it better than they do their own living rooms and can help you find what you're looking for because **we love where we live.**

We would be delighted to show you around this property.

**Because every home
needs a personal touch.**

**If you would like to view this
property then please get in touch.**

☎ 01793 611841

✉ lettings@mcfarlaneproperty.com

mcfarlaneproperty.com

mcfarlane
property.com

Cricklade.

102 High Street
Cricklade SN6 6AA

☎ 01793 751044

Marlborough.

106 High Street
Marlborough SN8 1LT

☎ 01672 514380

Old Town.

28-30 Wood Street
Swindon SN1 4AB

☎ 01793 296880

Swindon.

The Village Centre,
Redhouse SN25 2FW

☎ 01793 296600

Agents Note: Whilst every care has been taken to prepare these sales particulars, they are for guidance purposes only. All measurements are approximate and are for general guidance purposes only and whilst every care has been taken to ensure their accuracy, they should not be relied upon and potential buyers are advised to recheck the measurements