



16 Grove Park Terrace, Harrogate

Harrogate

Guide Price £245,000



MYRINGS

Harrogate's Family Estate Agent



16 Grove Park Terrace

Harrogate, Harrogate

NO CHAIN - TOWN CENTRE 10 MINUTES WALK -
EXCELLENT PROPORTIONS THROUGHOUT - SOUTH
FACING REAR GARDEN - DINING KITCHEN -
SEPARATE UTILITY ROOM - 2 DOUBLE BEDROOMS
Council Tax band: B

Tenure: Freehold

- EXCELLENT PROPORTIONS THROUGHOUT
- 2 DOUBLE BEDROOMS
- SOUTH FACING FLAGGED GARDEN TO THE REAR
- DINING KITCHEN
- SEPARATE UTILITY ROOM
- TOWN CENTRE 10 MINUTES WALK
- NO CHAIN



MYRINGS



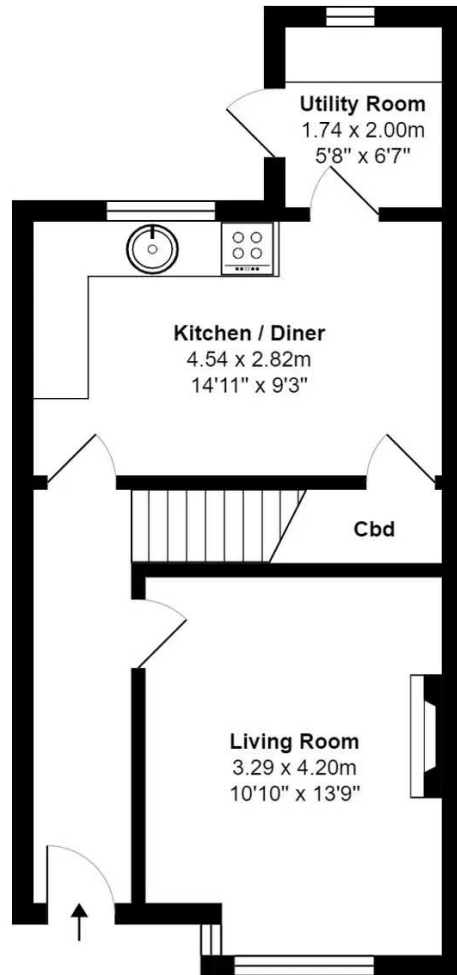

Ground Floor
 Area: 39.5 m² ... 426 ft²

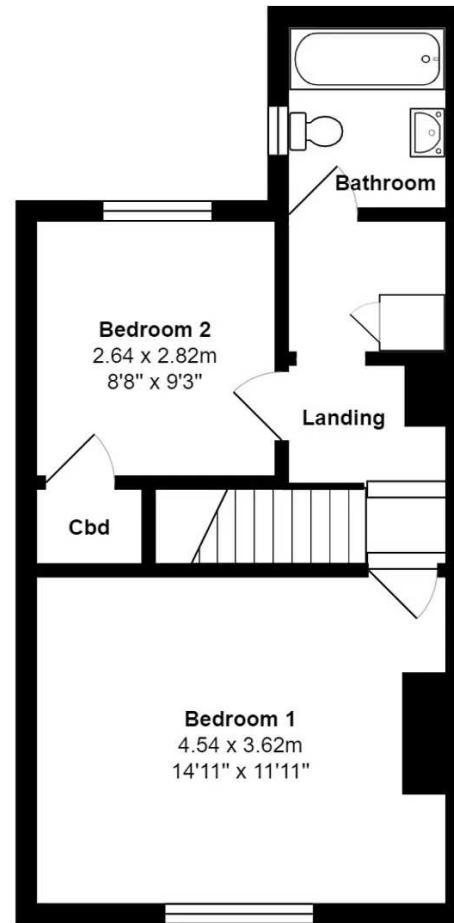

First Floor
 Area: 38.1 m² ... 410 ft²



Total Area: 77.7 m² ... 836 ft²

All measurements are approximate and for display purposes only.





Myrings Estate Agents

Myrings Estate Agents Ltd, 10 Princes Square - HG1 1LX

01423
566400

• enquiries@myringsestateagents.com • <http://myringsestateagents.com/>

