



See More Online

KFB: Key Facts For Buyers

A Guide to This Property & the Local Area

Tuesday 21st November 2023

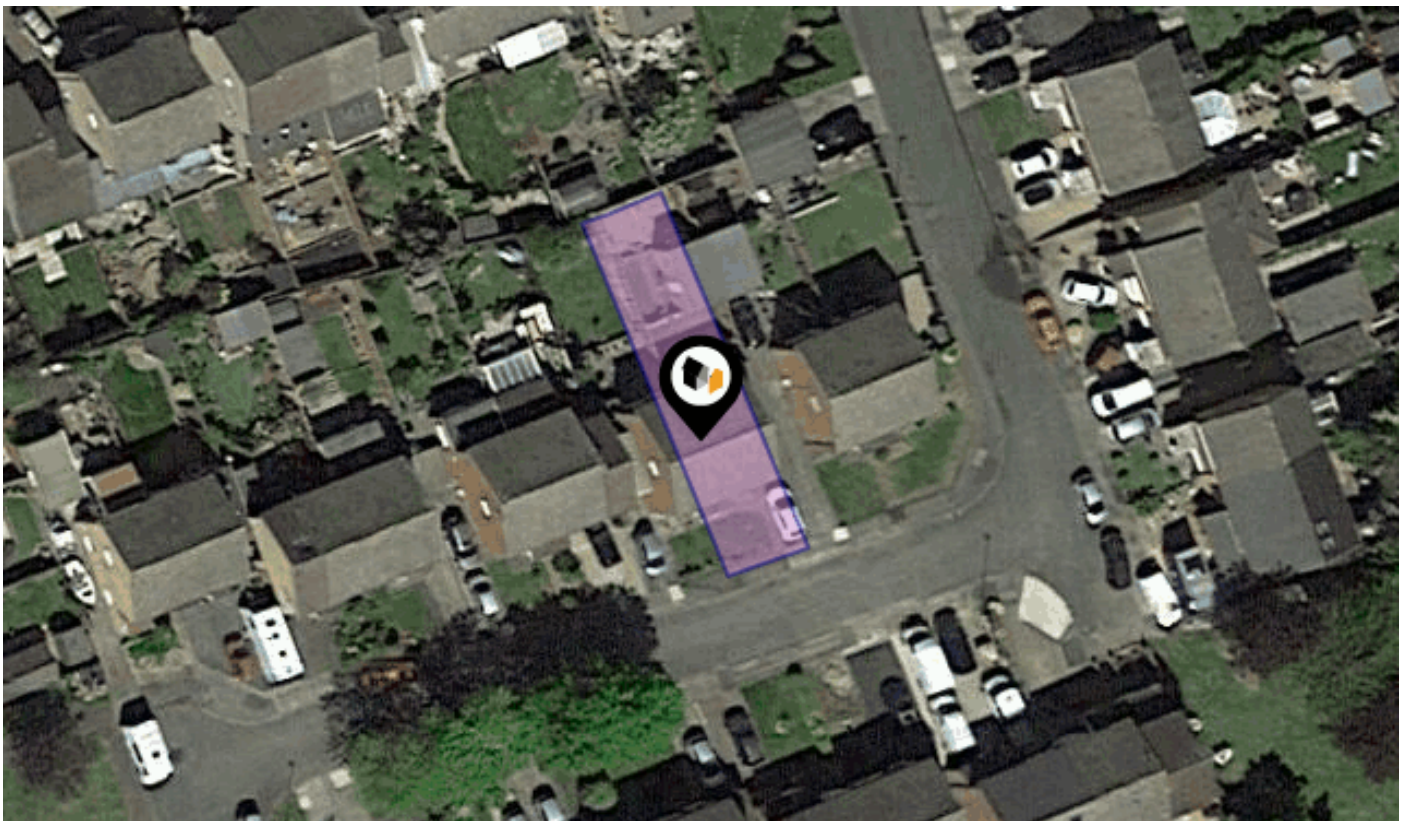

BLACKMORE CLOSE, GUISBOROUGH, TS14

Martin & Co Guisborough

83 Westgate Guisborough North Yorkshire TS14 6AF

01287 631254

guisborough@martinco.com

www.martinco.com/estate-agents-and-letting-agents/branch/guisborough/



Thank you for downloading our Key Facts for Buyers report. We hope that the information it contains within is both useful and informative for you.

Should you have any questions or would like to arrange a viewing please contact our office on 01287 631254. We look forward to hearing from you!

NEED A MORTGAGE?

Why be restricted to your current or high street lenders rates? Especially when Martin & Co can introduce you to our Mortgage Advisor with access to a comprehensive panel of over 80 lenders, including a range of off market products, offering potential savings against your current lender. Call today to arrange a ten minute (no obligation) telephone consultation (at a time to suit you). One quick call could potentially save you thousands of pounds over the course of your mortgage. Please remember, your home is at risk if you do not keep up with your mortgage repayments.



Property

Type:	Semi-Detached
Bedrooms:	2
Floor Area:	710 ft ² / 66 m ²
Plot Area:	0.05 acres
Year Built :	1967-1975
Council Tax :	Band B
Annual Estimate:	£1,643
Title Number:	CE15487
UPRN:	100110036967

Last Sold £/ft²:	£149
Tenure:	Freehold

Local Area

Local Authority:	Redcar And Cleveland
Conservation Area:	No
Flood Risk:	
• Rivers & Seas	Very Low
• Surface Water	Very Low

Estimated Broadband Speeds (Standard - Superfast - Ultrafast)

7 mb/s	69 mb/s	1000 mb/s

Mobile Coverage: (based on calls indoors)



Satellite/Fibre TV Availability:







BLACKMORE CLOSE, GUISBOROUGH, TS14



BLACKMORE CLOSE, GUISBOROUGH, TS14

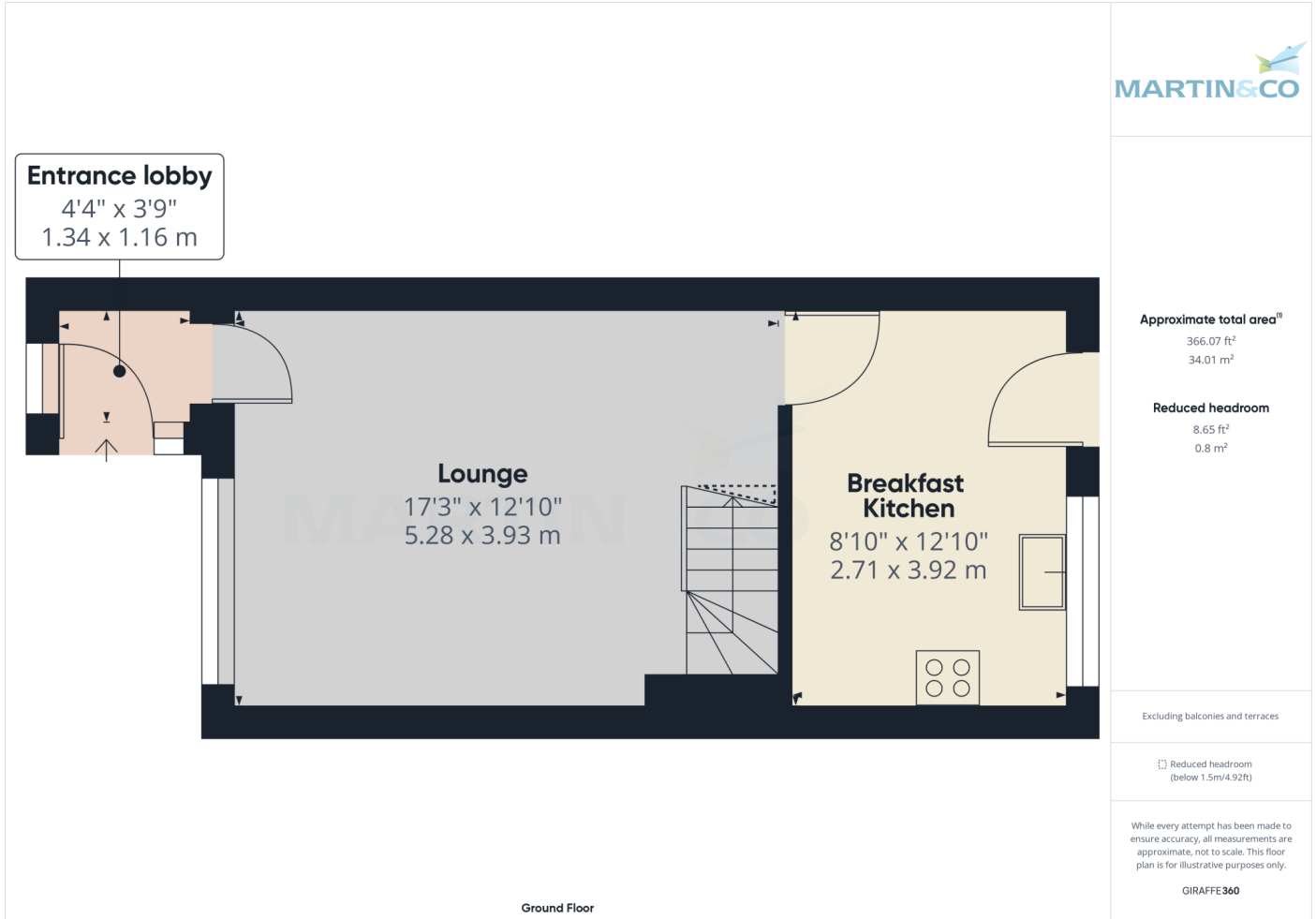

BLACKMORE CLOSE, GUISBOROUGH, TS14

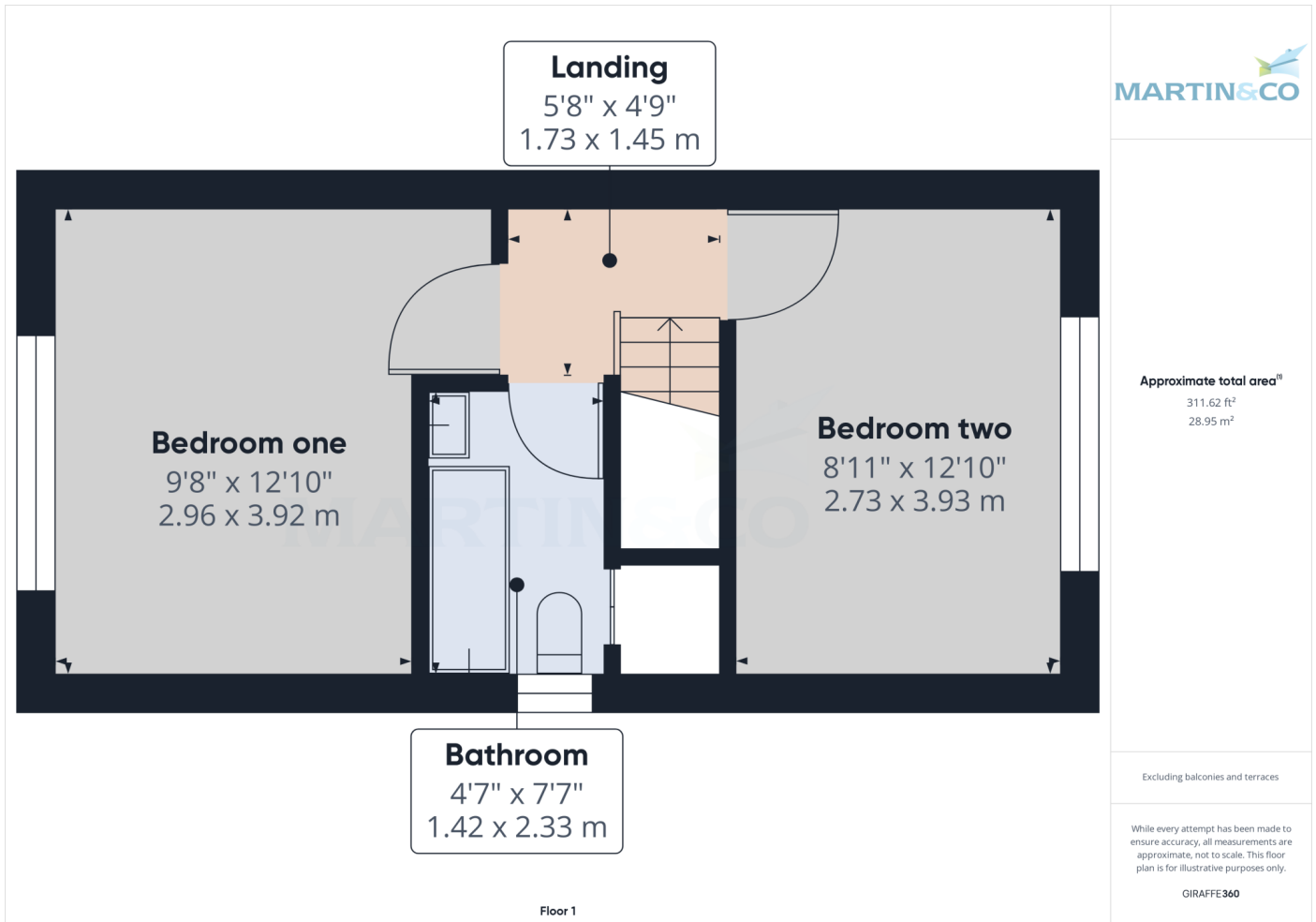

Blackmore Close, TS14

Energy rating

C

Valid until 19.09.2027

Score	Energy rating	Current	Potential
92+	A		
81-91	B		83 B
69-80	C	69 c	
55-68	D		
39-54	E		
21-38	F		
1-20	G		

Additional EPC Data

Property Type:	House
Build Form:	Semi-Detached
Transaction Type:	Marketed sale
Energy Tariff:	Single
Main Fuel:	Mains gas (not community)
Main Gas:	Yes
Flat Top Storey:	No
Top Storey:	0
Glazing Type:	Double glazing, unknown install date
Previous Extension:	1
Open Fireplace:	0
Ventilation:	Natural
Walls:	Cavity wall, filled cavity
Walls Energy:	Good
Roof:	Pitched, limited insulation (assumed)
Roof Energy:	Very Poor
Main Heating:	Boiler and radiators, mains gas
Main Heating Controls:	Programmer, room thermostat and TRVs
Hot Water System:	From main system
Hot Water Energy Efficiency:	Good
Lighting:	Low energy lighting in all fixed outlets
Floors:	Solid, no insulation (assumed)
Total Floor Area:	66 m ²

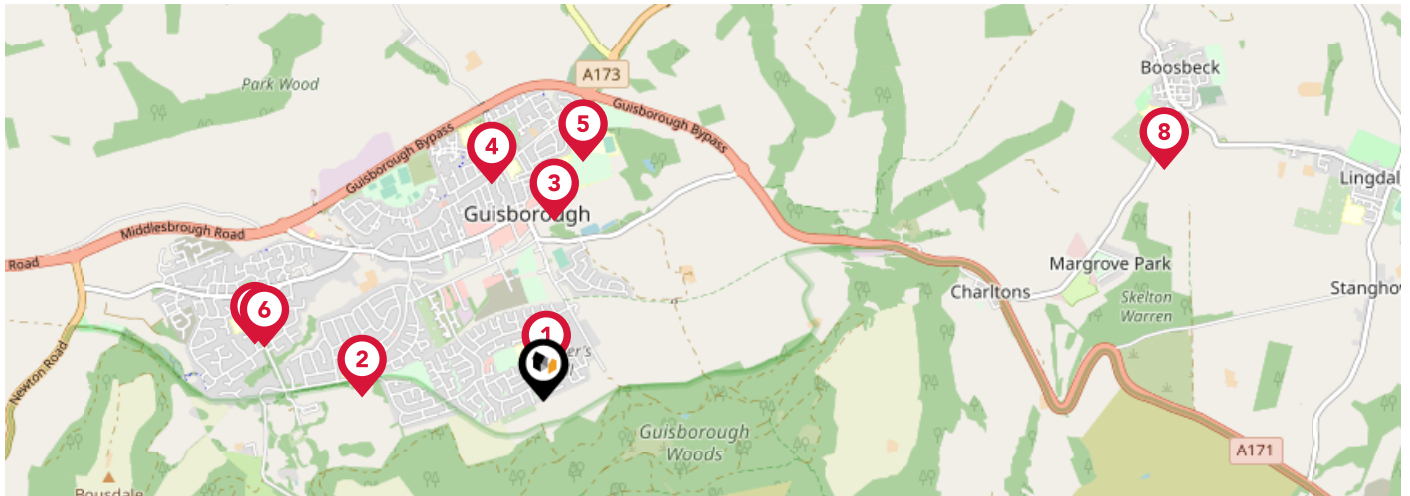

		Nursery	Primary	Secondary	College	Private
Belmont Primary School Ofsted Rating: Good Pupils: 389 Distance:0.12	<input type="checkbox"/>	<input checked="" type="checkbox"/>	<input type="checkbox"/>	<input type="checkbox"/>	<input type="checkbox"/>	
Highcliffe Primary School Ofsted Rating: Good Pupils: 395 Distance:0.78	<input type="checkbox"/>	<input checked="" type="checkbox"/>	<input type="checkbox"/>	<input type="checkbox"/>	<input type="checkbox"/>	
Prior Pursglove and Stockton Sixth Form College Ofsted Rating: Good Pupils:0 Distance:0.78	<input type="checkbox"/>	<input type="checkbox"/>	<input checked="" type="checkbox"/>	<input type="checkbox"/>	<input type="checkbox"/>	
Chaloner Primary School Ofsted Rating: Good Pupils: 244 Distance:0.96	<input type="checkbox"/>	<input checked="" type="checkbox"/>	<input type="checkbox"/>	<input type="checkbox"/>	<input type="checkbox"/>	
Laurence Jackson School Ofsted Rating: Inadequate Pupils:0 Distance:1.05	<input type="checkbox"/>	<input type="checkbox"/>	<input checked="" type="checkbox"/>	<input type="checkbox"/>	<input type="checkbox"/>	
Galley Hill Primary School Ofsted Rating: Good Pupils: 265 Distance:1.22	<input type="checkbox"/>	<input checked="" type="checkbox"/>	<input type="checkbox"/>	<input type="checkbox"/>	<input type="checkbox"/>	
Saint Paulinus Catholic Primary School, A Catholic Voluntary Academy Ofsted Rating: Good Pupils: 231 Distance:1.26	<input type="checkbox"/>	<input checked="" type="checkbox"/>	<input type="checkbox"/>	<input type="checkbox"/>	<input type="checkbox"/>	
Lockwood Primary School Ofsted Rating: Good Pupils: 203 Distance:2.85	<input type="checkbox"/>	<input checked="" type="checkbox"/>	<input type="checkbox"/>	<input type="checkbox"/>	<input type="checkbox"/>	

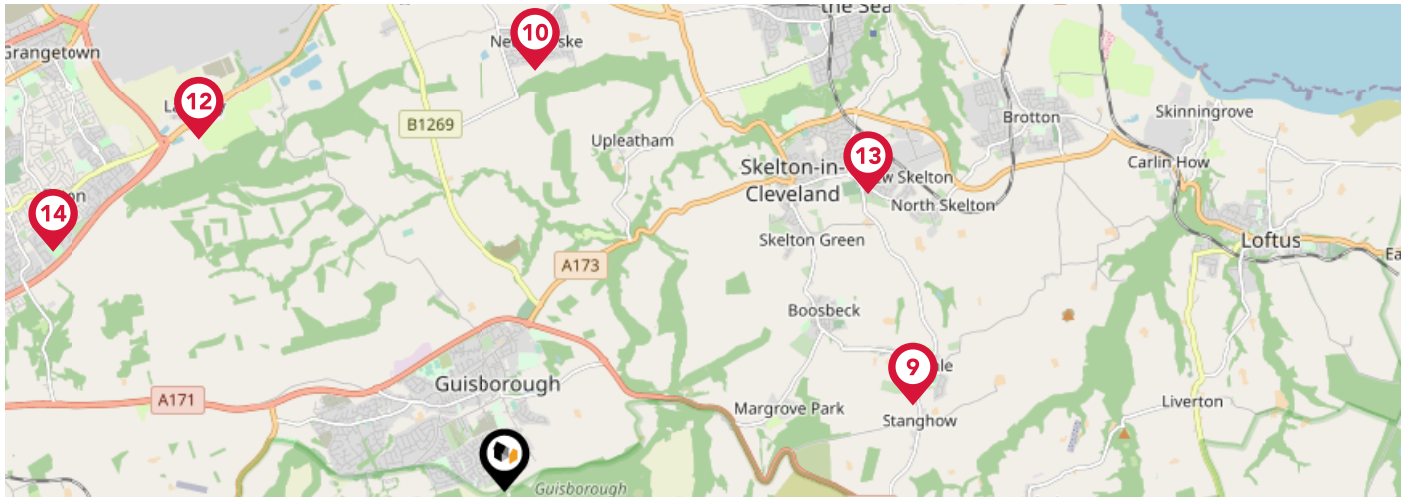

		Nursery	Primary	Secondary	College	Private
	Lingdale Primary School Ofsted Rating: Requires Improvement Pupils: 101 Distance:3.59	<input type="checkbox"/>	<input checked="" type="checkbox"/>	<input type="checkbox"/>	<input type="checkbox"/>	<input type="checkbox"/>
	New Marske Primary School Ofsted Rating: Good Pupils: 261 Distance:3.64	<input type="checkbox"/>	<input checked="" type="checkbox"/>	<input type="checkbox"/>	<input type="checkbox"/>	<input type="checkbox"/>
	Roseberry Academy Ofsted Rating: Good Pupils: 229 Distance:3.84	<input type="checkbox"/>	<input checked="" type="checkbox"/>	<input type="checkbox"/>	<input type="checkbox"/>	<input type="checkbox"/>
	Wilton Primary Academy Ofsted Rating: Good Pupils: 58 Distance:4.02	<input type="checkbox"/>	<input checked="" type="checkbox"/>	<input type="checkbox"/>	<input type="checkbox"/>	<input type="checkbox"/>
	Skelton Primary School Ofsted Rating: Good Pupils: 559 Distance:4.05	<input type="checkbox"/>	<input checked="" type="checkbox"/>	<input type="checkbox"/>	<input type="checkbox"/>	<input type="checkbox"/>
	Bankfields Primary School Ofsted Rating: Good Pupils: 312 Distance:4.41	<input type="checkbox"/>	<input checked="" type="checkbox"/>	<input type="checkbox"/>	<input type="checkbox"/>	<input type="checkbox"/>
	Kirkleatham Hall School Ofsted Rating: Good Pupils: 155 Distance:4.47	<input type="checkbox"/>	<input checked="" type="checkbox"/>	<input checked="" type="checkbox"/>	<input type="checkbox"/>	<input type="checkbox"/>
	Marwood Church of England Voluntary Controlled Infant School, Great Ayton Ofsted Rating: Good Pupils: 65 Distance:4.54	<input type="checkbox"/>	<input checked="" type="checkbox"/>	<input type="checkbox"/>	<input type="checkbox"/>	<input type="checkbox"/>

Area

Transport (National)

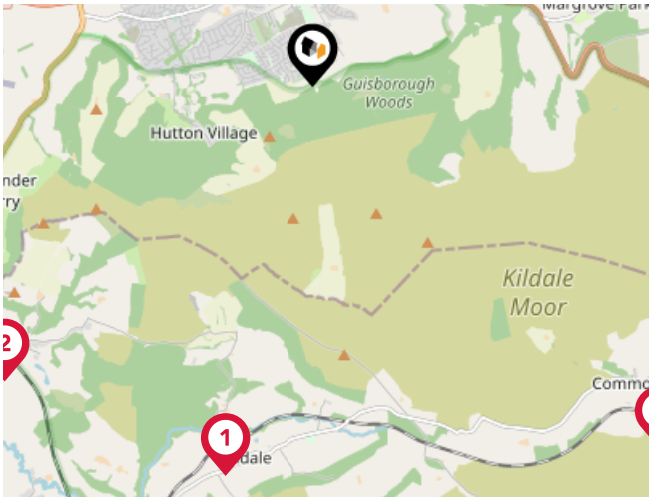

National Rail Stations

Pin	Name	Distance
1	Kildale Rail Station	3.43 miles
2	Great Ayton Rail Station	3.66 miles
3	Comondale Rail Station	4.31 miles

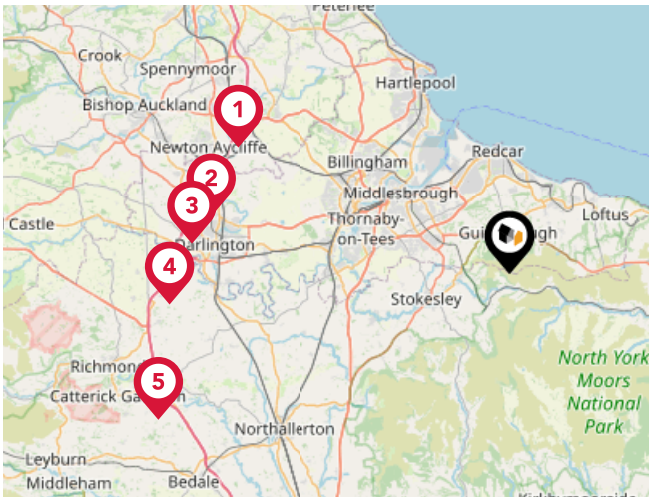

Trunk Roads/Motorways

Pin	Name	Distance
1	A1(M) J60	20.49 miles
2	A1(M) J59	20.91 miles
3	A1(M) J58	21.96 miles
4	A1(M) J57	23.42 miles
5	A1(M) J52	26.26 miles



Airports/Helipads



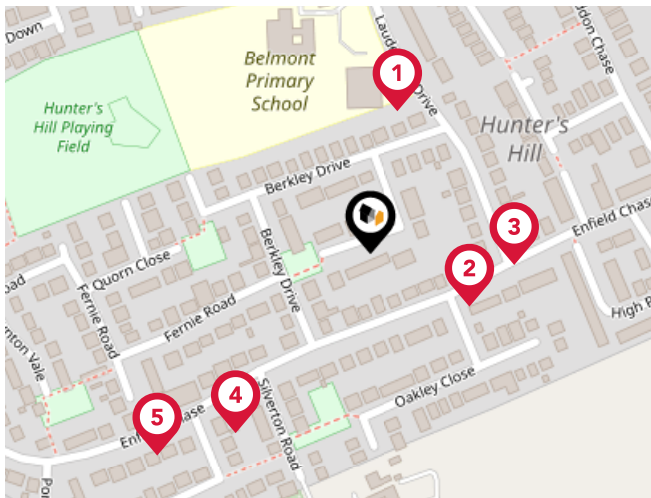

Pin	Name	Distance
1	Durham Tees Valley Airport	15.44 miles
2	Newcastle International Airport	44.08 miles
3	Leeds Bradford International Airport	51.75 miles
4	Humberside Airport	71.17 miles

Area

Transport (Local)



Bus Stops/Stations

Pin	Name	Distance
	Belmont Primary School	0.08 miles
	Oakley Close	0.06 miles
	Oakley Close	0.08 miles
	Bucleuch Close	0.12 miles
	Bucleuch Close	0.16 miles

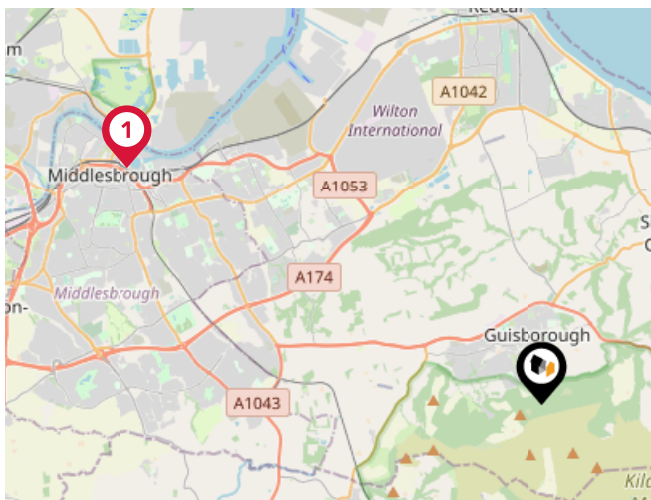

Ferry Terminals

Pin	Name	Distance
	Transporter Bridge North Side	8.22 miles

10 Year History of Average House Prices by Property Type in TS14

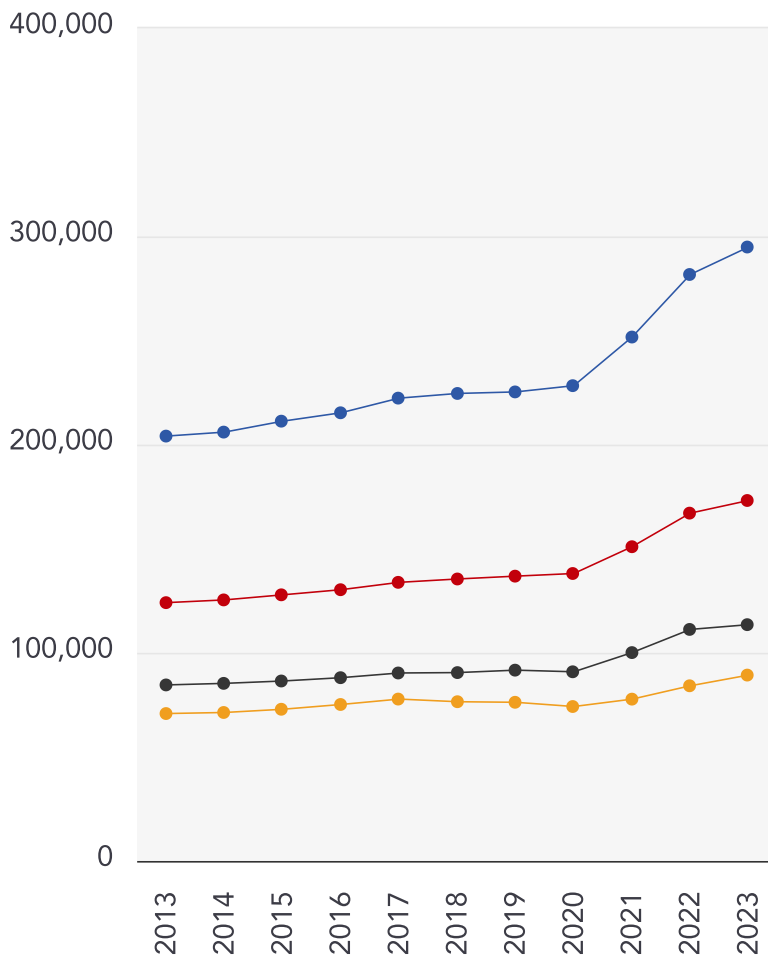

Detached

+44.5%

Semi-Detached

+39.54%

Terraced

+34.24%

Flat

+26.09%



Martin & Co Guisborough

Martin & Co Guisborough is perfectly located, with a prime high street shop front. We have a large network of offices throughout the UK. We believe in delivering a high quality service to all our clients and continually invest in the latest technology, ideas and people to ensure we deliver the best possible outcome for our clients.

We believe that a reputation is maintained by hard work and honesty. A substantial amount of our business is generated from personal recommendations; we recognise how imperative it is to uphold our high standards in order to meet our clients' satisfaction. We would be delighted to provide you with free sales or lettings advice, without obligation, and welcome your call.

Financial Services

Need a Mortgage?

Why be restricted to your current or high street lenders rates?

Especially when Martin & Co can introduce you to our Mortgage Advisor with access to whole of market mortgages (including a range of selected off market products), offering potential savings against your current lender.

Please call today to arrange a ten-minute (no obligation, or cost) telephone consultation (at a time to suit you).

One quick call could potentially save you thousands of pounds over the course of your mortgage.

Testimonial 1



Super service from start to finish. Martins offered us a personalized service which provided valuable practical advice, coupled with prompt responses and regular updates on progress. All staff ensured we got an efficient, polite, and helpful experience to guide us through the marketing and sale of the property. This resulted in a sale being agreed within 7 days. Highly professional.

Testimonial 2



Very professional team. Moving into our new home was amazing thanks to them.

Testimonial 3



Excellent! Coleen is soo enthusiastic & Lucy, these two girls are great, no problems, sold my property in 4 day's!!!



/martincouk



/MartinCoUK



/martinco_uk



/company/martin-&-co

Important - Please Read

These particulars do not constitute any part of an offer or contract. All statements in these details are made without liability on the part of Martin & Co Guisborough or the seller.

They should not be relied upon as a statement or representation of fact and, although believed to be correct, are not guaranteed and form no part of an offer or contract. Any intending buyers must satisfy themselves as to their correctness.

Please note that all appliances and heating systems are not tested by Martin & Co Guisborough and therefore no warranties can be given as to their good working order.

Martin & Co Guisborough

Data Quality

We are committed to comprehensive property data being made available upfront to make the home buying and selling process quicker, easier and cheaper. This is why we have partnered with Sprift, the UK's leading supplier of property-specific data.



Contains public sector information licensed under the Open Government License v3.0

The information contained within this report is for general information purposes only and to act as a guide to the best way to market your property for the asking price.

Sprift Technologies Ltd aggregate this data from a wide variety of sources and while we endeavour to keep the information up to date and correct, we make no representations or warranties of any kind, express or implied, about the completeness, accuracy, reliability, of the information or related graphics contained within this report for any purpose.

Any reliance you place on such information is therefore strictly at your own risk. In no event will we be liable for any loss or damage including without limitation, indirect or consequential loss or damage, or any loss or damage whatsoever arising from loss of data or profits arising out of, or in connection with, the use of this report.



Martin & Co Guisborough

83 Westgate Guisborough North Yorkshire

TS14 6AF

01287 631254

guisborough@martinco.com

www.martinco.com/estate-agents-and-letting-agents/branch/guisborough/

