



## Keswick

Greta House, Penrith Road, Keswick, Cumbria, CA12 4JS

A cottage style three bedroom period terrace house conveniently situated under one mile from Keswick town centre with the benefit of a rear garden adjoining the river Greta. Upgrading of the accommodation is required.

## Offers over £250,000

### Quick Overview

- Cottage style period terrace house
- Rear garden adjoining the river Greta
- Under one mile from Keswick town centre
- Three bedrooms
- Living room and sitting room
- Upgrading of the accommodation required



3



1



2



D



Superfast  
80Mbps

Property Reference: KW0312





Living Room



Living Room



Sitting Room



Sitting Room

## Accommodation

### Ground Floor:

#### Entrance Hall

With radiator.

**Living Room** 10' 7" x 9' 11" (3.23m x 3.02m)  
With tiled fireplace, radiator.

**Sitting Room** 16' 7" x 12' 0" (5.05m x 3.66m)  
With tiled fireplace, radiator, under stairs cupboard,  
external rear door.

**Kitchen** 7' 9" x 4' 7" (2.36m x 1.4m)  
With fitted base and wall units, sink with mixer tap,  
integrated oven, hob and extractor unit.

### First Floor:

#### Landing

**Bedroom One** 12' 2" x 8' 11" (3.71m x 2.72m)  
With radiator.

**Bedroom Two** 10' 0" x 9' 7" (3.05m x 2.92m)  
With radiator.

**Bedroom Three** 8' 6" x 5' 2" (2.59m x 1.57m)  
With radiator.

#### Shower Room

With WC, wash hand basin, shower cubicle.





Living Room



Sitting Room





Kitchen



Bedroom One



Bedroom Two



Shower Room

### Outside:

Front forecourt and extensive lawned rear garden adjoining the river Greta.

### Services

Mains water, electricity, gas and drainage. Gas central heating.

### Tenure

Freehold.

### Council Tax

Band C.

### Flooding

The property experienced flooding during the floods in 2009 and 2015.

### Viewing

By appointment with Hackney and Leigh's Keswick office.

### Directions

From Keswick town centre proceed onto Penrith Road and the property is located within the row of terrace houses on the left opposite the Twa Dogs public house.

### Price

Offers over £250,000 are invited.





Rear Garden



Rear Elevation





Rear Garden



Rear View

Request a Viewing Online or Call 01768 741741



# Meet the Team

## Nick Elgey

Sales Manager

Tel: 017687 41741  
Mobile: 07368 416931  
nre@hackney-leigh.co.uk



## Simon Bennett

Sales Team

Tel: 017687 41741  
keswicksales@hackney-leigh.co.uk



## Jane Irving

Sales Team

Tel: 017687 41741  
keswicksales@hackney-leigh.co.uk



## Ruth Leckie

Sales Team

Tel: 017687 41741  
keswicksales@hackney-leigh.co.uk



## Helen Holt

Viewing Team

Tel: 017687 41741  
keswicksales@hackney-leigh.co.uk



## Nicola Atkinson

Lettings Team

Tel: 01539 792035  
lettings@hackney-leigh.co.uk



Viewings available 7 days a week including evenings with our dedicated viewing team  
Call **01768 741741** or request online.



Need help with **conveyancing**? Call us on: **01539 792032**



Can we save you money on your **mortgage**? Call us on: **01539 792033**

Hackney & Leigh Ltd 11 Bank Street, Keswick, Cumbria, CA12 5JY | Email: keswicksales@hackney-leigh.co.uk

# Greta House, Penrith Road, Keswick

Approximate Area = 772 sq ft / 71.7 sq m

For identification only - Not to scale

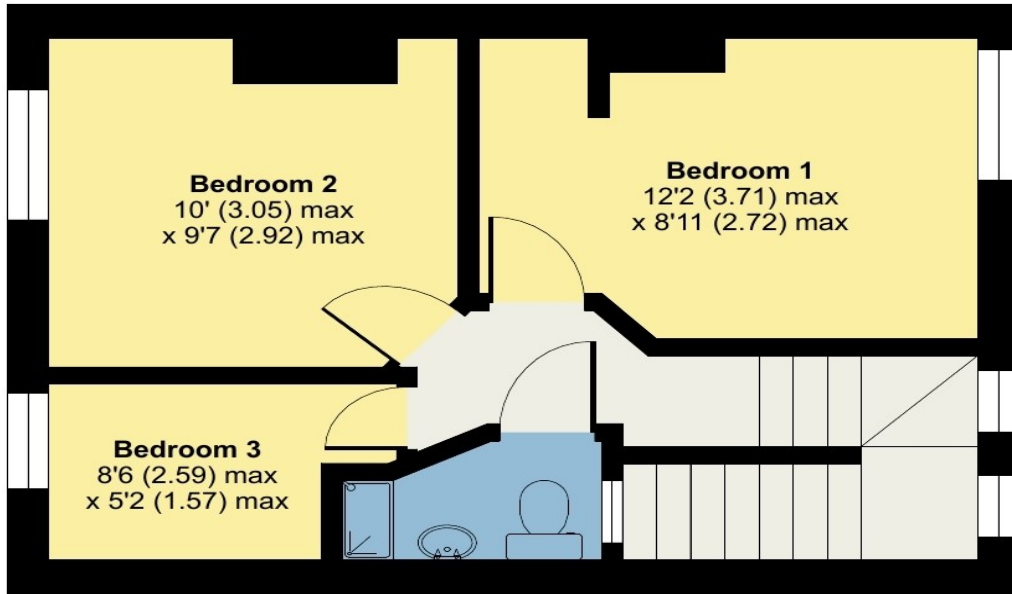

FIRST FLOOR

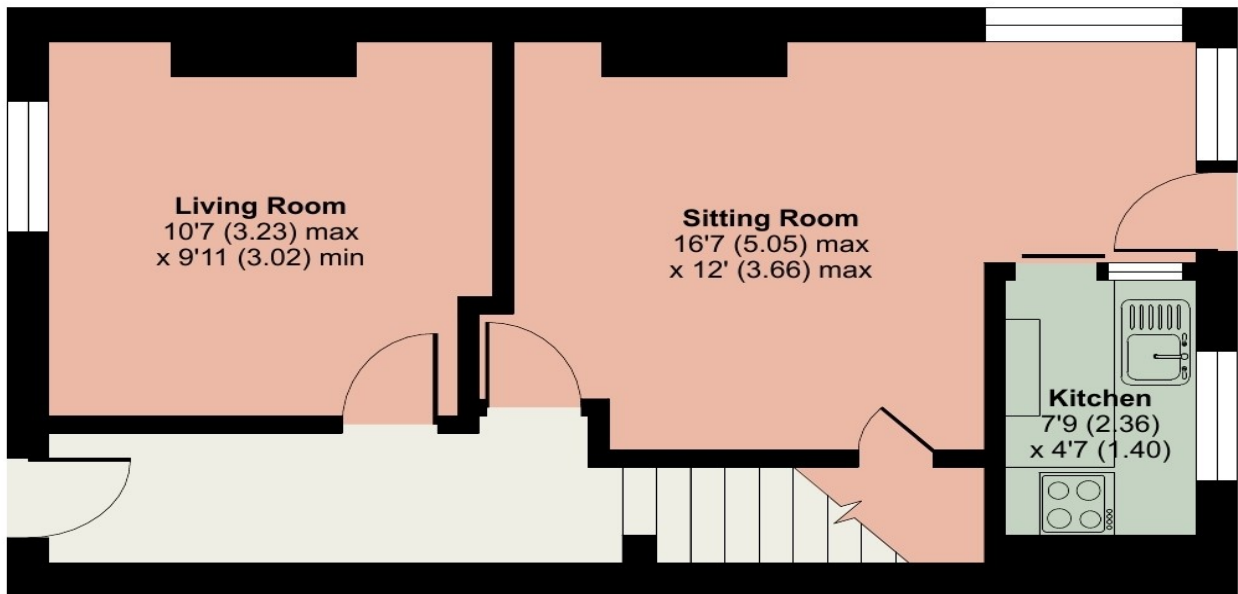

GROUND FLOOR



Floor plan produced in accordance with RICS Property Measurement Standards incorporating International Property Measurement Standards (IPMS2 Residential). © nīche.com 2023. Produced for Hackney & Leigh. REF: 1057633

All permits to view and particulars are issued on the understanding that negotiations are conducted through the agency of Messrs. Hackney & Leigh Ltd. Properties for sale by private treaty are offered subject to contract. No responsibility can be accepted for any loss or expense incurred in viewing or in the event of a property being sold, let, or withdrawn. Please contact us to confirm availability prior to travel. These particulars have been prepared for the guidance of intending buyers. No guarantee of their accuracy is given, nor do they form part of a contract. \*Broadband speeds estimated and checked by <https://checker.ofcom.org.uk/en-gb/broadband-coverage> on 22/11/2023.

Request a Viewing Online or Call 01768 741741