

25
YEARS

SERVING
BEACONSFIELD
SINCE 1998



27 Patterson Court, Wooburn Green

Guide Price £550,000

Ashington Page

Nestled in the desirable locale of Wooburn Green, this property offers the opportunity to acquire a beautiful 3-bedroom semi-detached house that is both inviting and spacious. From the moment you step through the front door, you'll be greeted by a light, bright, and generously proportioned entrance hall, setting the stage for a remarkable living experience.

Freehold

EPC: C

Directions: Sat Nav HP10 0FD

Council Tax: D

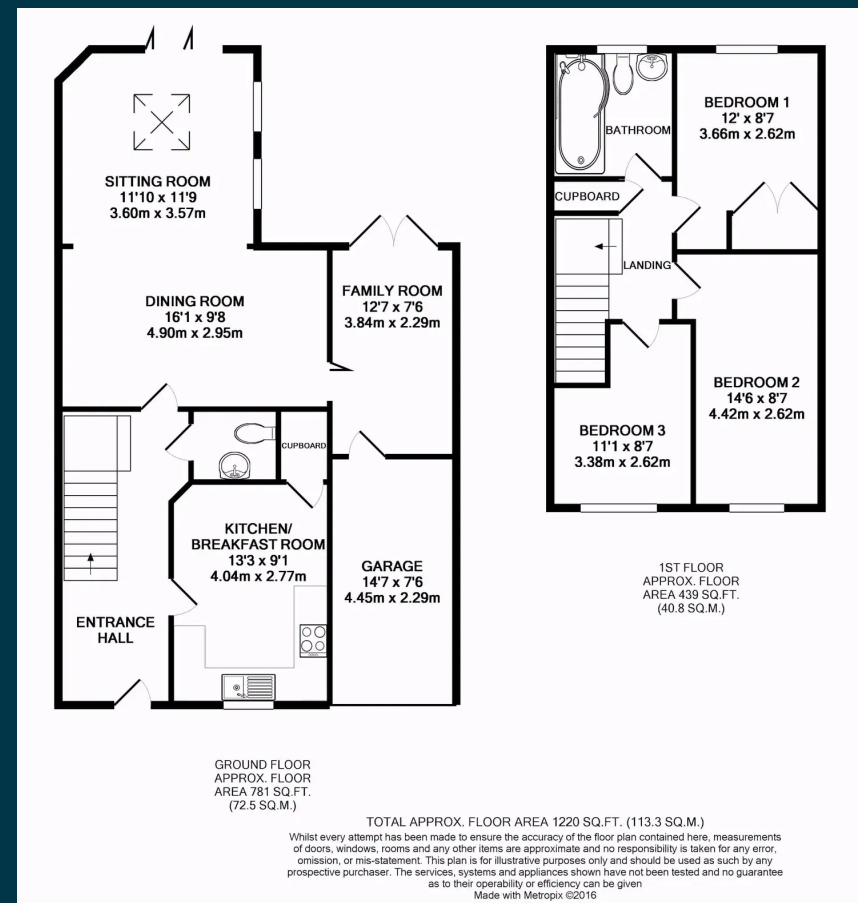

These particulars are for guidance only. They are prepared and issued in good faith and are intended to give a fair summary of the property. Any description should not be relied on as a statement or representation of fact or that the property, or its services, are in good condition. The photographs show only certain parts of the property at the time they were taken. Any areas, measurements or distance given are approximate only. Any reference to alterations to, or use of, any part of the property is not a statement that any necessary planning, building regulations or other consent has been obtained. These matters must be verified by an intending purchaser. All statements contained in these particulars in relation to the property are made without responsibility of Ashington Page or its clients. Neither Ashington Page (nor any joint agents) nor any of their employees has any authority to make or give any representation or warranty whatsoever in relation to the property



01494 680018
info@ashingtonpage.co.uk
www.AshingtonPage.co.uk

