



Flat 4 Middleton Place

A well presented one bedroom flat in the heart of Middleton-on-Sea.



- ▶ **First Floor Apartment of 475 Sqft**
- ▶ **Open Plan Kitchen/Sitting/Dining Room**
- ▶ **Garage in Courtyard**
- ▶ **125 Year Lease Commencing 2011**
- ▶ **One Double Bedroom**
- ▶ **Bathroom**
- ▶ **Village Centre Location**

This one bedroom purpose built flat is well presented throughout and is situated just across the road from a pretty green and duck pond in the heart of Middleton-on-Sea with all its amenities close by.

Accommodation includes: a south facing, open plan kitchen/dining and sitting room. The kitchen is fitted with a range of modern units and has an integrated oven and hob, along with space for a fridge/freezer. There is also a double bedroom and a bathroom with a utility cupboard housing the washing machine.

Outside, there is parking on a first come first serve basis and a garage will be found in a courtyard situated to the rear of the development.

Tenure: We understand there is 125 year lease from 2011.

Maintenance Charge: We understand the maintenance charge is currently £90 per month.

Council Tax Band: B



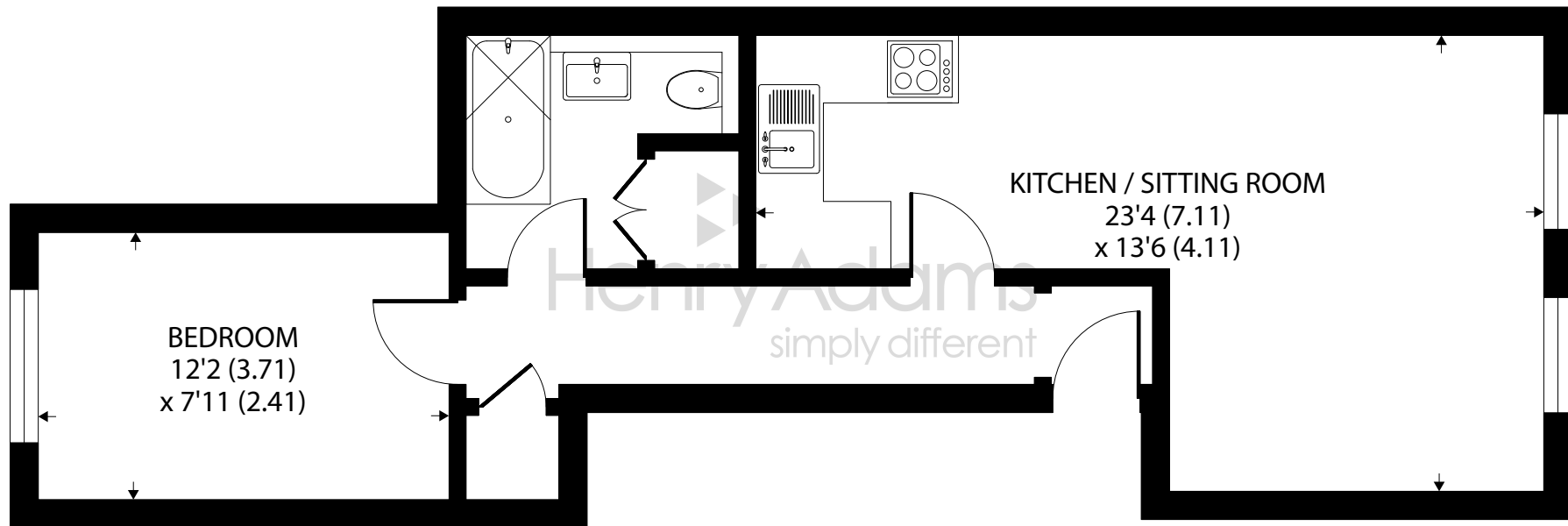
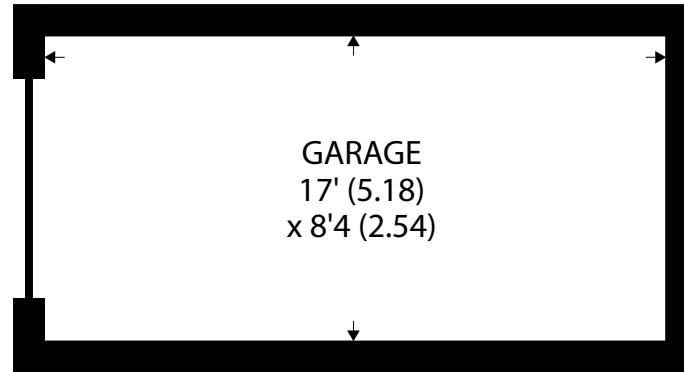

FIRST FLOOR

Approximate Area = 616 sq ft / 57.2 sq m (includes garage)

For identification only - Not to scale



Agents Note - Our particulars are for guidance only and are intended to give a fair overall summary of the property. They do not form part of any contract or offer, and should not be relied upon as a statement or representation of fact. Measurements, areas and distances are approximate only. Photographs may include lifestyle shots and pictures of local views. No undertaking is given as to the structural condition of the property, or any necessary consents or the operating ability or efficiency of any service, system or appliance. Please ask if you would like further information, especially before you travel to the property.

Location

The charming village of Middleton-on-Sea offers a wide range of local facilities including a doctor's surgery, pharmacy, sports/social club, post office and a range of useful shops, café, fish and chip shop and a pub. Nearby attractions include Bognor Golf Club, a sailing club and the unspoilt beach. A regular bus service links the village to Bognor Regis which offers a more comprehensive range of amenities. Historic Arundel, the cathedral city of Chichester and the famous Goodwood motor circuit and racecourse can all be found within an 11 mile radius.

Directions

From our office in Middleton-on-Sea proceed in an easterly direction for a short distance. The property will be found on the left hand side, opposite the turning into Sea Lane.

01/02/24

