



30 Summerlands Court, Liverton - TQ12 6HB

£45,000 Leasehold

One Bedroom Park Home requiring some work and modernisation, located in Liverton close to a well-stocked general store & post office, with countryside walks on your doorstep.

Available with no onward chain.

**chamberlains**
the key to your home

Contact Us...

 01626 818094

 boveysales@chamberlains.co

 50 Fore Street
Bovey Tracey TQ13 9AE

STEP INSIDE:

This one bedroom park home presents an excellent opportunity for renovation and modernisation. The property features a living room, kitchen, a bathroom, and a main bedroom.

The wall-mounted Worcester boiler is located in the bedroom. Perfect for an individual on their own looking to relocate to the Liverton area.

STEP OUTSIDE:

A paved area surrounds the property, with opportunity to create a relaxing area to enjoy your own peace & quiet in the outdoors. There is an outbuilding in situ, perfect for some extra storage.

USEFUL INFORMATION:

Make and model: Tingdene - Villa Compact built in 1980.

Gas Boiler: Worcester Boiler Installed 5/2/2012.

Mains electric and water. Water rate fixed at £19.50 p/m

Monthly Pitch charge: £176.23 p/m (Being reviewed in January 2024)

1 x Pet allowed*

1 x allocated parking space located on site

Tenure: Residential Park Home

Park Home Residents age 50+





Ground Floor
27.1 sq.m. (292 sq.ft.) approx.

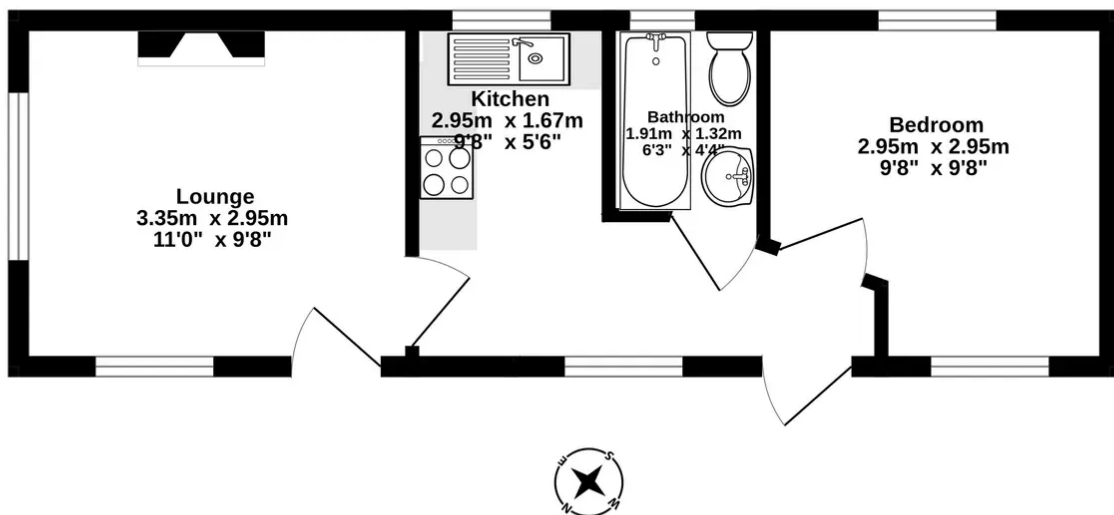

TOTAL FLOOR AREA : 27.1 sq.m. (292 sq.ft.) approx.

Whilst every attempt has been made to ensure the accuracy of the floorplan contained here, measurements of doors, windows, rooms and any other items are approximate and no responsibility is taken for any error, omission or mis-statement. This plan is for illustrative purposes only and should be used as such by any prospective purchaser. The services, systems and appliances shown have not been tested and no guarantee as to their operability or efficiency can be given.
Made with Metropix ©2023

LOCATION:

This Park Home site is situated in Liverton, and located in a quiet residential cul-de-sac. Liverton is on the edge of the Dartmoor National Park, it has a popular village pub and superbly stocked general stores and post office. The neighbouring village of Illsington offers a church, a general store, bowling and tennis clubs and a spa hotel among other amenities. The town of Bovey Tracey is approximately 2 miles away and offers a range of local shops, cafes and eating places as well as a health centre, library and a renowned craft centre. It is in within easy reach of the A38 Devon Express way linking Exeter and Plymouth.