



138 Southlands, Swaffham

Guide Price £300,000

138 Southlands

Swaffham, Swaffham

Guide Price: £300,000 - £330,000. Introducing a charming three bedroom bungalow offering a warm and inviting atmosphere, as you step into the entrance hallway. The property features a modern family bathroom, well-equipped kitchen and a comfortable lounge that opens to a spacious conservatory, seamlessly connecting indoor and outdoor living. The master bedroom boasts built-in storage and an ensuite bathroom, while the additional bedrooms offer versatility for various uses. The property's garage, workshop, shed and studio provide ample space for storage and creative pursuits. Outside, a low-maintenance front garden, dual driveways and a beautifully landscaped rear garden with lawn, shrubbery and patio areas complete this versatile living space.

Tenure: Freehold

EPC Energy Efficiency Rating: D

EPC Environmental Impact Rating: D





138 Southlands

Swaffham, Swaffham

Guide Price: £300,000 - £330,000. Introducing a charming three bedroom bungalow offering a warm and inviting atmosphere, as you step into the entrance hallway. The property features a modern family bathroom, well-equipped kitchen and a comfortable lounge that opens to a spacious conservatory, seamlessly connecting indoor and outdoor living. The master bedroom boasts built-in storage and an ensuite bathroom, while the additional bedrooms offer versatility for various uses. The property's garage, workshop, shed and studio provide ample space for storage and creative pursuits. Outside, a low-maintenance front garden, dual driveways and a beautifully landscaped rear garden with lawn, shrubbery and patio areas complete this versatile living space.

LOCATION

Nestled in the picturesque county of Norfolk, Swaffham is a charming market town that exudes historical character and a strong sense of community. Located in the East of England, Swaffham captivates with its quaint streets, traditional architecture, and a welcoming atmosphere. Surrounded by rolling countryside and open fields, the town offers a serene escape from the hustle and bustle of larger towns and cities. Its central market square, adorned with a striking Georgian clock, serves as a focal point for local activities and events. With a range of local shops, cosy cafes, and historical landmarks, Swaffham seamlessly blends its rich heritage with modern conveniences.



THE PROPERTY

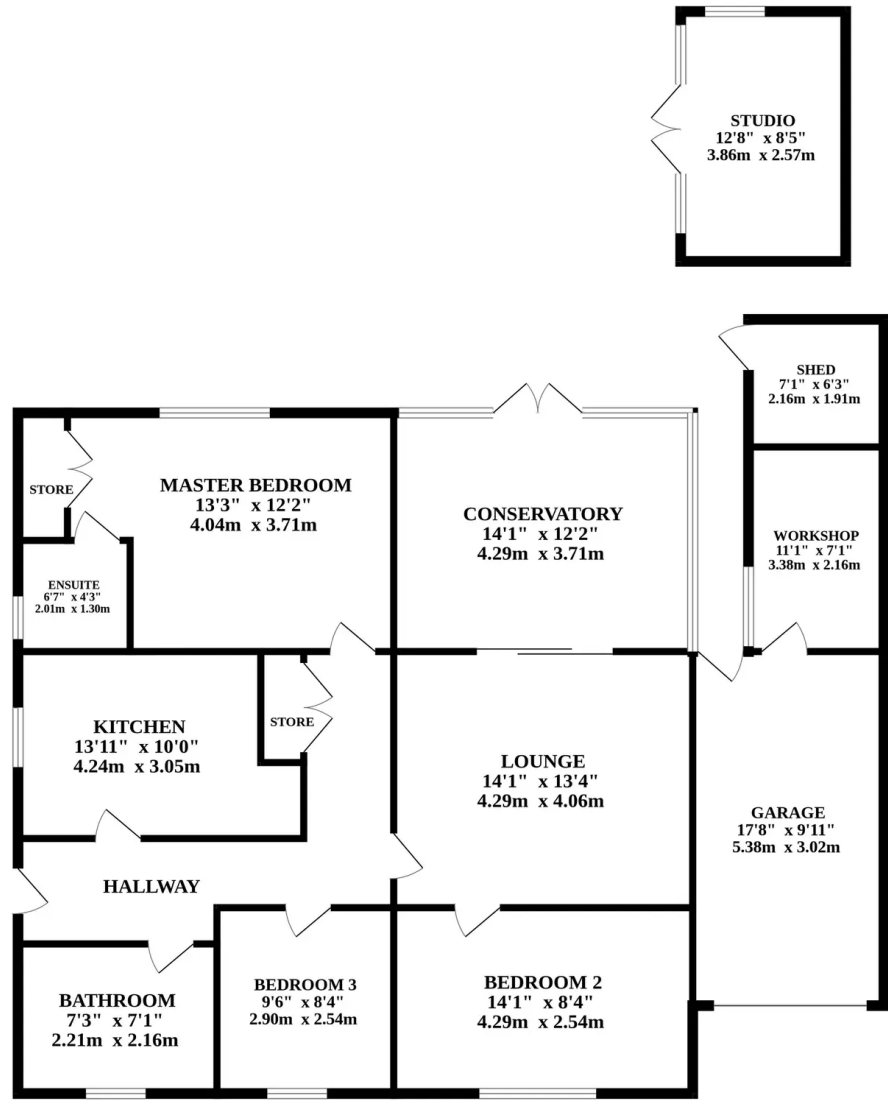

Whilst every attempt has been made to ensure the accuracy of the floorplan contained here, measurements of doors, windows, rooms and any other items are approximate and no responsibility is taken for any error, omission or mis-statement. This plan is for illustrative purposes only and should be used as such by any prospective purchaser. The services, systems and appliances shown have not been tested and no guarantee as to their operability or efficiency can be given.
Made with Metropix ©2023