



19 Hawthorn Crescent, Bradwell

£270,000 Freehold

Generous 2-bed bungalow in Bradwell. Spacious living room with bay window, kitchen-diner, conservatory. 2 double bedrooms, tiled bathroom. 100ft garden with patio areas, mature trees. Detached garage, summer house, 2 sheds, 2 greenhouses. Ideal for outdoor activities and gardening.

Council Tax band: C

Tenure: Freehold

Generous 2-bed bungalow in Bradwell. Spacious living room with bay window, kitchen-diner, conservatory. 2 double bedrooms, tiled bathroom. 100ft garden with patio areas, mature trees. Detached garage, summer house, 2 sheds, 2 greenhouses. Ideal for outdoor activities and gardening.

LOCATION

Nestled in the heart of Bradwell, Hawthorn Crescent offers a fantastic location with an array of amenities at your doorstep. The area boasts an excellent catchment for schooling options, making it an ideal choice for families. Recreational grounds provide outdoor spaces for leisure and activities, perfect for residents of all ages. Moreover, for those who adore the seaside, the beach is just a short drive away, allowing you to enjoy the coastal charm and all it has to offer. This location provides a well-rounded and convenient lifestyle for all residents.

HAWTHORN CRESCENT, BRADWELL

Step into this two-bedroom bungalow situated in the heart of Bradwell. Upon entry



Generous 2-bed bungalow in Bradwell. Spacious living room with bay window, kitchen-diner, conservatory. 2 double bedrooms, tiled bathroom. 100ft garden with patio areas, mature trees. Detached garage, summer house, 2 sheds, 2 greenhouses. Ideal for outdoor activities and gardening.

LOCATION

Nestled in the heart of Bradwell, Hawthorn Crescent offers a fantastic location with an array of amenities at your doorstep. The area boasts an excellent catchment for schooling options, making it an ideal choice for families. Recreational grounds provide



Generous 2-bed bungalow in Bradwell. Spacious living room with bay window, kitchen-diner, conservatory. 2 double bedrooms, tiled bathroom. 100ft garden with patio areas, mature trees. Detached garage, summer house, 2 sheds, 2 greenhouses. Ideal for outdoor activities and gardening.

LOCATION

Nestled in the heart of Bradwell, Hawthorn Crescent offers a fantastic location with an array of amenities at your doorstep. The area boasts an excellent catchment for schooling options, making it an ideal choice for families. Recreational grounds provide outdoor spaces for leisure and activities, perfect for residents of all ages. Moreover, for those who adore the seaside, the beach is just a short drive away, allowing you to enjoy the coastal charm and all it has to offer. This location provides a well-rounded and convenient lifestyle for all residents.

HAWTHORN CRESCENT, BRADWELL

Step into this two-bedroom bungalow situated in the heart of Bradwell. Upon entry through the welcoming entrance hallway, you gain easy access to all the ground-floor rooms, creating a seamless flow throughout the home.

The living room is generous in size and features plush carpeting underfoot, adding warmth and comfort to the space. There is ample room to arrange your furniture and the bay window bathes the room in natural light, creating a bright and inviting atmosphere. The kitchen dining area is also wonderfully spacious, equipped with multiple storage cupboards and generous counter space. This room also offers a dining area, making it a perfect space for casual meals and gatherings with family and friends. Additionally, there is a convenient conservatory with access from this room, which provides an ideal place to house additional furniture and enjoy the garden views.

The property boasts two generously sized bedrooms, both adorned with comfortable carpeting underfoot. Each bedroom offers ample space for a double bed and provides room for your storage furniture, ensuring that they cater to your needs and preferences. The bathroom is tiled throughout, making it easy to clean and maintain. It features a bath with an overhead shower, adding practicality and flexibility.

At the rear of the property, you'll discover a fantastic 100ft garden, predominantly laid to lawn. This outdoor space provides ample room for outdoor activities, gardening, and relaxation. The garden also features multiple patio areas, ideal for outdoor seating. The space is adorned with mature trees and bushes, creating a picturesque environment. For added privacy and security, the



GROUND FLOOR

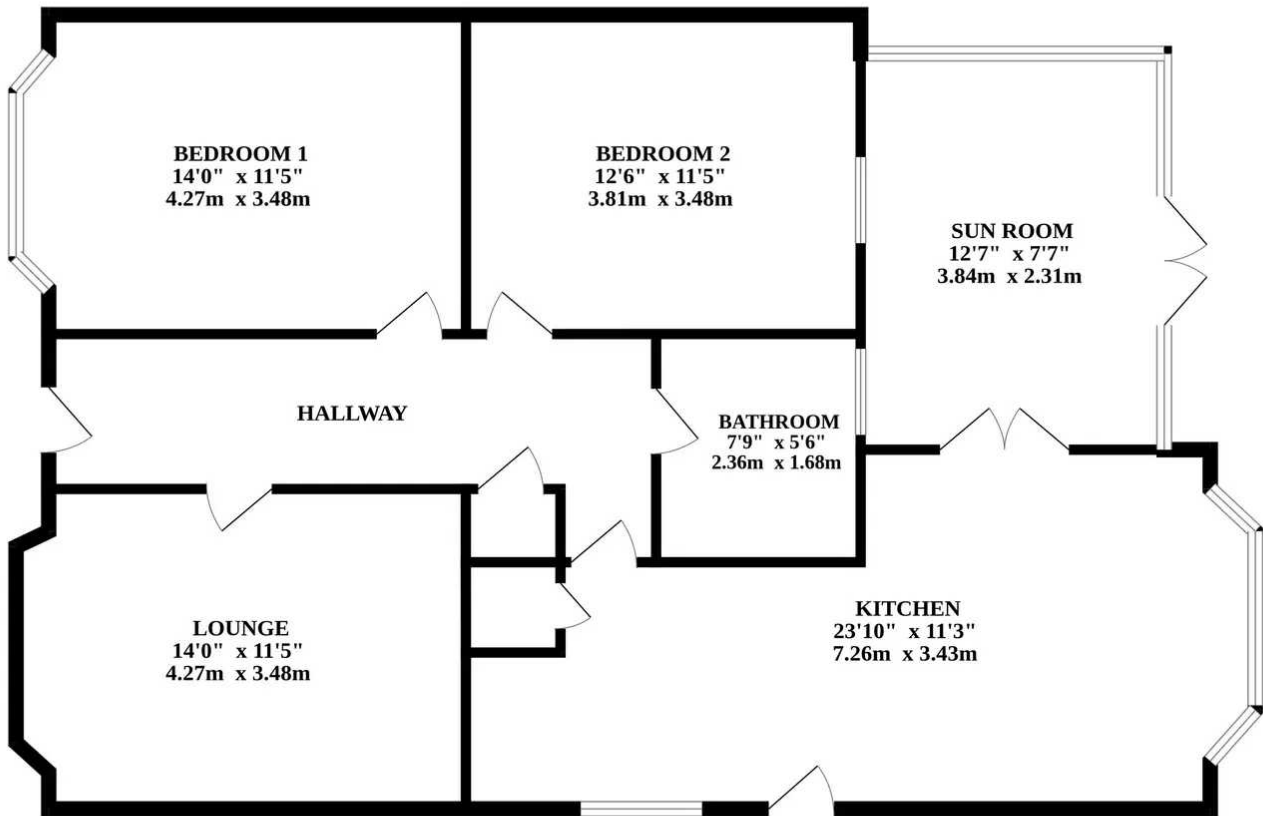

Whilst every attempt has been made to ensure the accuracy of the floorplan contained here, measurements of doors, windows, rooms and any other items are approximate and no responsibility is taken for any error, omission or mis-statement. This plan is for illustrative purposes only and should be used as such by any prospective purchaser. The services, systems and appliances shown have not been tested and no guarantee as to their operability or efficiency can be given.
Made with Metropix ©2023

You can include any text here. The text can be modified upon generating your brochure.

You can include any text here. The text can be modified upon generating your brochure.

