



## Netherfield Gardens

, Barking, IG11 9TL

Asking price £415,000



# Netherfield Gardens

, Barking, IG11 9TL

Asking price £415,000



## ENTRANCE HALL

14'12 x 5'95 (4.27m x 1.52m)

## LOUNGE

15'48 x 12'42 (4.57m x 3.66m)

## DINING ROOM

12'42 x 10'91 (3.66m x 3.05m)

## KITCHEN

8'40 x 7'46 (2.44m x 2.13m)

## EXTENSION

18'0" x 6'9" (5.49 x 2.08)

## BEDROOM 1

15'50 x 11'01 (4.57m x 3.38m)

## BEDROOM 2

12'29 x 10'66 (3.66m x 3.05m)

## BEDROOM 3

8'23 x 7'40 (2.44m x 2.13m)

## WC

5'61 x 2'40 (1.52m x 0.61m)

## SHOWER ROOM

5'61 x 5'15 (1.52m x 1.52m)

## GARDEN

70 (21.34m)

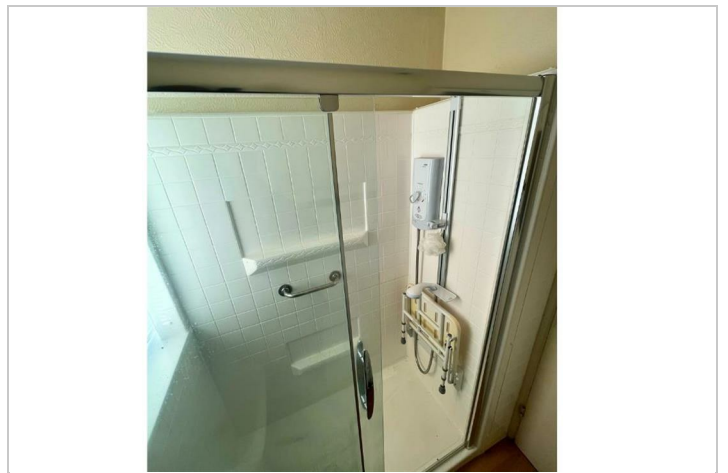

## Road Map

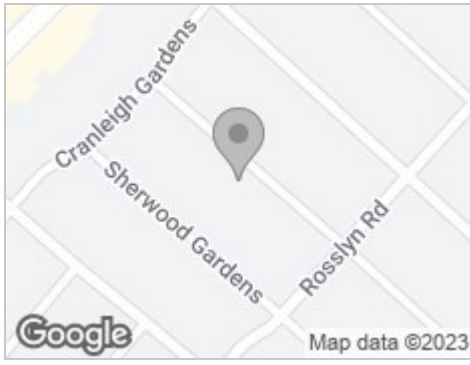

## Hybrid Map



## Terrain Map

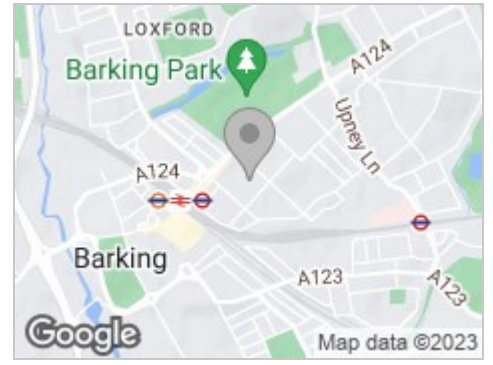

## Floor Plan

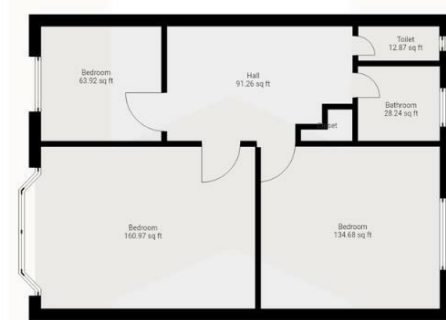

## Viewing

Please contact us on 02080873122 if you wish to arrange a viewing appointment for this property or require further information.

## Energy Efficiency Graph

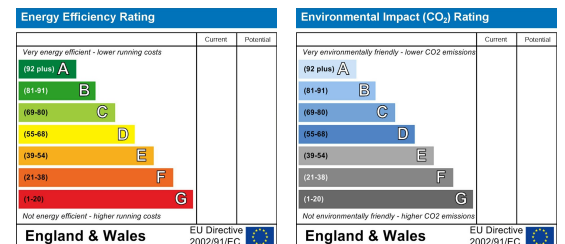

These particulars, whilst believed to be accurate are set out as a general outline only for guidance and do not constitute any part of an offer or contract. Intending purchasers should not rely on them as statements of representation of fact, but must satisfy themselves by inspection or otherwise as to their accuracy. No person in this firm's employment has the authority to make or give any representation or warranty in respect of the property.