

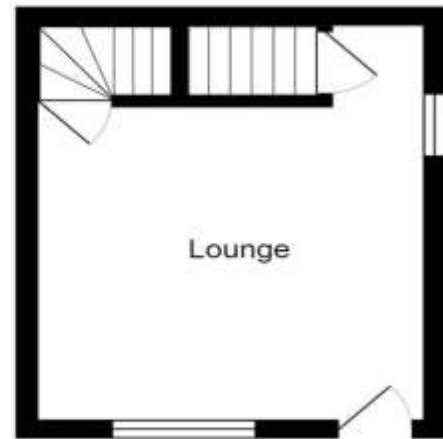

MARTIN&CO

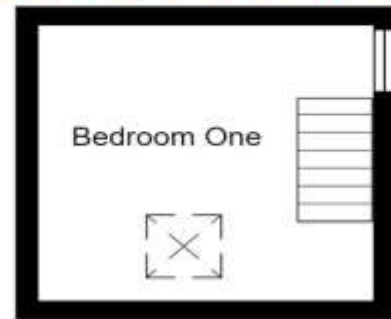

Accuracy: References to the Tenure of a Property are based on information supplied by the Seller. The Agent has not had sight of the title documents. A Buyer is advised to obtain verification from their Solicitor. Items shown in photographs including but not limited to carpets, fixtures and fittings are not included unless specifically mentioned within the sales particulars. They may however be available by separate negotiation. Buyers must check the availability of any property and make an appointment to view before embarking on any journey to see a property. No person in the employment of the agent has any authority to make any representation about the property, and accordingly any information given is entirely without responsibility on the part of the agents, sellers(s) or lessors(s). Any property particulars are not an offer or contract, nor form part of one. **Sonic / Laser Tape:** Measurements taken using a sonic / laser tape measure may be subject to a small margin of error. **All Measurements:** All Measurements are Approximate. **Services Not tested:** The Agent has not tested any apparatus, equipment, fixtures and fittings or services and so cannot verify that they are in working order or fit for the purpose. A Buyer is advised to obtain verification from their Solicitor or Surveyor.

Barley Street, Ingrow, BD22

£110,000 Freehold

Two Bedroom End Terrace

EPC Rating: E

Martin & Co Keighley
4 North Street • • Keighley • BD21 3SE
T: 01535 669588 • E: keighley@martinco.com

01535 669588
<http://www.martinco.com>





Barley Street
Ingrow
BD22

Key features:

- Two Bedroom End Terrace
- Recently Renovated
- No Upward Chain
- Gas Central Heating
- Popular Residential Location
- Modern Finish Throughout
- Over Four Floors
- Close To Local Amenities



LOUNGE 13' 1" x 16' 0" (4m x 4.9m) Large lounge with new carpet flooring and windows on two sides providing ample natural light

KITCHEN/DINER 13' 1" x 12' 9" (4m x 3.9m) Large kitchen/diner with brand new fitted kitchen and integrated appliances

BEDROOM TWO 7' 10" x 13' 1" (2.4m x 4m) Excellent sized second bedroom with new carpet flooring and built in cupboard

BATHROOM 4' 11" x 9' 2" (1.5m x 2.8m) Newly fitted bathroom suite comprising; WC, hand wash basin and shower over bath with storage cupboard

BEDROOM ONE 10' 5" x 12' 9" (3.2m x 3.9m) Large double bedroom with new carpet flooring and windows providing ample natural light



Why you'll like it

RECENTLY RENOVATED Two Bedroom End Terrace home perfect for First Tim Buyers situated in the popular residential area of Ingrow. Benefitting from; BRAND NEW fitted kitchen and bathroom and new carpet flooring! Viewing is essential!

READY TO MOVE IN!

Situated close to local shops and amenities in the popular residential area of Ingrow, this two bedroom end terraced property is situated over four floors

