



198 Bermuda Chalet, Newport Road, Hemsby

£25,000 Leasehold

Stunning 3-bed chalet in sought-after Hemsby location. Spacious open-plan living, stylish interior, and well-appointed kitchen. Perfect holiday home or investment. Close to amenities and outdoor activities. Arrange a viewing now!

Council Tax band: A

Tenure: Leasehold

Stunning 3-bed chalet in sought-after Hemsby location. Spacious open-plan living, stylish interior, and well-appointed kitchen. Perfect holiday home or investment. Close to amenities and outdoor activities. Arrange a viewing now!

LOCATION

Newport Road in Hemsby is a charming thoroughfare that winds through this coastal village, located on the east coast of England in Norfolk. The road is characterized by a mix of quaint cottages, modern residences, and small businesses, creating a harmonious blend of traditional and contemporary architecture. Hemsby itself is known for its proximity to the scenic coastline of the North Sea, and Newport Road reflects this coastal influence. The street is often alive with the hustle and bustle of locals and visitors alike, as they explore the nearby attractions and enjoy the relaxed atmosphere. With the sound of seagulls in the air and a refreshing sea breeze, Newport Road encapsulates the coastal charm that defines Hemsby, making it a delightful destination for residents and tourists seeking a coastal retreat.



Stunning 3-bed chalet in sought-after Hemsby location. Spacious open-plan living, stylish interior, and well-appointed kitchen. Perfect holiday home or investment. Close to amenities and outdoor activities. Arrange a viewing now!

LOCATION

Newport Road in Hemsby is a charming thoroughfare that winds through this coastal village, located on the east coast of England in Norfolk. The road is characterized by a mix of quaint cottages, modern residences, and small businesses, creating a harmonious blend of traditional and

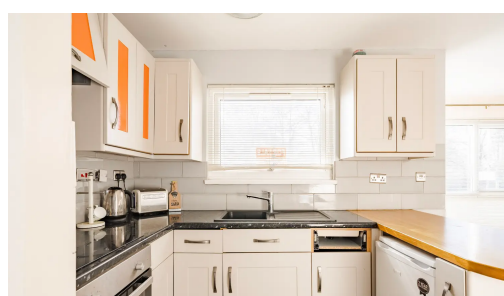

Stunning 3-bed chalet in sought-after Hemsby location. Spacious open-plan living, stylish interior, and well-appointed kitchen. Perfect holiday home or investment. Close to amenities and outdoor activities. Arrange a viewing now!

LOCATION

Newport Road in Hemsby is a charming thoroughfare that winds through this coastal village, located on the east coast of England in Norfolk. The road is characterized by a mix of quaint cottages, modern residences, and small businesses, creating a harmonious blend of traditional and contemporary architecture. Hemsby itself is known for its proximity to the scenic coastline of the North Sea, and Newport Road reflects this coastal influence. The street is often alive with the hustle and bustle of locals and visitors alike, as they explore the nearby attractions and enjoy the relaxed atmosphere. With the sound of seagulls in the air and a refreshing sea breeze, Newport Road encapsulates the coastal charm that defines Hemsby, making it a delightful destination for residents and tourists seeking a coastal retreat.

NEWPORT ROAD, HEMSBY

Introducing a truly remarkable three-bedroom chalet, offering a perfect opportunity for those seeking an ideal holiday home or a lucrative investment opportunity. Situated in the sought-after location of Hemsby, NR29, this property boasts a spacious open-plan living area, a well-appointed kitchen, a stylish interior, and a light and airy atmosphere that is sure to captivate.

Upon entering the chalet, you will be greeted by the inviting open-plan living area. This delightful space offers an abundance of room, ensuring ample space for both relaxation and entertainment. The airy ambience, facilitated by the large windows, fills the room with a sense of tranquillity, cultivating an atmosphere that is perfect for unwinding after a long day.

The well-appointed kitchen area seamlessly blends contemporary design and functionality, providing an excellent space for culinary pursuits. With modern fixtures and fittings, ample storage options, and high-quality appliances, this kitchen will truly inspire the chef in you.

The chalet's stylish interior is a testament to both the craftsmanship and attention to detail that has been invested into creating this remarkable property. The carefully chosen finishes and modern design elements create a luxurious contemporary feel throughout, exuding a sense of opulence and sophistication.



GROUND FLOOR
908 sq.ft. (84.3 sq.m.) approx.

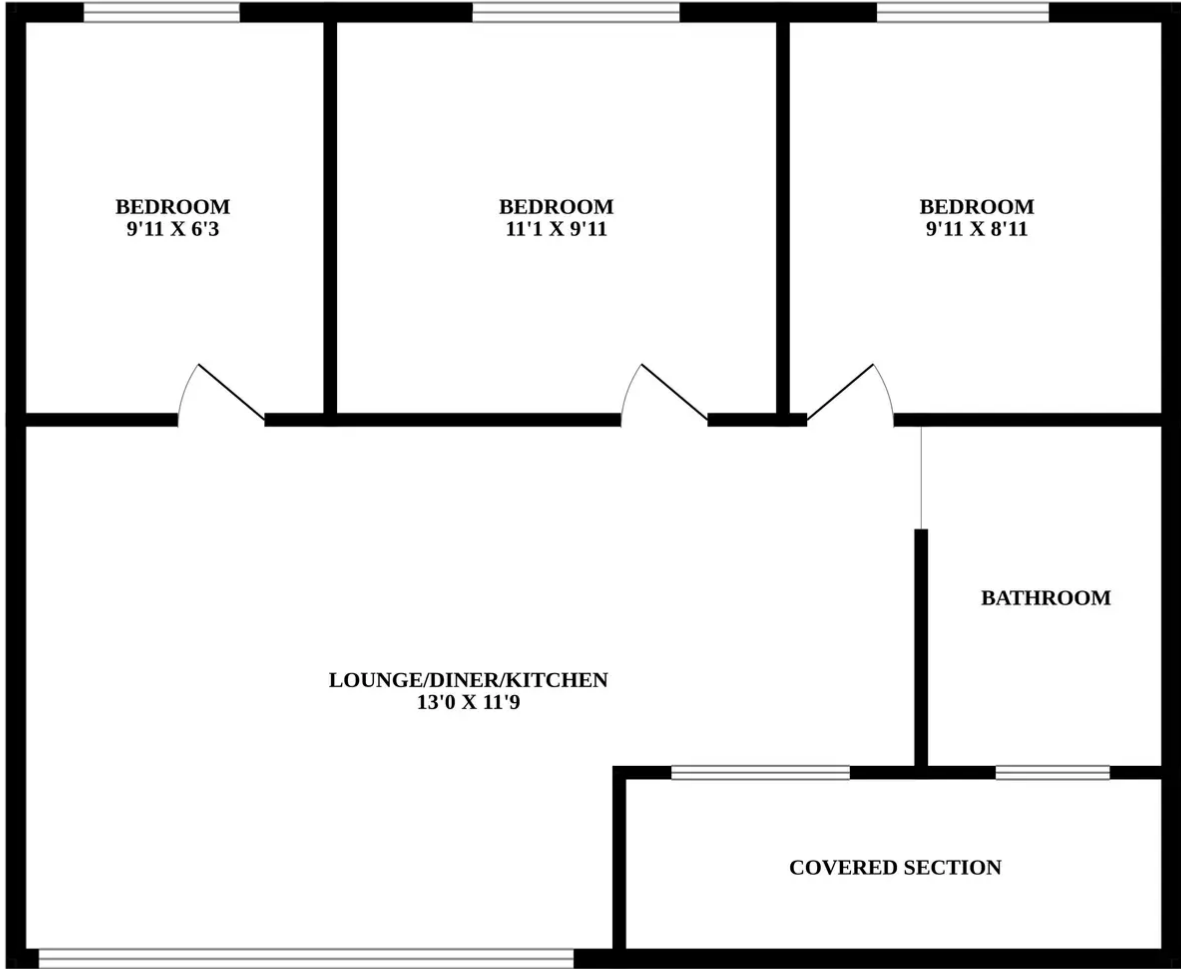

TOTAL FLOOR AREA : 908 sq.ft. (84.3 sq.m.) approx.
Whilst every attempt has been made to ensure the accuracy of the floorplan contained here, measurements of doors, windows, rooms and any other items are approximate and no responsibility is taken for any error, omission or mis-statement. This plan is for illustrative purposes only and should be used as such by any prospective purchaser. The services, systems and appliances shown have not been tested and no guarantee as to their operability or efficiency can be given.
Made with Metropix ©2023

You can include any text here. The text can be modified upon generating your brochure.

You can include any text here. The text can be modified upon generating your brochure.

