



27 Bellhouse Road, Romford

£1,175 pcm

Under 1.2 miles to Queens Hospital and Romford Train Station • Private Rear Garden • Parking via Driveway • Kitchen Including Washing Machine, Fridge Freezer, Oven and Hob • Ample Storage • Ground Floor Maisonette • Initial Tenancy Term - 12 Months • Tenancy Deposit - £1,355.00 • EPC Rating - D • Council Tax Band - B



Accord is delighted to offer this conveniently located studio apartment has a driveway which could cater for 2 / 3 vehicles. Located within an ideal position with Queens Hospital and Romford Train Station both situated less than 1.2 miles away. Upon entering you're greeted to an open-plan living / bedroom area. Through this room you can access a hallway which has two storage cupboards with the kitchen to the left and bathroom to the right. The kitchen has modern appliances including a washing machine, fridge freezer, oven and hob. The studio also has its own private garden.

Council Tax Band - B

Initial Tenancy Term - 12 Months

Tenancy Deposit - £1,355.00

EPC Rating - D



Lounge

12' 3" x 10' 6" (3.74m x 3.21m)

Bedroom Area

8' 6" x 6' 8" (2.59m x 2.02m)

Kitchen

7' 10" x 10' 11" (2.39m x 3.34m)

Bathroom

9' 0" x 5' 11" (2.75m x 1.80m)



Approx Gross Internal Area
35 sq m / 381 sq ft

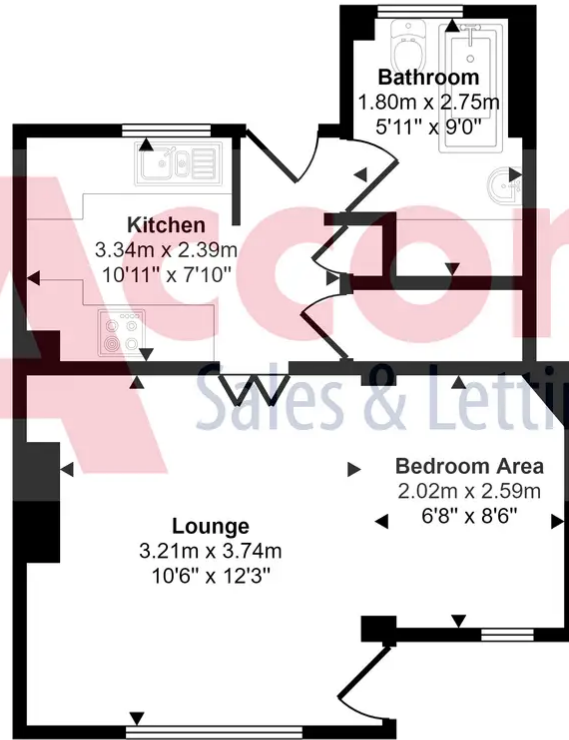

Floorplan

This floorplan is only for illustrative purposes and is not to scale. Measurements of rooms, doors, windows, and any items are approximate and no responsibility is taken for any error, omission or mis-statement. Icons of items such as bathroom suites are representations only and may not look like the real items. Made with Made Snappy 360.

You can include any text here. The text can be modified upon generating your brochure.