



FOR SALE

3 Bed Semi-Detached House in The Meadway, Birstall LE4 4NF
Auction Guide Price £150,000

Guide Price £150,000 + Plus Fees - Unconditional with Variable Fee

'For Sale by auction on 31st January 2024 at 10.00am.'

Property Description:

An extended 3 bedroom semi detached house in need of renovation.



GROUND FLOOR
480 sq.ft. (44.6 sq.m.) approx.

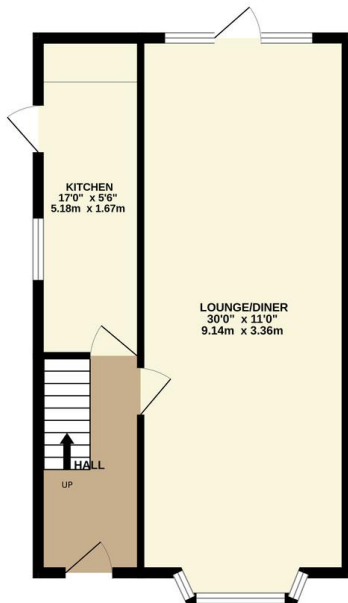

1ST FLOOR
342 sq.ft. (31.7 sq.m.) approx.

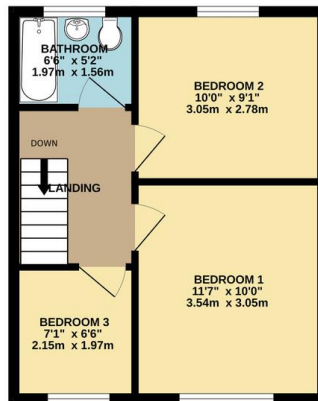

TOTAL FLOOR AREA: 822 sq.ft. (76.4 sq.m.) approx.

Whilst every attempt has been made to ensure the accuracy of the floorplans contained here, measurements of doors, windows, rooms and any other items are approximate and no responsibility is taken for any error or omission of this statement. This plan is for illustrative purposes only and should be used as such by any prospective purchaser. The services, systems and appliances shown have not been tested and no guarantee as to their operability or efficiency can be given.
Made with Metropia ©2023

EPC Ordered

- Semi Detached House
- Requires Modernisation
- Three Bedrooms
- Rear Ground Floor Extension
- Parking
- Sought After Location
- Guide Price £150,000 + Plus Fees
- For Sale By Auction on 31st January 2024 at 10.00am

Agents Note: Whilst every care has been taken to prepare these sales particulars, they are for guidance purposes only. All measurements are approximate are for general guidance purposes only and whilst every care has been taken to ensure their accuracy, they should not be relied upon and potential buyers are advised to recheck the measurements.

