



Front elevation

2 BEDROOM TERRACED HOUSE WITH PARKING

Churchfield Road, Reigate, Surrey, RH2 9RH

Elevate your lifestyle with this 2-bed terraced house in central Reigate. Tucked in a tranquil cul-de-sac, it's a short walk to town and the train station. The open-plan living area is bathed in natural light, seamlessly connecting style and functionality. The well-equipped kitchen and modern bathroom add flair. To the rear you will find a private garden with a level lawn and patio. 1 off-road parking space is to the front of the house. Chain-free, this residence is a contemporary haven offering comfort, style, and prime location—a rare gem in central Reigate.



Kitchen



Sitting/dining room

lewis
white



Ground Floor
Approx. 30.2 sq. metres (325.2 sq. feet)

First Floor
Approx. 29.1 sq. metres (313.3 sq. feet)

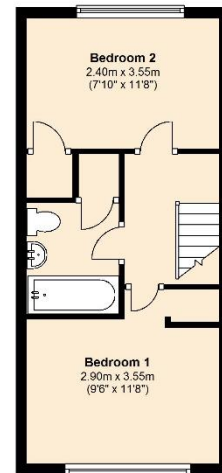
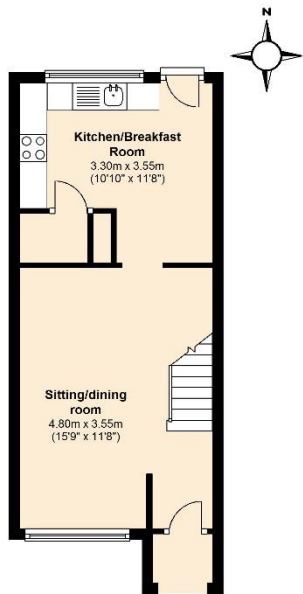

Total area: approx. 59.3 sq. metres (638.6 sq. feet)



Council tax band: D EPC: Awaited