



Coopers

Kilby Mews, off Far Gosford Street, Coventry CV1 5EB

£285,000



Kilby Mews

off Far Gosford Street, Coventry CV1 5EB

An attractive four / five bedroom terraced house with parking on this exclusive gated development just off Far Gosford Street, only a short walk from...

Council Tax band: C

Tenure: Freehold

EPC Energy Efficiency Rating: B

EPC Environmental Impact Rating: B

- Four / Five bedroom terraced home
- Ideal as a family home or investment
- EPC rating B fully compliant and licenced HMO
- Outside to the front is a communal, securely gated area with bin store and an allocated parking
- To the rear is a low maintenance, landscaped, south facing private rear garden with niceley laid out paving, quality artificial grass and shed for added storage
- ground floor open plan kitchen/diner, cloakroom with WC and sitting room or fifth bedroom
- The first and second floors have two bedrooms and a bathroom/shower room each
- Service charge of £460 per year





Ground Floor



First Floor

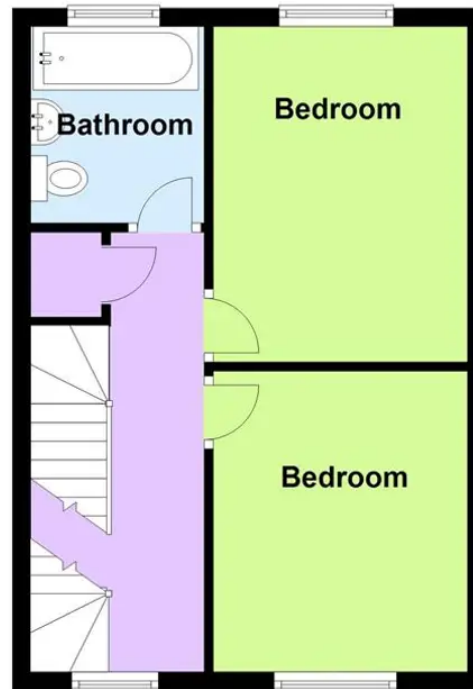

Second Floor

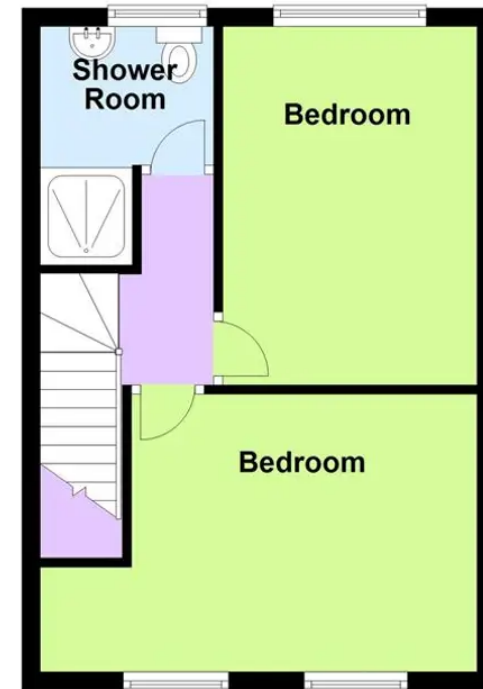

This floor plan is for illustrative purposes only and should be used as such by any prospective purchaser. Whilst every attempt has been made to ensure the accuracy of this plan, measurements of doors, windows, rooms and other items are approximate and no responsibility is taken for any error, omission or mis-statement.
Plan produced using PlanUp.

Coopers Estate Agents

Coopers, 22 New Union Street - CV1 2HN

024 7655 2841 • sales@coopersestateagents.com • www.coopersestateagents.com/

Coopers Chartered Surveyors Ltd, 22 New Union Street, Coventry, West Midlands

CV1 2HN, 024 7655 2841, sales@coopers-cov.com. Company Registration

Number: 6725089 / VAT number: 940 3555 34