

90 Broad Bridge Close | Kiveton Park | Sheffield | S26 6SN

£160,000

Bell & Co Estates are delighted to present this TWO Bedroom, SEMI-DETACHED Home in KIVETON PARK. If you are looking for a home to move straight into, then this is the HOME for you! Comprising of Entrance Hallway leading to the Lounge with under stairs STORAGE CUPBOARD, MODERN fitted Kitchen with breakfast area, rear door which gives access to the REAR GARDEN and GARAGE. Upstairs are TWO bedrooms one double, one single and a MODERN Family Bathroom, with shower over bath, wash basin and WC. To the outside is a driveway providing off road parking and grassed area, to the rear is an enclosed rear garden with decking area which is simply beautiful and not overlooked. Viewing is highly recommended to see the true beauty this lovely home has to offer. Close to all local amenities, transport links and schools this home is in a prime location. Call now to arrange a viewing!

- Two Bedroom Semi Detached
- Modern Throughout
- Lounge
- Modern Fitted Kitchen
- TWO BEDROOMS
- Family Bathroom
- Garage
- Driveway
- Enclosed Rear Garden



GROUND FLOOR
413 sq.ft. (38.4 sq.m.) approx.

1ST FLOOR
255 sq.ft. (23.7 sq.m.) approx.

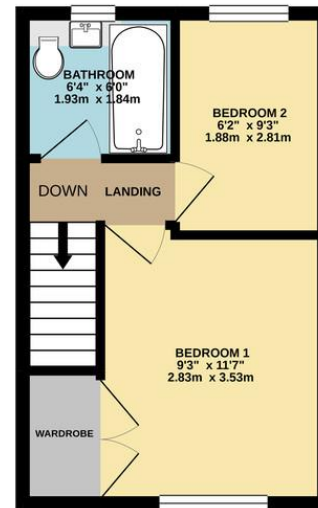
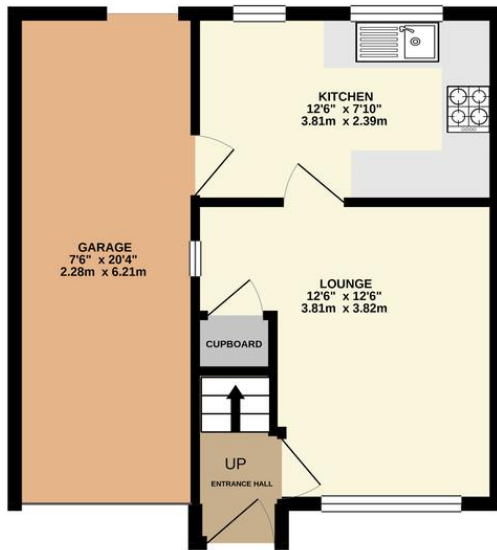

TOTAL FLOOR AREA: 668 sq.ft. (62.1 sq.m.) approx.

Whilst every attempt has been made to ensure the accuracy of the floorplan contained here, measurements of doors, windows, rooms and any other items are approximate and no responsibility is taken for any error, omission or mis-statement. This plan is for illustrative purposes only and should be used as such by any prospective purchaser. The services, systems and appliances shown have not been tested and no guarantee as to their operability or efficiency can be given.
Made with Metropix ©2021

Contact Details

79 Wales Road
Kiveton Park
Sheffield
South Yorkshire
S26 6RA

www.bellcoestates.com

03333 580590

90 Broad Bridge Close
Kiveton Park
SHEFFIELD
S26 6SN

Energy rating

C

Valid until
28 November 2033

Certificate number
2632-3932-4209-9537-6200

Property type Semi-detached house

Total floor area 49 square metres

Agents Note: Whilst every care has been taken to prepare these sales particulars, they are for guidance purposes only. All measurements are approximate and for general guidance purposes only and whilst every care has been taken to ensure their accuracy, they should not be relied upon and potential buyers are advised to recheck the measurements