



6 Fathers Gardens | Kiveton Park | Sheffield | S26 6QS

£180,000

Bell & Co Estates are pleased to present this TWO BEDROOM, extended SEMI-DETACHED HOME tucked away on a quiet cul-de-sac in Kiveton Park. This is a beautifully presented home and would be perfect for a first time buyer. In brief the property compromises of entrance Porch, LARGE OPEN PLAN Lounge with NEWLY fitted, modern Kitchen with island and INTEGRATED APPLIANCES, Snug and Dining area with bi-folding doors leading to the rear of the property. To the upstairs is the Master Bedroom complete with storage cupboard and further good sized single Bedroom. Modern Shower Room with wash basin and WC. To the front of the property is a stoned area with driveway providing off road parking, side gate providing access to the rear enclosed garden with LARGE patio area. Close to all local amenities, transport links and schools this home is in a prime location. Call now to arrange your viewing to fully appreciate what this home has to offer.

- Extended Two Bedroom Semi Detached
- Modern Throughout
- Kitchen with All Integrated Appliances and Island
- Open Plan Kitchen, Lounge and Diner
- Two Bedrooms
- Private Enclosed Garden



GROUND FLOOR
414 sq.ft. (38.4 sq.m.) approx.

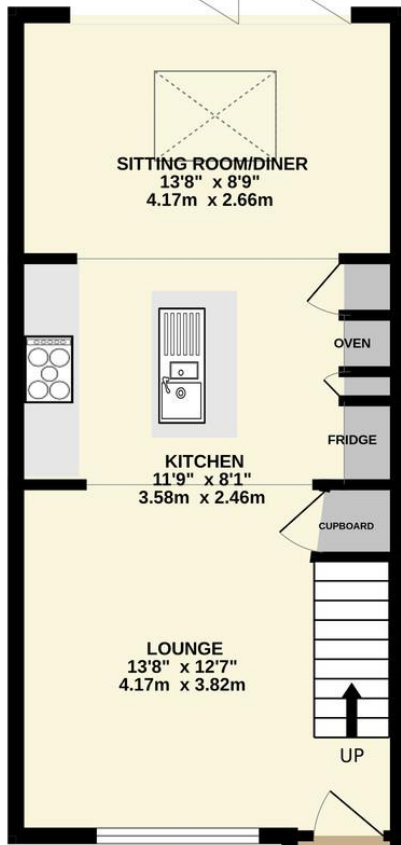

1ST FLOOR
282 sq.ft. (26.2 sq.m.) approx.

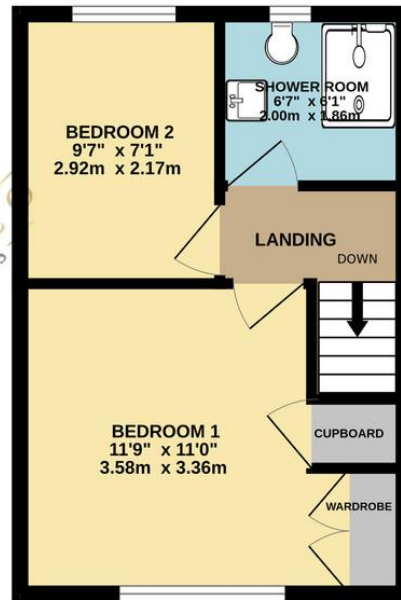

Contact Details

79 Wales Road
Kiveton Park
Sheffield
South Yorkshire
S26 6RA

www.bellcoestates.com

03333 580590

6 Fathers Gardens
Kiveton Park
SHEFFIELD
S26 6QS

Energy rating

C

Valid until
1 December 2033

Certificate number
9300-2519-2320-2807-6231

Property type Semi-detached house

Total floor area 63 square metres

Agents Note: Whilst every care has been taken to prepare these sales particulars, they are for guidance purposes only. All measurements are approximate and for general guidance purposes only and whilst every care has been taken to ensure their accuracy, they should not be relied upon and potential buyers are advised to recheck the measurements