



Manor Rise | Kiveton Park Station | Sheffield | S26 6AB

£600,000 to 650,000

Bell & Co Estates are honoured to present this stunning, FIVE BEDROOM Detached home in Kiveton Park, set on a private gated road with just four houses! Viewing is highly recommended to fully appreciate what this home has to offer. Briefly comprising of; to the Ground Floor; a stunning, personally designed, modern Kitchen with island, integrated appliances with granite worktops. spacious dining area, with bi-folding doors opening onto the patio area with a private enclosed garden creating the perfect entertaining area. To the first floor is the main entry to the property where you will find a large open Hallway with solid oak doors and bannisters, front facing office, large cloakroom and WC with wash basin, a large rear facing formal Lounge with balcony overlooking the garden. There is internal access into the garage through the hall with a separate Utility Room and store cupboard. To the second floor is the Master Bedroom with En-Suite, second Bedroom with En-suite, two further double Bedrooms and a good size single, currently used as a dressing room as well as the Family Bathroom with large Bath, fitted sink unit and WC. To the front of the property the driveway provides off road parking and gives access to the Garage, with side gate to the Rear Enclosed Garden.

- Simply Stunning Throughout!
- Five Bedroom Detached Home
- Set Over Three Floors
- Open Plan Kitchen/Diner
- Lounge with Balcony
- Master with Ensuite
- Private Gated Entrance
- Off Road Parking
- Garage



LOWER GROUND FLOOR
538 sq ft (50.0 sqm) approx.

GROUND FLOOR
963 sq ft (89.5 sqm) approx.

FIRST FLOOR
965 sq ft (89.7 sqm) approx.

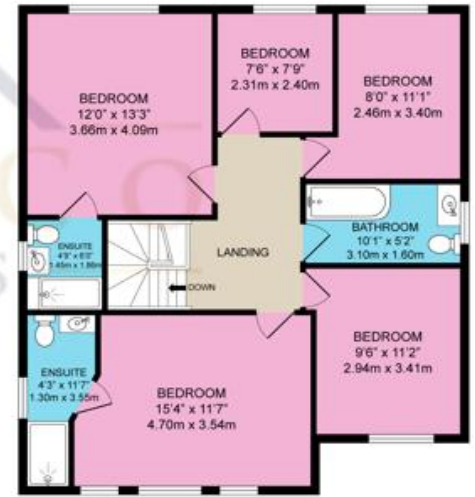

TOTAL FLOOR AREA: 2466 sq ft (229.2 sqm) approx.

Contact Details

79 Wales Road
Kiveton Park
Sheffield
South Yorkshire
S26 6RA

www.bellcoestates.com

03333 580590

3 Manor Rise
Kiveton Park
ROTHERHAM
S26 6AB

Energy rating

B

Valid until
5 June 2032

Certificate number
0010-3376-8569-2002-2345

Property type Detached house

Total floor area 188 square metres

Agents Note: Whilst every care has been taken to prepare these sales particulars, they are for guidance purposes only. All measurements are approximate and for general guidance purposes only and whilst every care has been taken to ensure their accuracy, they should not be relied upon and potential buyers are advised to recheck the measurements