



118 Stoney Bank Drive | Kiveton Park | S26 6SB

Guide Price £220,000 to £230,000

Bell & Co Estates are delighted to present to the market this stunning, extended THREE Bedroom Semi-Detached home on this popular estate in Kiveton Park offered with NO VENDOR CHAIN. In brief this modern home comprises of; Entrance Hallway with Downstairs WC, front facing spacious Lounge with feature fireplace, Modern grey gloss Kitchen with plenty of cupboard space, separate Dining Room and rear extension room which could be a multi-functional room such as a playroom or office! To the upstairs is the Master Bedroom complete with modern En-Suite Shower Room, TWO FURTHER BEDROOMS, one with fitted wardrobes and the family Bathroom complete with bath, wash basin and WC. To the outside is a driveway providing off road parking, and to the rear is an enclosed garden with patio and decking. This home has been fully modernised throughout, so if you're looking for a home to move straight into then this is the one for you! Close to local amenities, schools and transport links this home is in a prime location. Call now to arrange a viewing!

- Extended THREE BEDROOM Semi-Detached Home
- Modern Throughout
- Cosy Lounge
- Separate Dining Room
- Master with En-Suite
- Enclosed Rear Garden
- Off Road Parking
- No Chain



GROUND FLOOR
685 sq.ft. (63.6 sq.m.) approx.



1ST FLOOR
450 sq.ft. (41.8 sq.m.) approx.

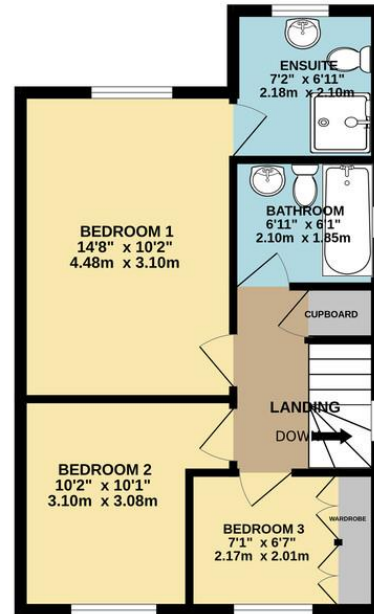

Contact Details

79 Wales Road
 Kiveton Park
 Sheffield
 South Yorkshire
 S26 6RA

www.bellcoestates.com

03333 580590

118 STONEY BANK DRIVE
 KIVETON PARK
 SHEFFIELD
 S26 6SB

Energy rating

D

Valid until
30 June 2031

Certificate number
7208-2000-9206-7459-0200

Property type Semi-detached house

Total floor area 102 square metres

Agents Note: Whilst every care has been taken to prepare these sales particulars, they are for guidance purposes only. All measurements are approximate are for general guidance purposes only and whilst every care has been taken to ensure their accuracy, they should not be relied upon and potential buyers are advised to recheck the measurements