



25 Ashby Drive | Kiveton Park | Sheffield | S26 5PU

£200,000

Bell & Co Estates are delighted to present this THREE Bedroom end Town House on this popular estate in KIVETON PARK, beautifully presented throughout this would make a great first home. In brief the property comprises of; Entrance Hallway with Downstairs WC, Modern Dining Kitchen with white gloss units and integrated appliances with under stairs storage cupboard, large Lounge with patio doors overlooking the SOUTH FACING GARDEN. To the upstairs is a Modern Family Bathroom, airing cupboard and Three GOOD-SIZE Bedrooms, two doubles and a single, Master complete with ENSUITE Shower Room. To the front of the property the garden is mainly laid to lawn with OFF ROAD PARKING to the side for multiple vehicles, this gives access through a gate to the ENCLOSED rear Garden which is mainly laid to lawn with patio area. Looking for a home to move straight into then this is the one for you! Close to local amenities, schools and transport links this home is in a prime location! Call us now to arrange your viewing.

- Three Bedroom Semi Detached
- Modern Throughout
- Modern fitted Kitchen
- Master with Ensuite
- Family Bathroom
- Two Double Bedrooms
- Off Road Parking
- South Facing Enclosed Garden

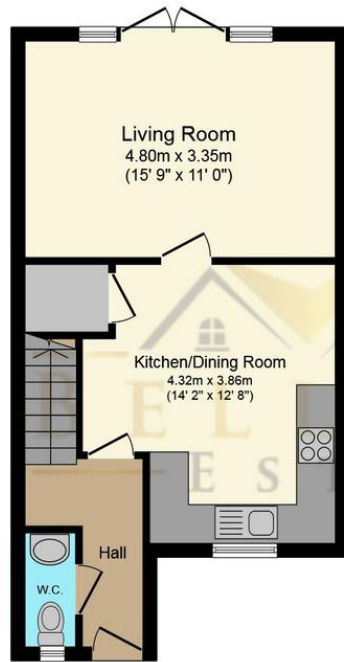

Ground Floor

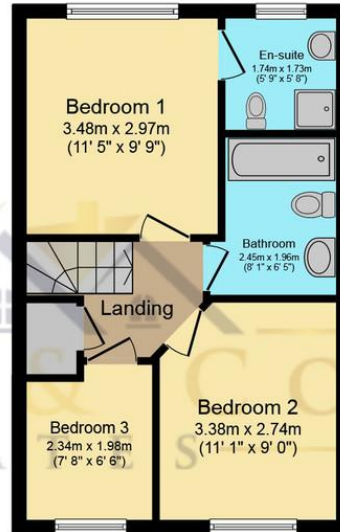

First Floor

Total floor area 77.5 m² (834 sq.ft.) approx

This plan is for illustration purposes only and may not be representative of the property. Plan not to scale. Powered by PropertyBox

Contact Details

79 Wales Road
Kiveton Park
Sheffield
South Yorkshire
S26 6RA

www.bellcoestates.com

03333 580590

25, Ashby Drive
Kiveton Park
SHEFFIELD
S26 5PU

Energy rating

C

Valid until
24 July 2027

Certificate number
8413-7833-5290-0290-1996

Property type Semi-detached house

Total floor area 81 square metres

Agents Note: Whilst every care has been taken to prepare these sales particulars, they are for guidance purposes only. All measurements are approximate and for general guidance purposes only and whilst every care has been taken to ensure their accuracy, they should not be relied upon and potential buyers are advised to recheck the measurements