



Moor View, Marldon - TQ3 1PL

Paignton

£325,000

ABSOLUTE



Moor View

Marldon, Paignton

The property boasts a spacious and well-maintained garden, perfect for outdoor entertaining and enjoys the picturesque views across Dartmoor. The rear garden is accessed via a private road on Moor View and includes a brick built shed with power, ideal for storing gardening equipment. Additionally, there is a sizeable greenhouse, allowing for the cultivation of various plants and vegetables. The garden is surrounded by beautiful bush borders and is mainly laid to patio, providing a low-maintenance outdoor space.

This property presents a unique opportunity to own a four-bedroom semi-detached house in a sought-after village location, complete with private gardens showcasing a wealth of outdoor space. The expansive garden, driveway parking, and the potential for an upstairs annexe make this property an ideal choice for growing families or those with a desire for versatile living arrangements.



GARDEN

Garden and parking to the front and the rear of the property. The rear access comes off a private road on Moor View and the garden features a brick built shed with power and a large greenhouse, surrounded by bush borders and mainly laid to patio. The front of the property also has a driveway with a gated entrance. This garden features a lawned area and shrub borders and offers plenty of privacy from the neighbouring properties.

ON DRIVE

4 Parking Spaces

Driveway parking to the front and the rear of the property.



Moor View

Marldon, Paignton

Marldon is a picturesque village in the South Hams with easy access to nearby towns such as Paignton, Torquay, Newton Abbot and Totnes.

Council Tax band: C

Tenure: Freehold

EPC Energy Efficiency Rating: D

- Four bedroom semi-detached home
- Driveway parking at the front and rear of the property
- Excellent views across Dartmoor
- Conservatory
- Lots of storage space including large eaves on the first floor
- Village location
- Private gardens with outside storage and a greenhouse
- Potential for upstairs annexe





ABSOLUTE





Ground Floor

Approx. 85.0 sq. metres (915.3 sq. feet)

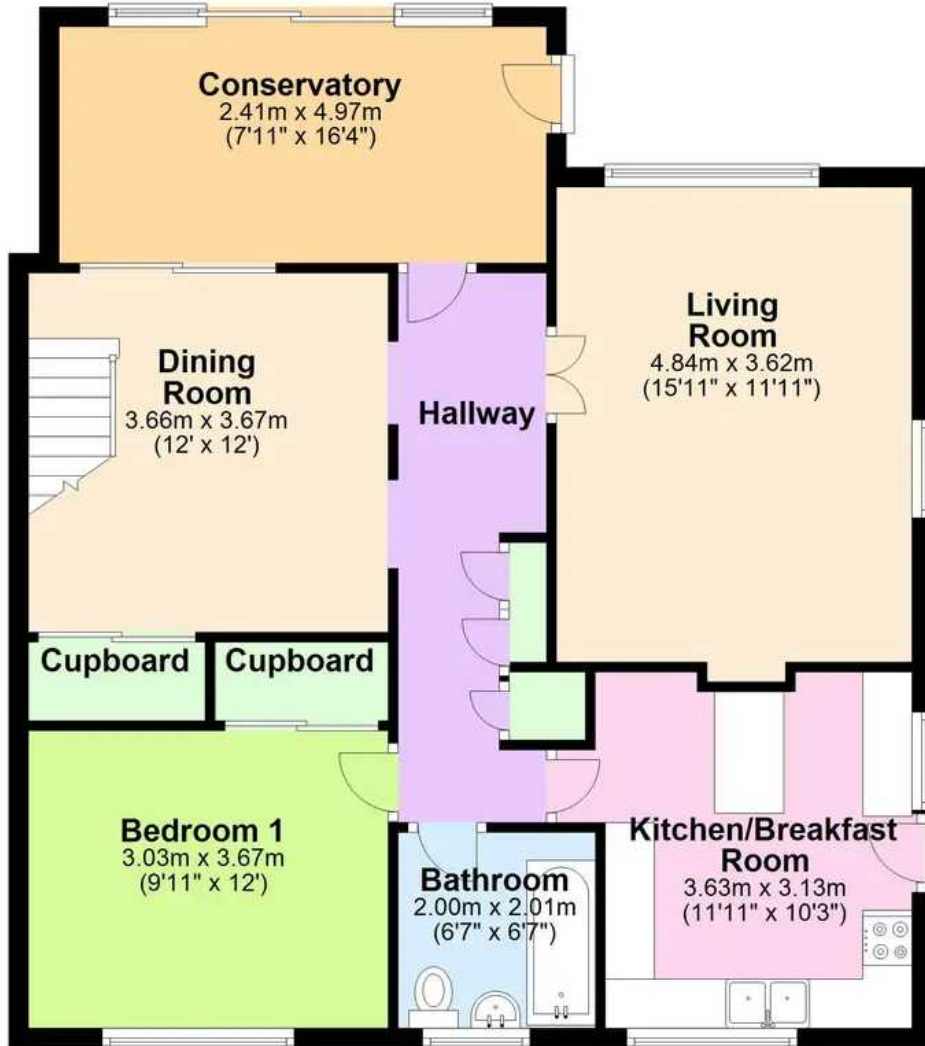

First Floor

Approx. 64.1 sq. metres (689.5 sq. feet)

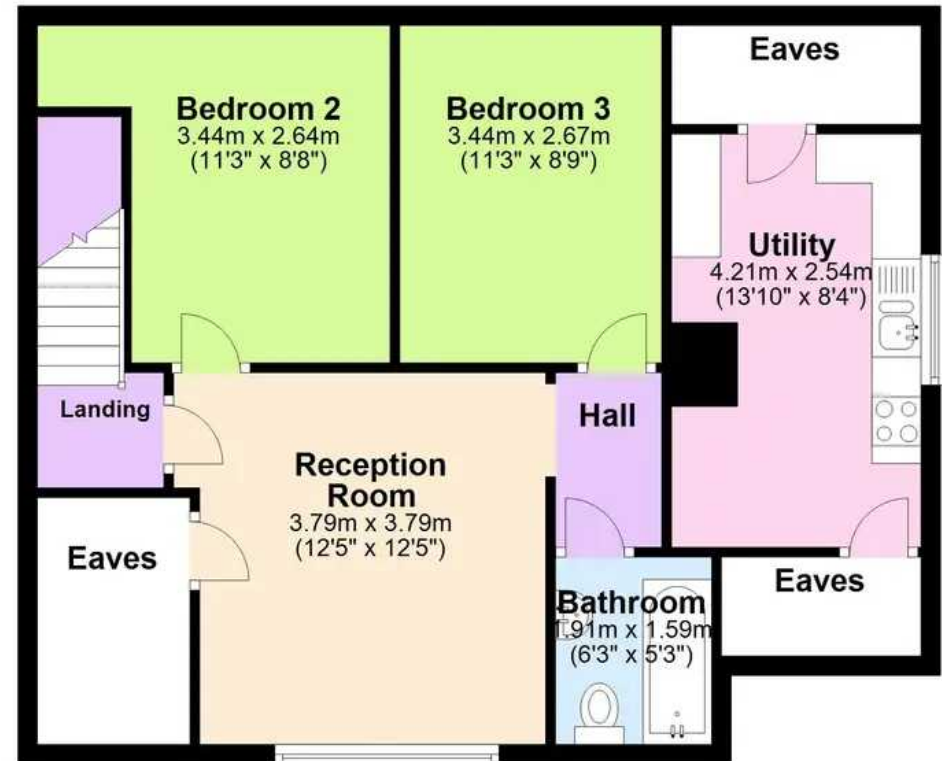

Total area: approx. 149.1 sq. metres (1604.8 sq. feet)



Absolute Sales & Lettings

Absolute Sales & Lettings, 27 Hyde Road - TQ4 5BP

01803 890110

paignton@movewithabsolute.co.uk

<http://www.movewithabsolute.co.uk>

