

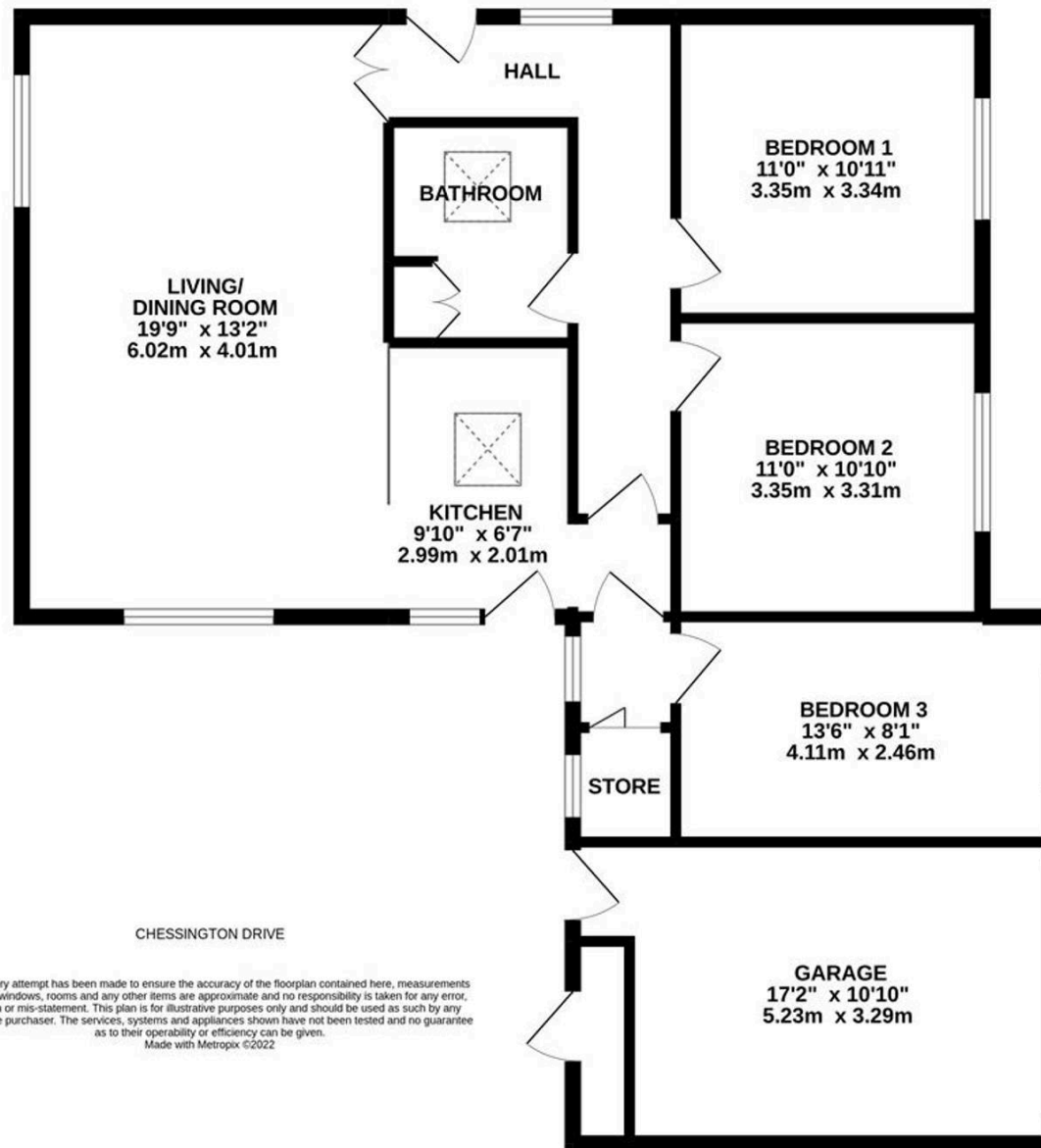

Chessington Drive, Flockton

Wakefield, WF4 4TJ

£395,000



Whilst every attempt has been made to ensure the accuracy of the floorplan contained here, measurements of doors, windows, rooms and any other items are approximate and no responsibility is taken for any error, omission or mis-statement. This plan is for illustrative purposes only and should be used as such by any prospective purchaser. The services, systems and appliances shown have not been tested and no guarantee as to their operability or efficiency can be given.
Made with Metropix ©2022



3 Chessington Drive

Flockton, Wakefield, WF4 4TJ

A RARE OPPORTUNITY TO ACQUIRE A DETACHED, TRUE BUNGALOW. OCCUPYING FABULOUS GROUNDS WITH BEAUTIFUL GARDENS, WHICH HAVE THE POTENTIAL OF A BUILDING PLOT TO THE SIDE (SUBJECT TO NECESSARY CONSENTS). SITUATED IN A QUIET POSITION, SET BACK FROM BARNSELY ROAD, IN A PRIVATE CUL-DE-SAC SETTING AND LOCATED IN FLOCKTON. IN A GREAT POSITION FOR ACCESS TO MAJOR COMMUTER LINKS, A SHORT DISTANCE FROM AMENITIES AND WITH FANTASTIC VIEWS ACROSS BARNSELY ROAD OF ROLLING COUNTRYSIDE.

The property in brief comprises of kitchen, open-plan living/dining room, b Bedroom one, Bedroom two, Bedroom three and the House Bathroom. Externally there is a driveway to the front, which provides off street parking and leads to the attached Garage. At the rear of the garage is a coal house. The mature gardens are well stocked with planted flower and shrub beds, lawn areas and patio. Viewings are a must in order to truly appreciate the beautiful bungalow and gardens on offer.

EPC Rating D.

Council Tax Code C.

Tenure Freehold.



GROUND FLOOR

INNER HALLWAY

The Inner Hallway provides access to two double bedrooms and the House Bathroom. There is a timber and glazed external door to the side elevation and there is a double glazed window to the side elevation and there is a wall light point.

OPEN PLAN LIVING, DINING AND KITCHEN AREA

Enter into the property through a double glazed PVC door with obscure glazed inserts, into the the fabulous open plan living/dining and kitchen room. The Kitchen area features a range of fitted wall and base units, with complementary rolled edge work surfaces over. These incorporate a single bowl composite sink and drainer unit with chrome mixer tap. The Kitchen is equipped with fitted appliances including a four ring ceramic hob with integrated cooker hood over and a built in electric fan assisted oven. There is plumbing for a washing machine. There is under unit lighting and glazed display cabinets with internal lighting. The Kitchen area features lino flooring and there are doors providing access to the inner hallway, vestibule and the Kitchen area seamlessly leads into the Living/Dining area.

LIVING DINING AREA

Dimensions: 6.71m x 7.14m (22'0" x 23'5"). This space boasts a wealth of natural light with the windows providing a pleasant outlooks across the property's well manicured and well stocked gardens. There are two ceiling light points and two radiators and the focal point of the room is the built in recessed, stove effect open fire, with tiled inset hearth and surround and there are multi-panelled timber and glazed doors with obscure glass, these lead into the inner Hallway.





BEDROOM ONE

Dimensions: 3.30m x 3.30m (10'10" x 10'10"). Bedroom one is a double bedroom with ample space for freestanding furniture. There is a double glazed window to the front elevation, which has views across the front garden and with far reaching views in the distance. There is a central ceiling light point and radiator.

BEDROOM TWO

Dimensions: 3.35m x 3.35m (11' x 11'). Bedroom Two again can accommodate a double bed with ample space for freestanding furniture. There is a ceiling light point, a radiator and a double glazed window to the front elevation. This again has pleasant views across the front garden and with far reaching views beyond.

HOUSE BATHROOM

Dimensions: 2.29m x 1.83m (7'6" x 6'). The House Bathroom features a white three piece suite which comprises of a panelled bath with an electric Triton shower over. There is a pedestal wash hand basin and a low level WC. There are tiled walls and tiled flooring. A double glazed window is to the side elevation. There is a radiator and linen cupboard which houses the property's combination boiler. Also there is a loft hatch providing access to a useful storage area.



VESTIBULE

The vestibule is accessed from the Kitchen area and has a door leading to a double bedroom and a concertinaed door providing access to a Pantry. There is a double glazed window with obscure glass to the rear elevation. There is a ceiling light point and decorative coving.

BEDROOM THREE

Dimensions: 2.44m x 4.19m (8' x 13'9"). Bedroom Three is a light and airy double bedroom with ample space for free standing furniture. The room is decorated with a neutral finish and features a double glazed window to the front elevation. Again, this has picturesque views across the Green and of the views beyond.

PANTRY

Dimensions: 1.42m x 0.74m (4'8" x 2'5"). The Pantry is a useful area, with a double glazed window to the rear elevation and fitted shelving. Whilst this area is useful for additional storage it could be utilised as potential ensuite facilities for Bedroom Three, subject to necessary planning and constraints.

GARAGE

Dimensions: 5.28m max 3.23m (17'4" max 10'7"). The attached garage features an electric roller shutter door. There is lighting and power and fitted shelving. The garage also has a separately accessed coal store, which has a ceiling light point. The measurements of the



Garden

As the photography suggests the gardens/land adjacent to the property have the potential for a building plot, subject to relevant planning permissions and constraints. However, this land currently has a beautiful flat lawned garden with central tree, and with mature flower, shrub and bush borders. The garden to the side extends further, with a hard standing for a greenhouse and further hardstanding for a summer house. The gardens truly are magnificent, with part fenced and part hedged boundaries. There is also a sheltered patio area at the rear of the property, which is an ideal space for al-fresco dining and bar-b-qing. There is an external tap, and an external security light and external portico light.

Externally the property occupies a fabulous double plot, which is well maintained and features well stocked mature flower, tree and shrub borders. Immediately to the front of the property, there is a tarmac driveway with off street parking for two vehicles with one of the driveways leading to the attached Garage. The garden to the front is laid predominantly to lawn, with flower and shrub borders and there is a flagged pathway, which leads across the front of the property and down the side.





VIEWING

For an appointment to view, please contact the Kirkburton Office on 01484 603399.

BOUNDARY OWNERSHIP

The boundary ownerships and tenure of the property have not been checked on the title deeds for any discrepancies or rights of way if any (This is a standard statement on all our brochures due to the Property Misdescription's Act)

COPYRIGHT

Unauthorised reproduction prohibited.

FREE VALUATIONS

If you are thinking of a move then take advantage of our FREE valuation service, telephone our nearest office for a prompt and efficient service.

CONSUMER PROTECTION FROM UNFAIR TRADING REGULATIONS 2008

Simon Blyth for themselves and for the vendors or lessors of this property, whose agent they are, have made every effort to ensure the details given have been prepared in accordance with the above act and to the best of our knowledge give a fair and reasonable representation of the property. Please note:

1. There is a six inch measurement tolerance or metric equivalent and the measurements given should not be entirely relied upon and purchasers must make their own measurements if ordering carpets, curtains or other equipment.
2. None of the main services, i.e. gas, water, electricity, drainage or central heating system (if any) have been tested in any way whatsoever. This also includes appliances which are to be left in situ by the vendors.

PURCHASERS MUST SATISFY THEMSELVES AS TO THE CONDITION AND EFFECTIVENESS OF ANY SUCH APPLIANCES OR SERVICES.

FLOOR PLANS NOT TO SCALE – FOR IDENTIFICATION PURPOSES ONLY.

MAILING LIST

Keep up to date with all our new properties. Let us know your price range, the area and type of home you require by registering on our mailing list.

MORTGAGE ADVICE

Simon Blyth Estate Agents understand that getting appropriate mortgage advice is a crucial part of the home buying process. Finding a suitable mortgage has always been something of a daunting experience which is why we would like to introduce you to our independent mortgage advisors. They provide tailored mortgage solutions through a wealth of experience in the mortgage and property market and offer access to the full unrestricted range of products available.

Our advisors are dedicated to providing ongoing guidance and advice throughout the entire house purchase process keeping you, your estate agent and solicitor involved with continual updates on the progress. Once in your new home they will be available for ongoing support to build a long term relationship for your future mortgage planning. Your home may be repossessed if you do not keep up repayments on your mortgage.

For friendly expert advice on your mortgage requirements, or to discuss the potential of making your ideas a reality then please call in or phone for a chat.

OFFICE OPENING TIMES

7 DAYS A WEEK

Monday to Friday – 8:45am to 5:30pm

Saturday – 9am to 4:30pm

Sunday – 11am to 4pm



Simon Blyth Estate Agents

81e North Road, Kirkburton - HD8 0RL

01484 603399

kirkburton@simonblyth.co.uk

www.simonblyth.co.uk/

Wakefield	Huddersfield	Holmfirth	Kirkburton	Penistone	Sheffield	Barnsley	Pontefract	Leeds	Halifax
01924 361631	01484 651878	01484 689689	01484 603399	01226 762400	01143 216 590	01226 731730	01977 800259	0113 4689331	01422 417000